



4TH STREET RECONSTRUCTION



About the Project

The City of Duluth is planning to reconstruct 4th Street between Mesaba Avenue and 6th Avenue East.

Public input is key to a design that addresses existing and future community needs. The project team will review public input received through the open house, survey, and online comment map and use it to help develop a preliminary design concept. The design concept will be shared with the community at a future open house as the project moves forward.

The project will include the following:

- Complete street reconstruction
- New sidewalks and crossings
- Underground utility reconstruction
- Street lighting upgrades

Construction is currently scheduled to begin in 2028 and be completed in 2029. This project will be funded through a combination of federal funds, Minnesota State Aid funds, and City of Duluth Engineering Utility funds.



Timeline

- **Winter 2025 to Summer 2026:** Preliminary Design and Planning
- **January 15, 2026:** Open House #1
- **April 16, 2026:** Open House #2
- **Fall 2026:** Open House #3
- **Fall 2026:** Final Design Begins
- **Winter/Spring 2027:** Open House #4
- **Winter 2027:** Construction Bidding
- **Spring 2028 to Fall 2029:** Construction

Project Area

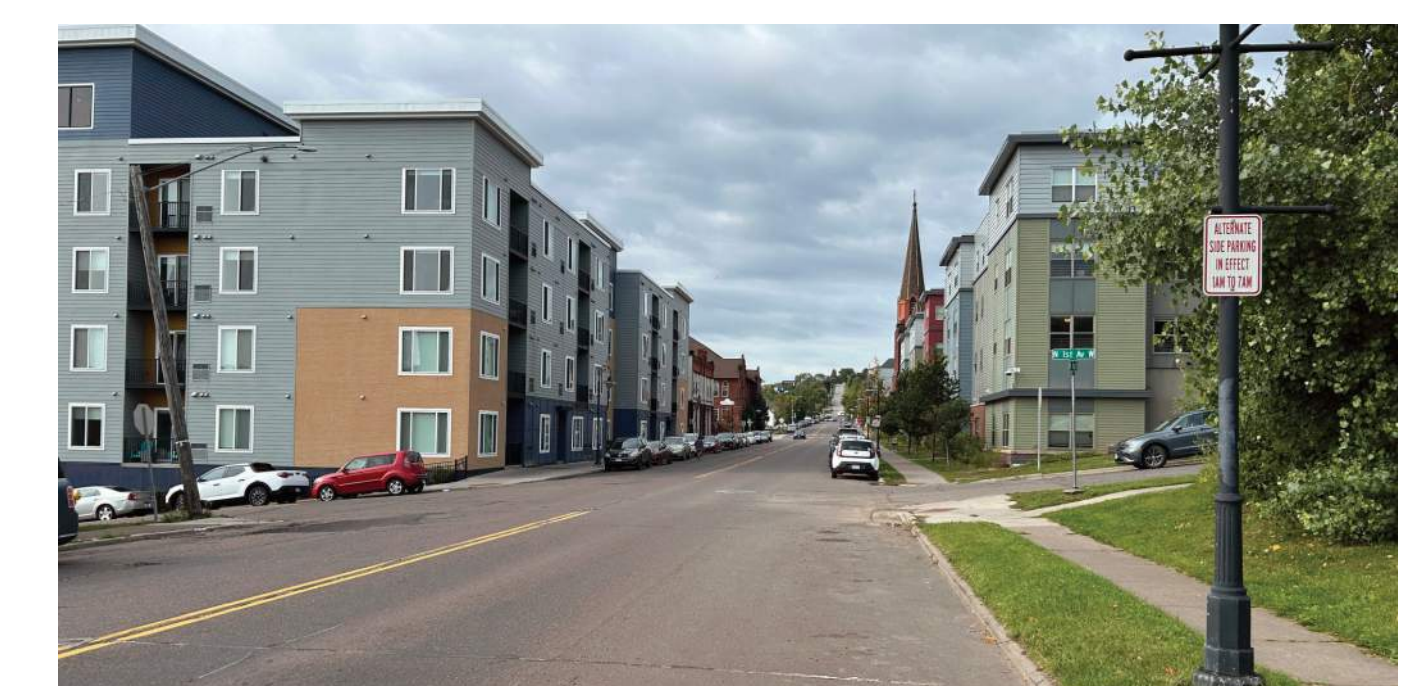

Stay Engaged

For more information and provide your input, scan the QR code or visit the project website:

duluthmn.gov/engineering/projects/4th-street-reconstruction



Design Concept 1

Aerial View

Plan View

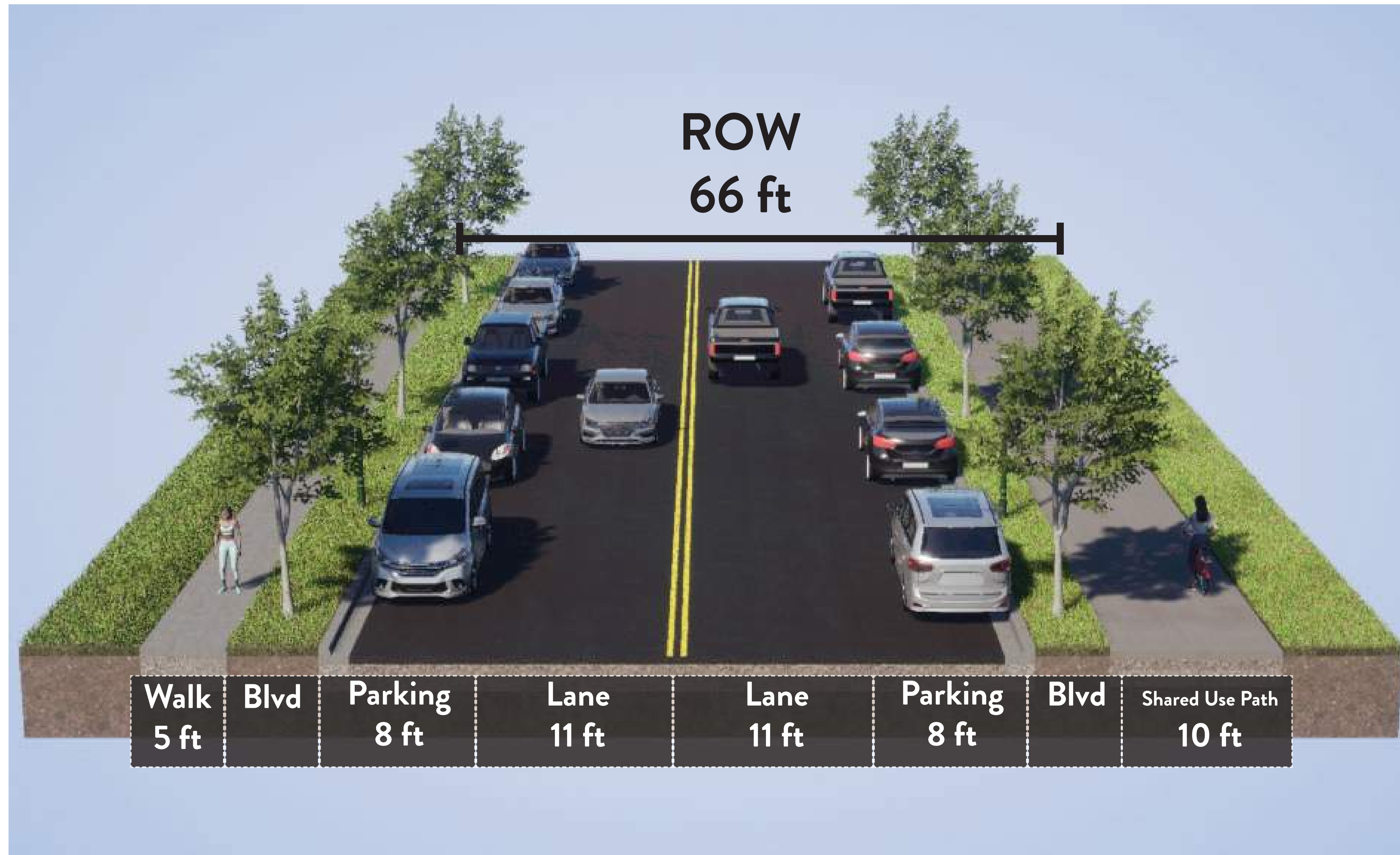

Design Features

- 10' Shared Use Path
- 5' Sidewalk
- Trees in Boulevards
- New Pedestrian Lighting
- 2-Sided Parking
- 11' Drive Lanes

PLACE YOUR COMMENTS HERE:

Design Concept 2 (Lake to 6th)

Aerial View

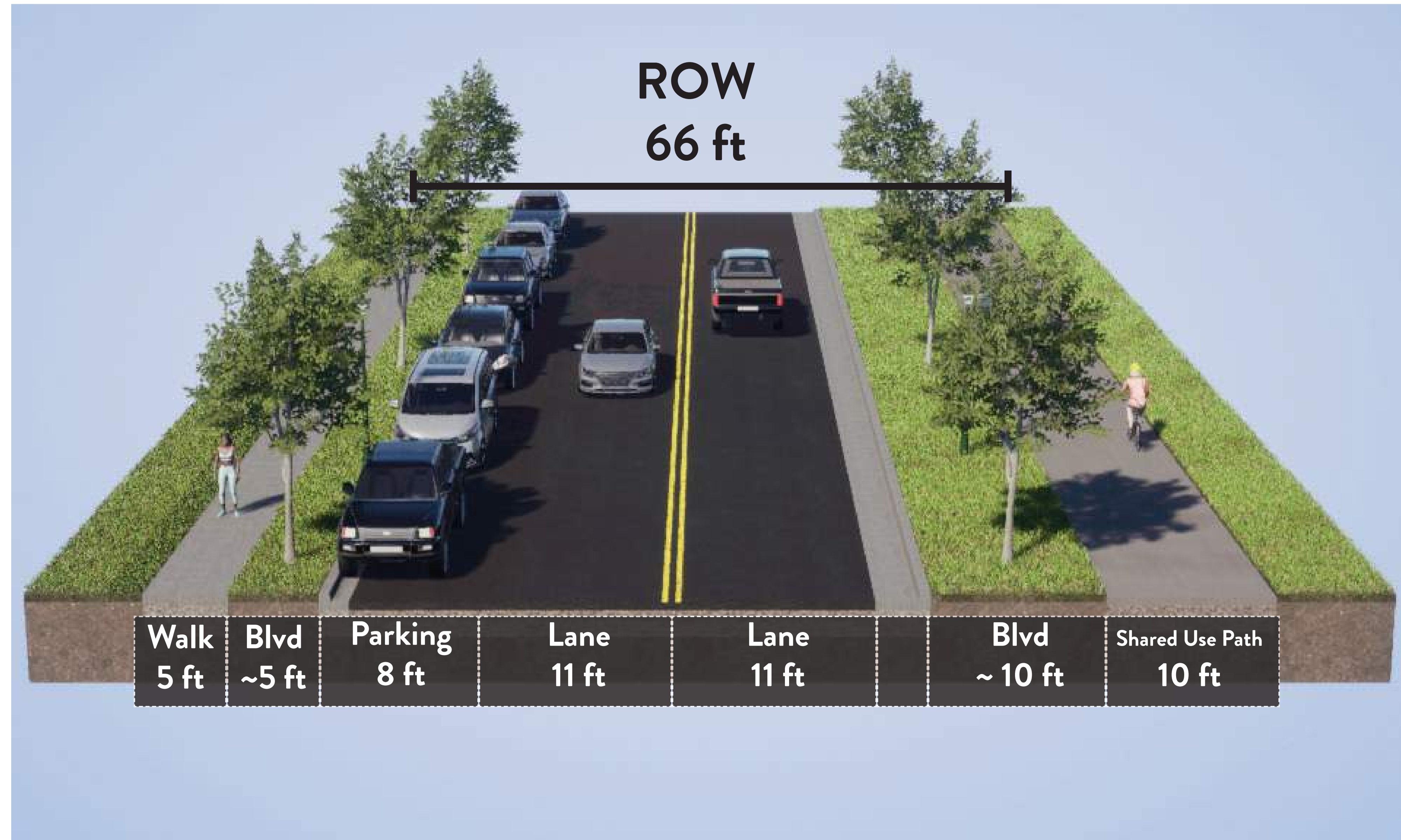

Plan View

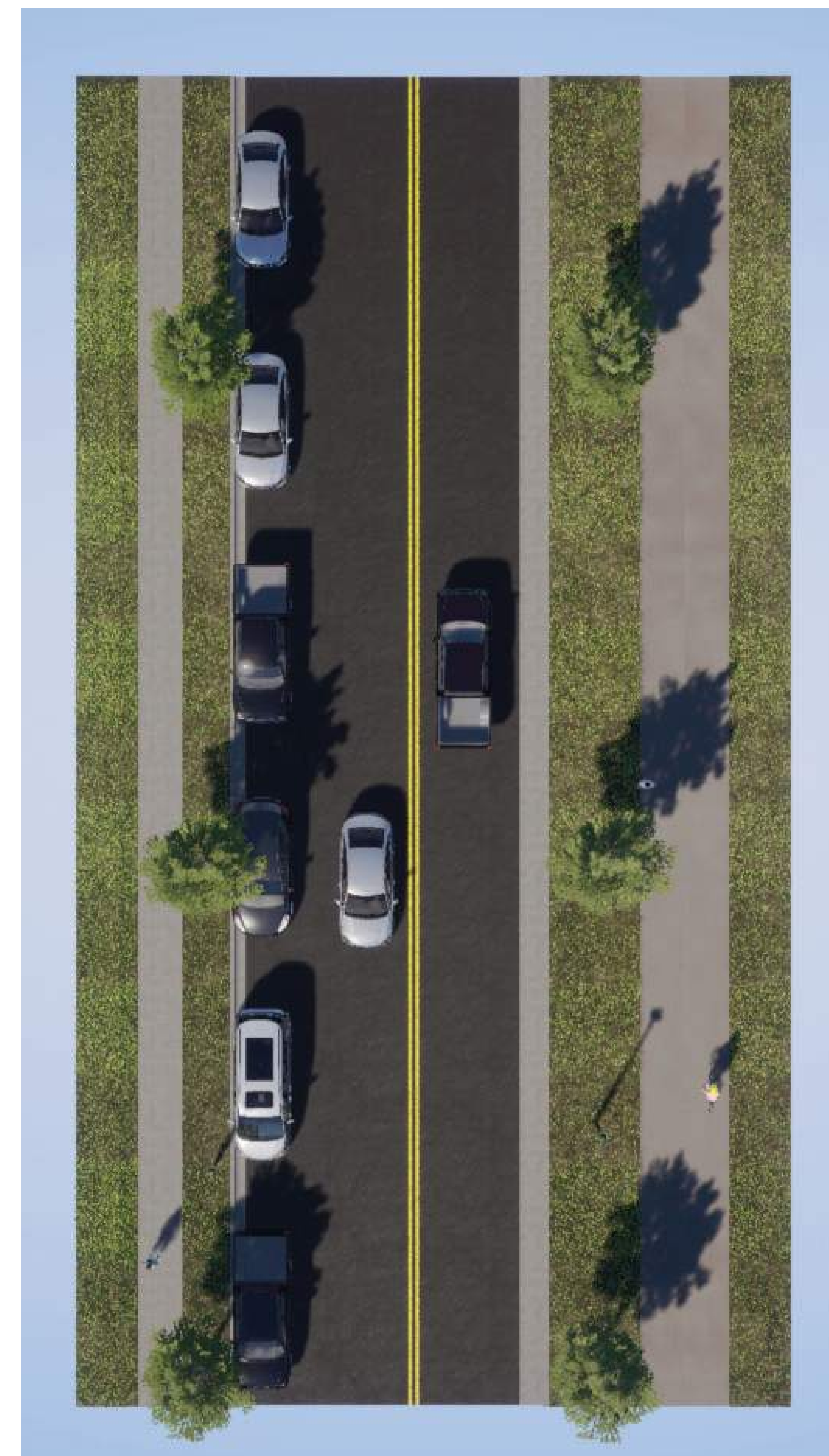

Design Features

- 10' Shared Use Path
- 5' Sidewalk
- Trees in Boulevards
- New Pedestrian Lighting
- 1-Sided Parking
- 11' Drive Lanes

PLACE YOUR COMMENTS HERE:

Design Concept 3 (Lake to 6th)

Aerial View

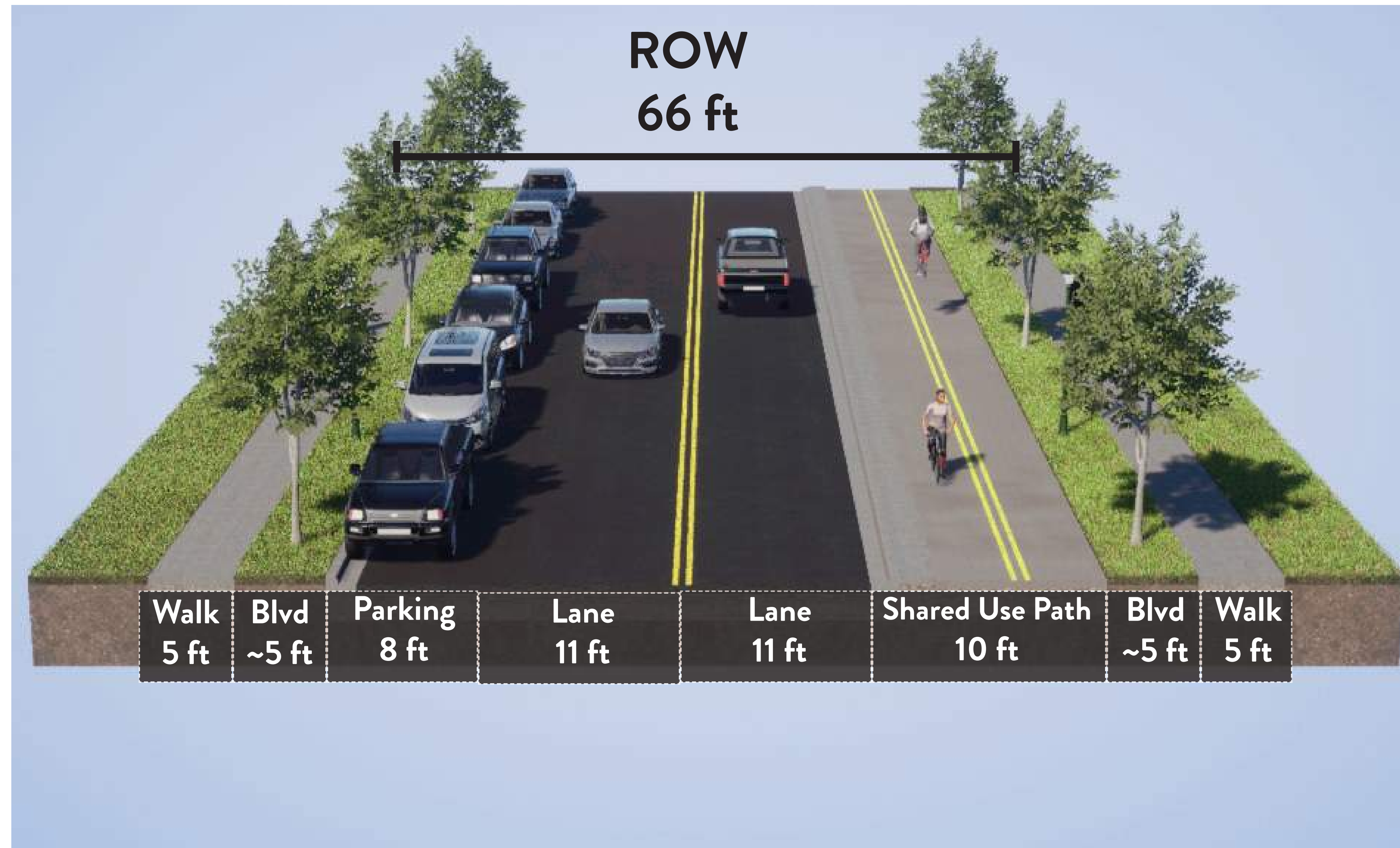

Plan View



Design Features

- 10' Shared Use Path
- Two 5' Sidewalks
- Trees in Boulevards
- New Pedestrian Lighting
- 1-Sided Parking
- 11' Drive Lanes

PLACE YOUR COMMENTS HERE:

Traffic Analysis

Mesaba Ave & 4th St Intersection

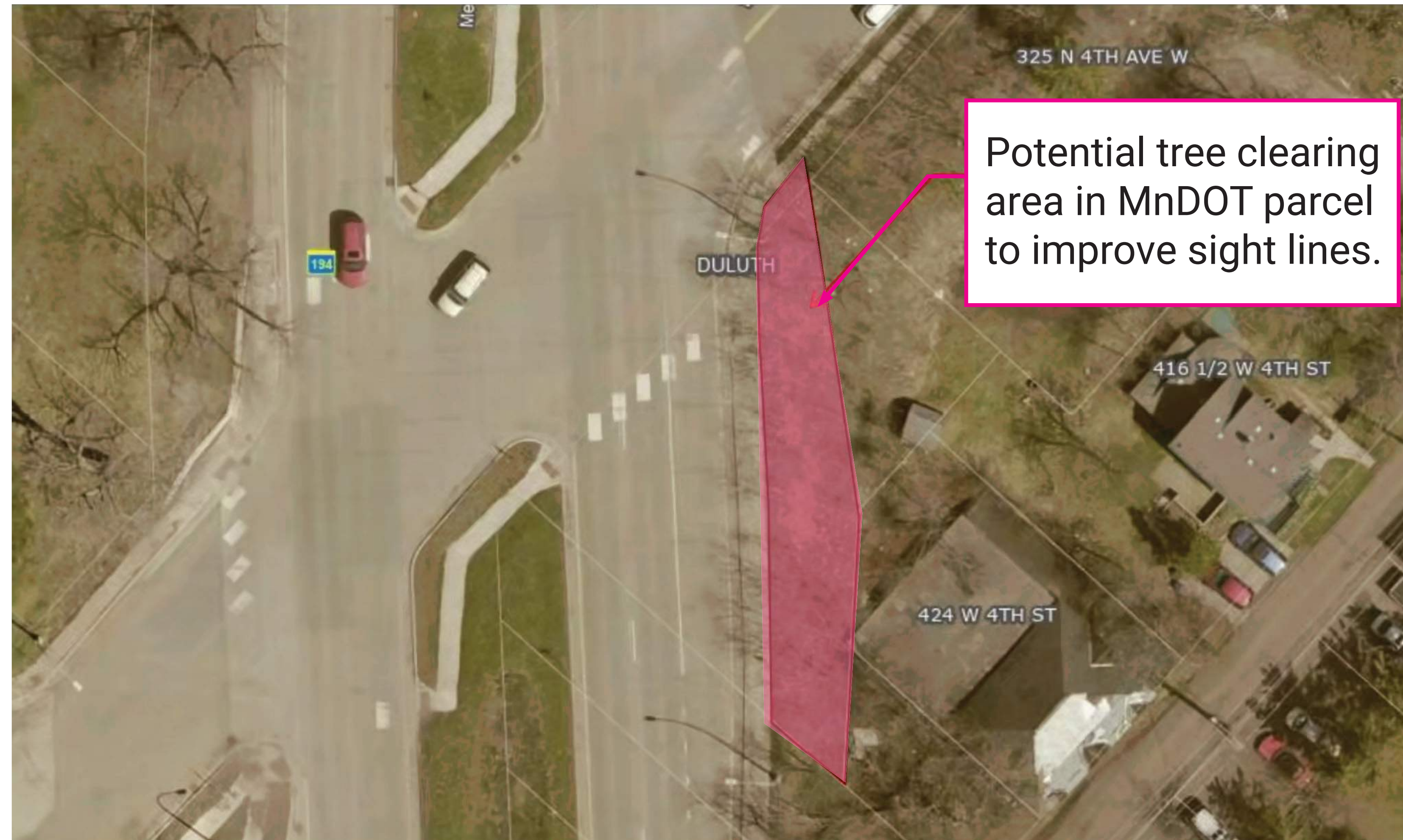

4th St at 4th Ave W Intersection - Potential Improvements

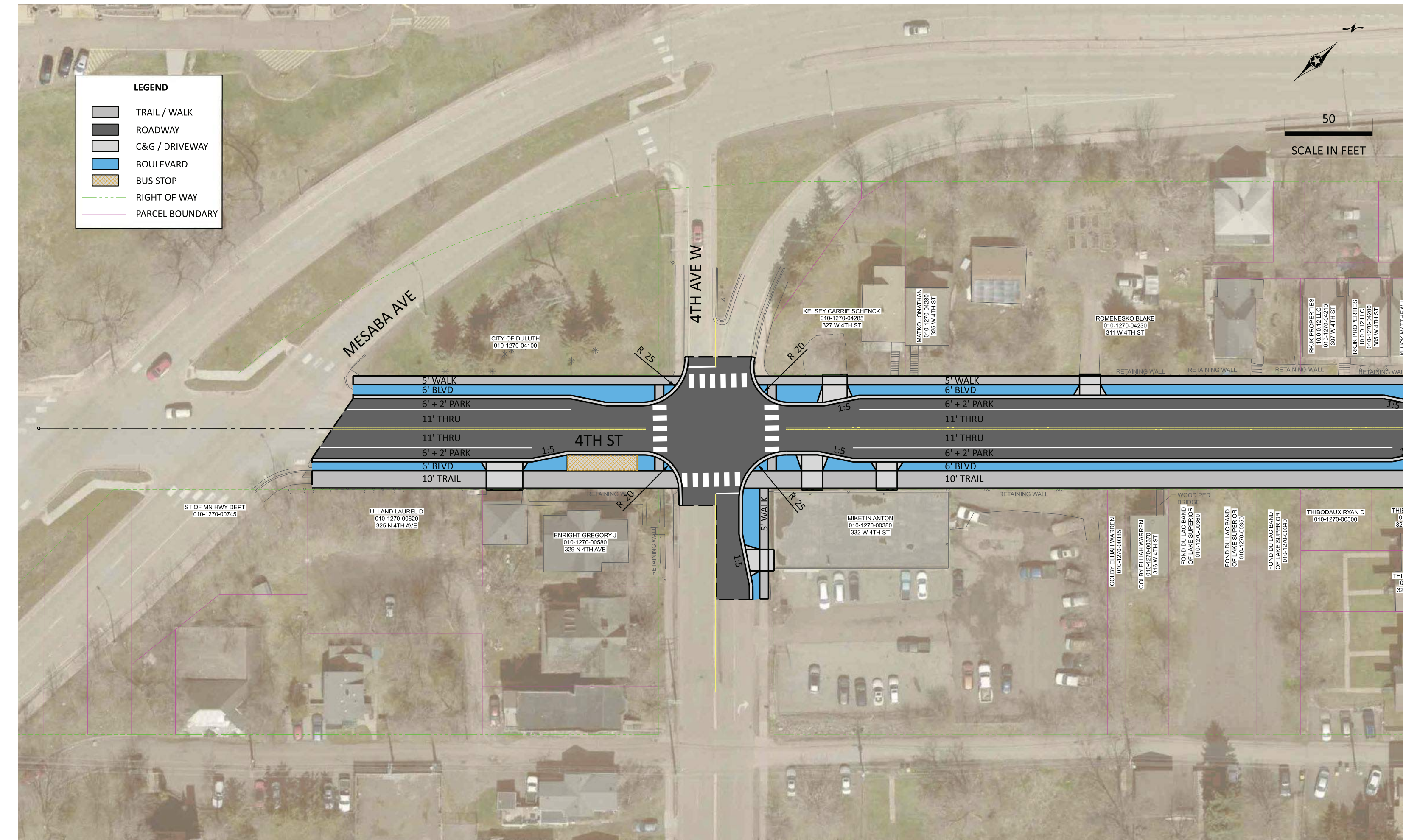

Preliminary Crash Results

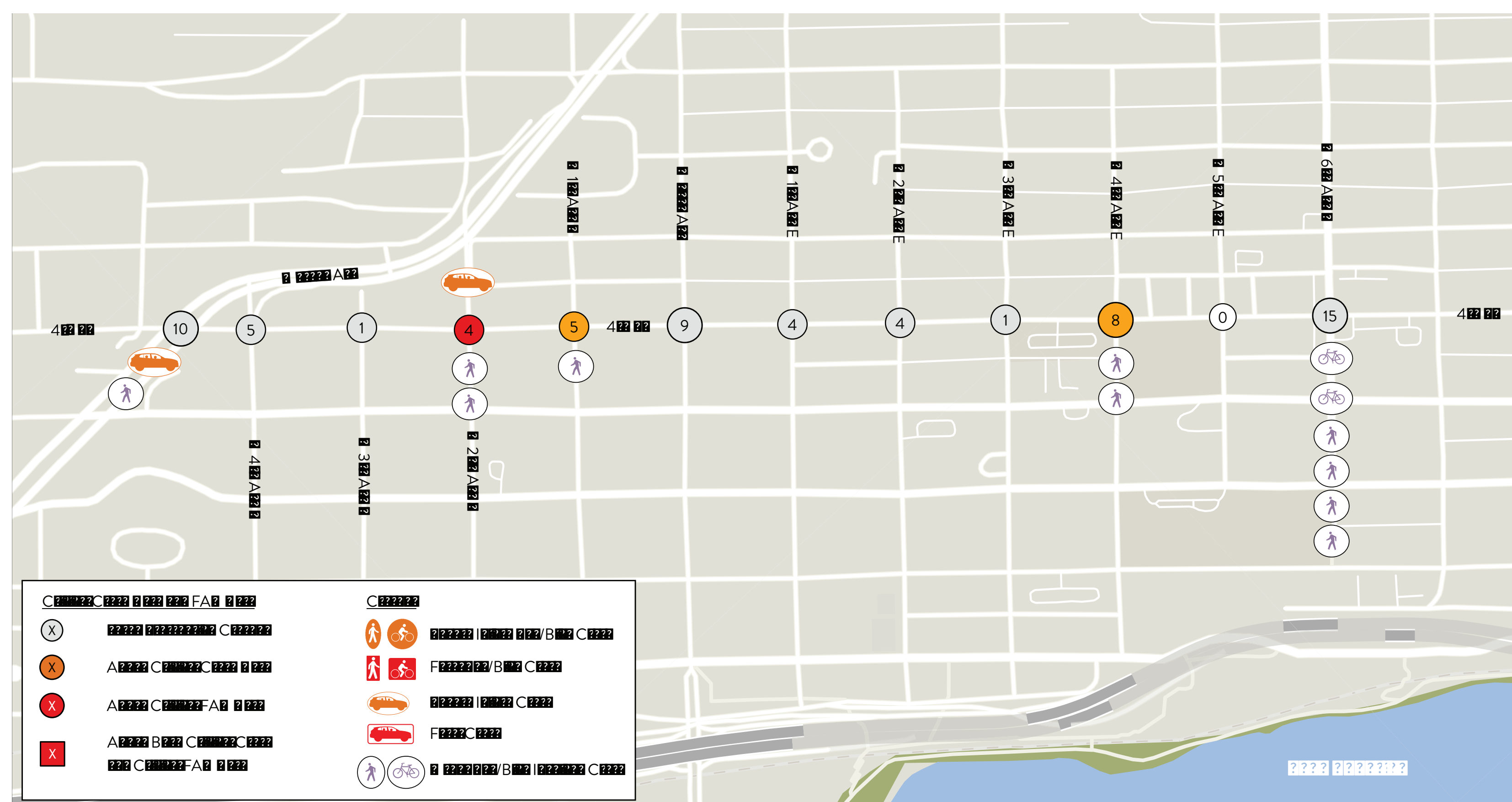

Average Annual Daily Traffic (AADT) History

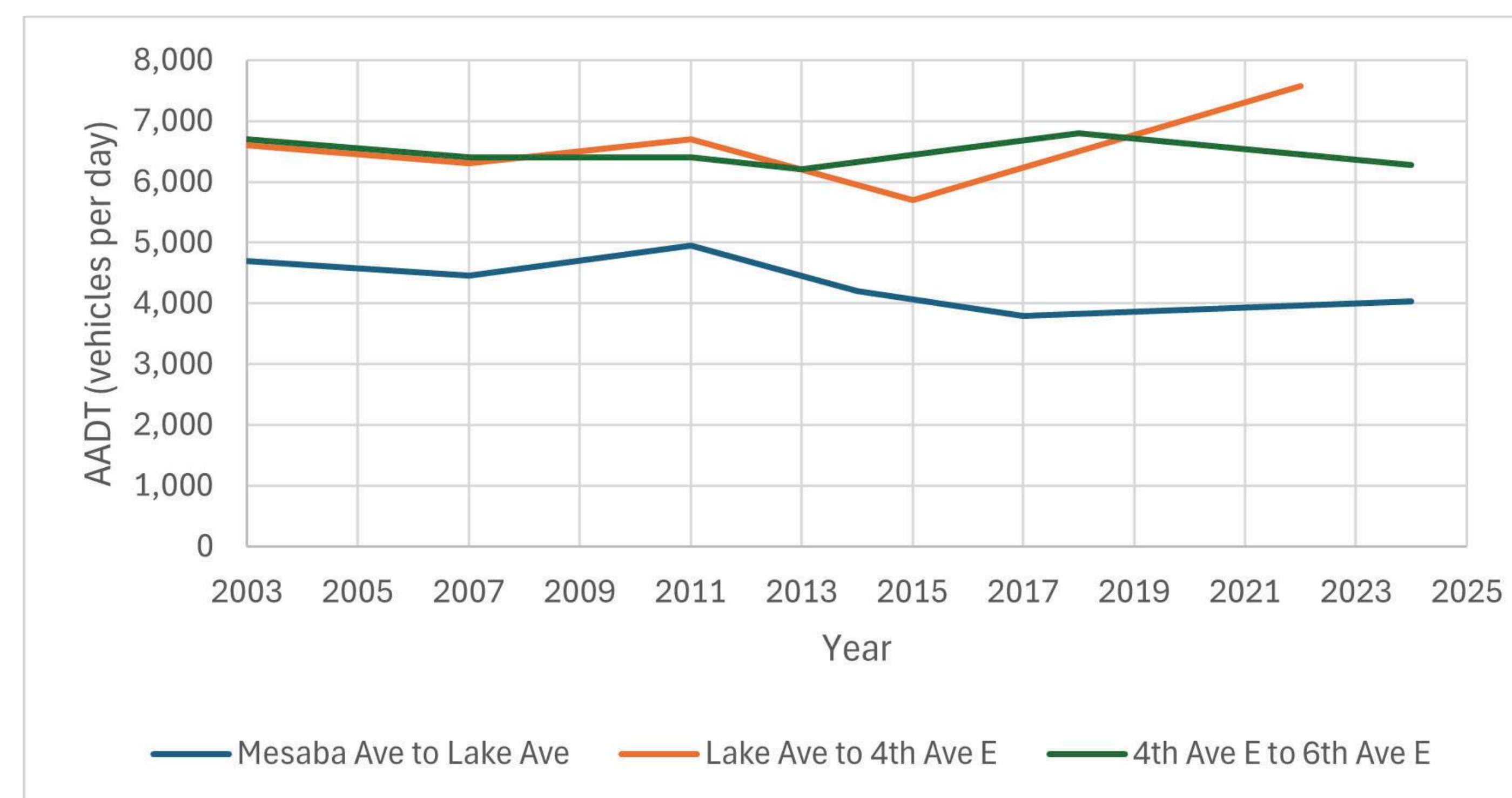

2024 AADT's:

- 4,030 Mesaba to Lake Ave
- 7,570 Lake Ave to 4th Ave E
- 6,280 4th Ave E to 6th Ave E

There has been limited growth in traffic since 2003 and traffic volumes are anticipated to remain similar to current volumes.



4TH STREET RECONSTRUCTION



Survey 1 Results

How do you use the 4th St Corridor?

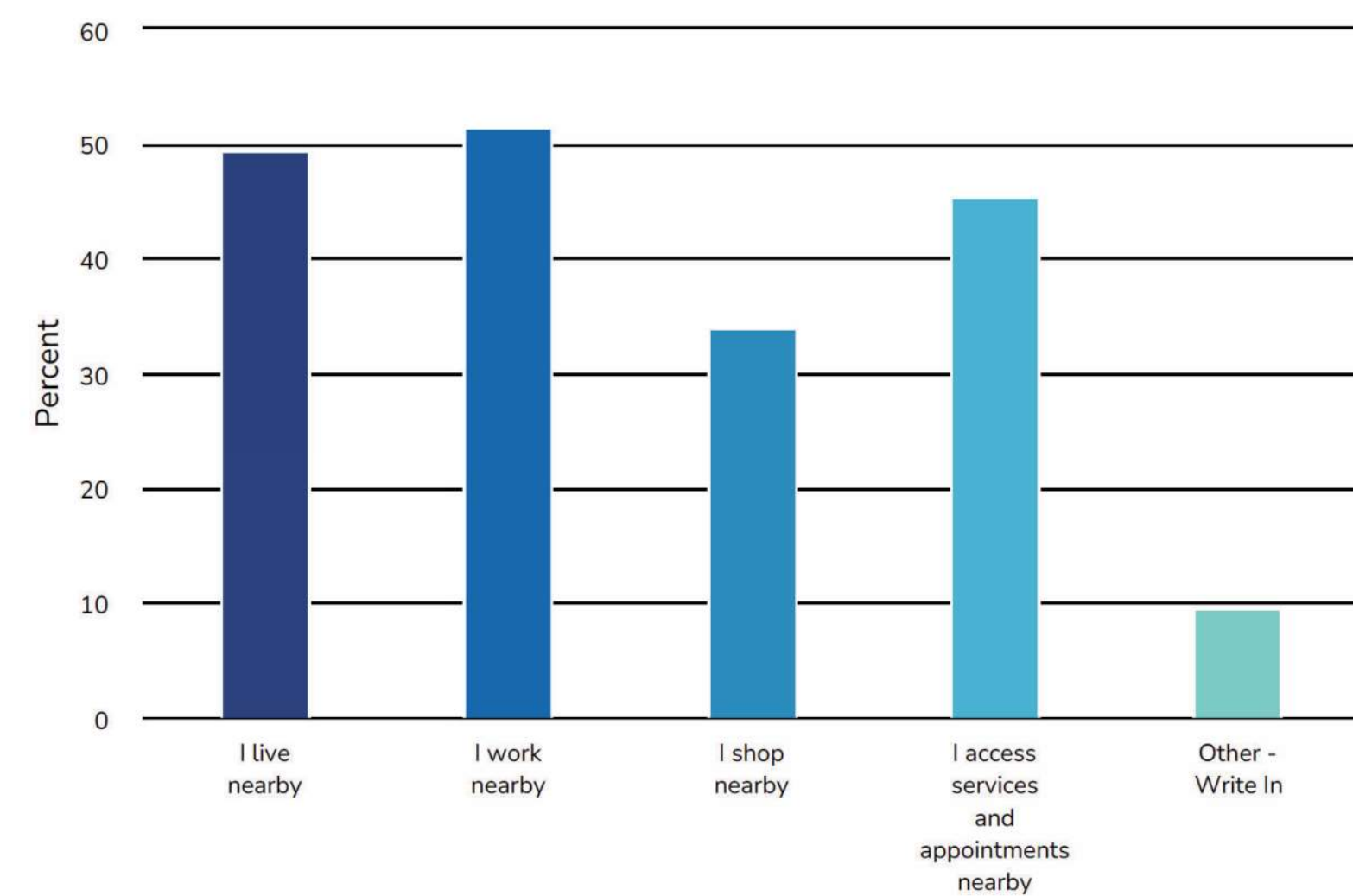

Driving Experience

	Strongly agree	Somewhat agree	Neutral - I am not sure	Somewhat disagree	Strongly disagree
Drivers typically stop for pedestrians at crossings.	4.5%	21.3%	8.9%	37.8%	13.3%
Visibility between drivers and pedestrians is good at intersections.	1.1%	22.5%	12.4%	36.0%	28.1%
Curb extensions (bumpouts) would make pedestrian crossings feel safer.	43.8%	32.6%	14.6%	4.5%	4.5%
The sidewalks and intersections are appropriately lit at night.	6.7%	20.2%	30.3%	32.6%	10.1%
Sidewalks along this roadway are wide enough for comfortable walking.	17.0%	31.8%	19.3%	17.0%	14.8%
Crossing locations are placed where pedestrians want to cross.	7.9%	14.6%	30.3%	37.1%	10.1%
Trees, or street furnishings improve the pedestrian experience.	46.6%	20.5%	17.0%	6.8%	9.1%
There is convenient access to transit stops along 4th Street.	11.2%	22.5%	48.3%	11.2%	6.7%

Pedestrian Comfort, Safety, and Accessibility

	Strongly agree	Somewhat agree	Neutral - I am not sure	Somewhat disagree	Strongly disagree
Drivers typically stop for pedestrians at crossings.	4.5%	21.3%	8.9%	37.8%	13.3%
Visibility between drivers and pedestrians is good at intersections.	1.1%	22.5%	12.4%	36.0%	28.1%
Curb extensions (bumpouts) would make pedestrian crossings feel safer.	43.8%	32.6%	14.6%	4.5%	4.5%
The sidewalks and intersections are appropriately lit at night.	6.7%	20.2%	30.3%	32.6%	10.1%
Sidewalks along this roadway are wide enough for comfortable walking.	17.0%	31.8%	19.3%	17.0%	14.8%
Crossing locations are placed where pedestrians want to cross.	7.9%	14.6%	30.3%	37.1%	10.1%
Trees, or street furnishings improve the pedestrian experience.	46.6%	20.5%	17.0%	6.8%	9.1%
There is convenient access to transit stops along 4th Street.	11.2%	22.5%	48.3%	11.2%	6.7%

How do you and your household travel along this segment?

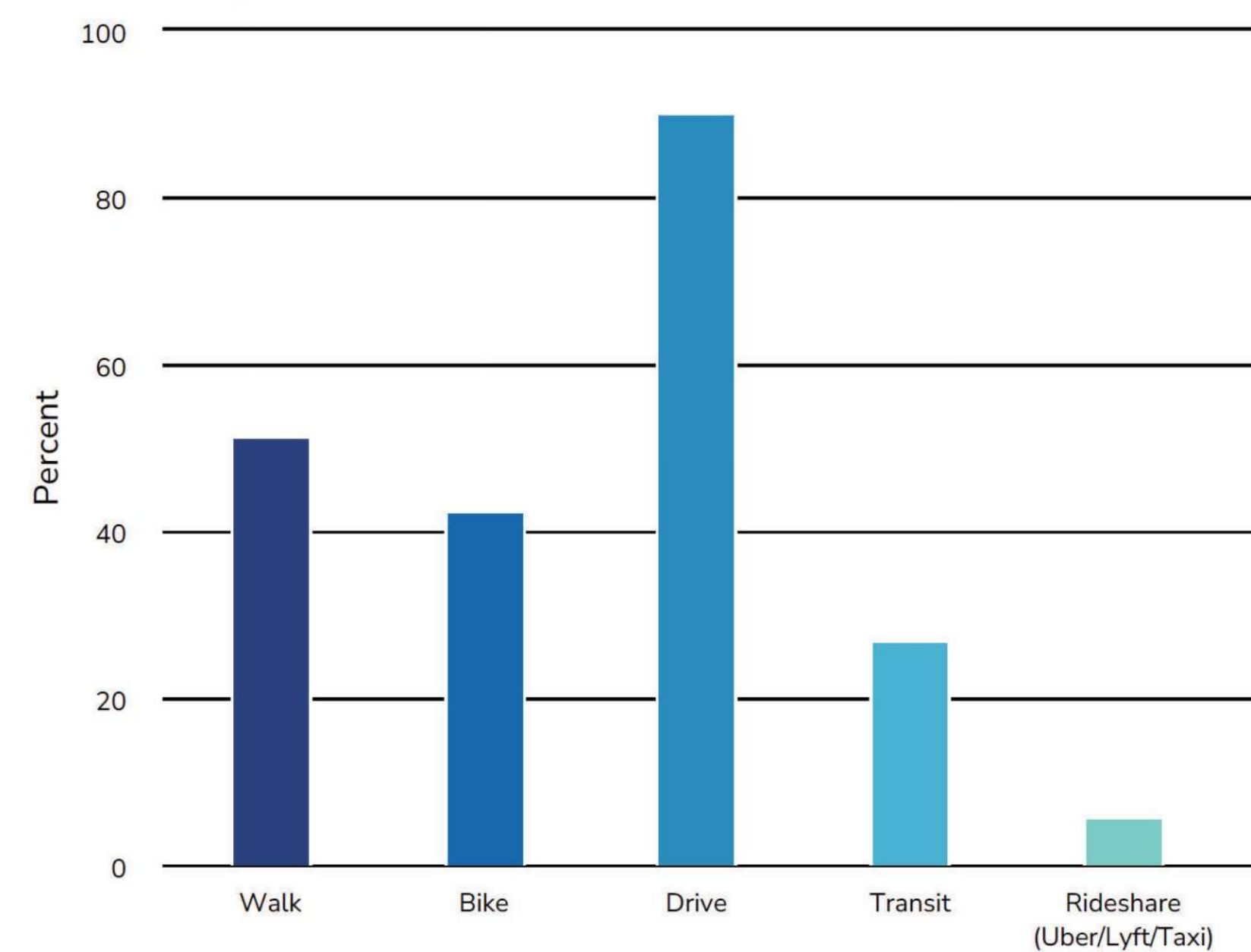

What would improve walking along 4th St?

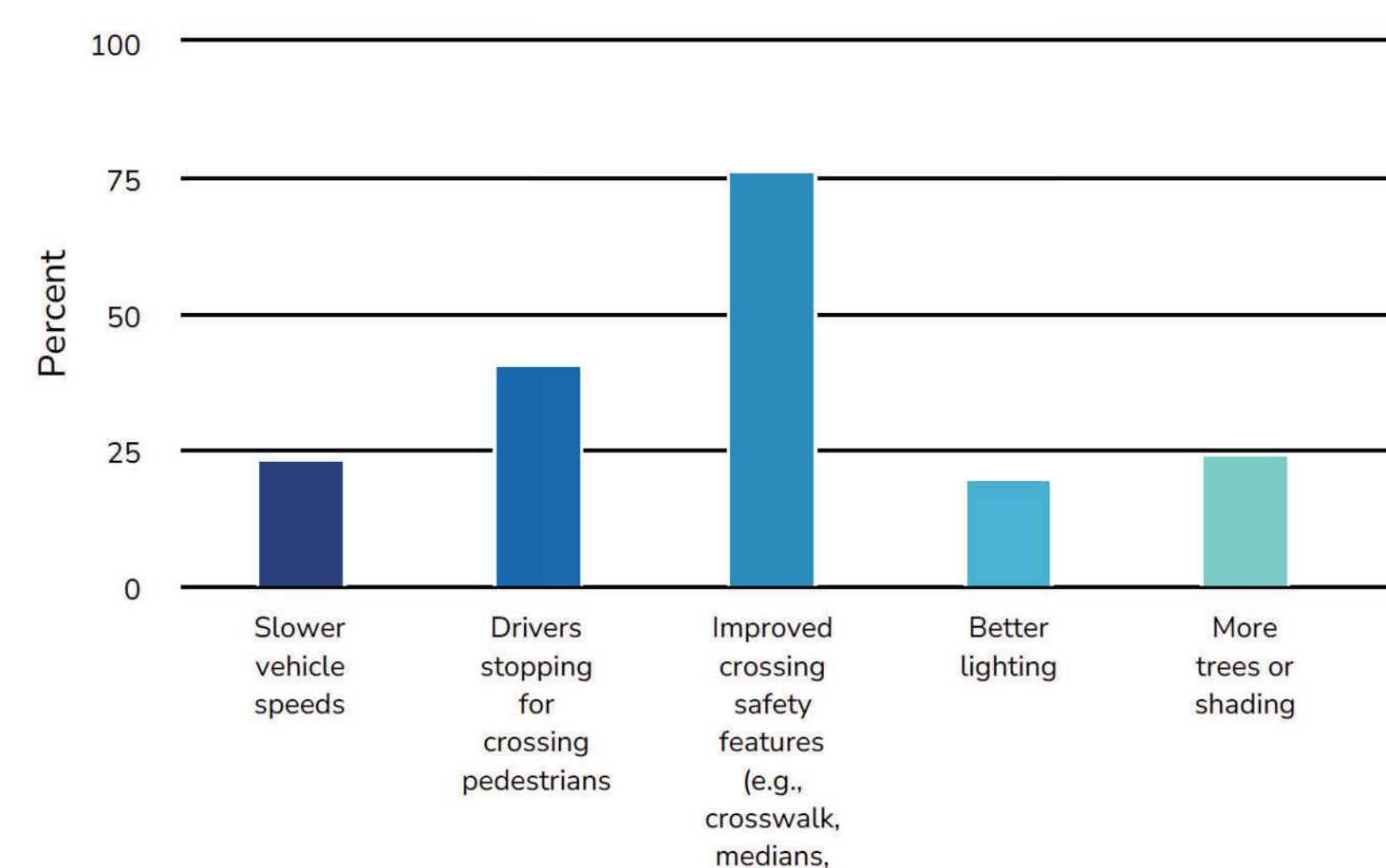

Survey 1 Results

From your experience, what do you think is working well on the 4th Street corridor?



- “Traffic generally flows well and speeds feel manageable”
- “Transit access is convenient, with frequent and reliable bus service”
- “Bike lanes and paths work well, especially near key connections”
- “The corridor works well for driving, with easy access and parking”
- “Sidewalks, crossings, and signals make walking feel doable”

From your experience, what do you think is NOT working well on the 4th Street corridor?



- “Traffic feels busy and unpredictable, especially near major intersections”
- “Parked cars make it hard to see when turning or crossing”
- “It feels hard and sometimes scary to cross the street on foot”
- “Biking doesn't feel safe without a protected bike lane”
- “Sidewalks are narrow, in rough shape, and tough in the winter”

How often do you travel along 4th St using the following modes?

	Daily	Weekly	Monthly	A few times per year	Never
Walk	21.3%	25.8%	18.0%	22.5%	12.4%
Bike	12.1%	16.5%	13.2%	15.4%	42.9%
Drive	31.0%	50.0%	14.0%	0.0%	5.0%
Transit	6.3%	11.3%	13.8%	16.3%	52.5%
Rideshare	0.0%	2.7%	5.4%	24.3%	67.6%

How comfortable do you feel traveling along 4th St using the following modes?

	Very Comfortable	Somewhat Comfortable	Neutral	Somewhat Stressed	Very Stressed	Not Applicable
Walk	11.7%	17.0%	11.7%	36.2%	11.7%	11.7%
Bike	2.1%	7.4%	8.5%	25.5%	25.5%	30.9%
Drive	26.0%	21.0%	27.0%	16.0%	4.0%	6.0%
Transit	16.5%	5.9%	11.8%	9.4%	0.0%	56.5%
Rideshare	4.9%	7.2%	12.2%	2.4%	0.0%	73.2%

How often do vehicles stop for you as you cross 4th Street?

