



CITY OF DULUTH
PURCHASING DIVISION
Room 100 City Hall
411 West First Street
Duluth, Minnesota 55802-1199
218/730-5340 218/730-5922 FAX
purchasing@duluthmn.gov

ADDENDUM #2

BID No. 2017-0266

PROJECT No. 1532

2017 LARGE DIAMETER GAS MAIN INSTALLATION PROJECTS

NOTICE

This addendum serves to notify all bidders of the following changes to the solicitation documents and is hereby made a part of the Contract Documents.

DRAWINGS

1. GENERAL PLAN SET

CLARIFICATION that private sanitary sewer laterals are not depicted on the plan & profile sheets for the 48th Avenue East and 4th Street gas main projects. The City will locate sanitary wye locations and determine when potholing for the utility (payable as a bid item) is necessary.

2. SHEET 1 – TITLE SHEET

CLARIFICATION to correct the sheet index. Note that there is no sheet 47. The sheet index should read as follows:

“	1	TITLE SHEET
	2	SEQ
	3	TRAFFIC CONTROL NOTES
	4-5	SWPPP
	6	EROSION CONTROL DETAILS
	7	STANDARD GAS DETAILS
	8	CASING DETAIL AND STREET CROSS SECTIONS
	9	STANDARD STREET DETAILS
	10-12	PIPE BURSTING 6" 48 TH TRAFFIC CONTROL
	13-15	PIPE BURSTING 6" 48 TH EROSION CONTROL
	16-25	PIPE BURSTING 6" 48 TH PLAN & PROFILE
	26-29	8" MDPE ON 4 TH ST TRAFFIC CONTROL
	30-33	8" MDPE ON 4 TH ST EROSION CONTROL
	34-40	8" MDPE ON 4 TH ST PLAN & PROFILE
	41-43	12" HDPE ON LONDON RD. TRAFFIC CONTROL
	44-46	12" HDPE ON LONDON RD. EROSION CONTROL
	47	**SHEET 46 IS OMITED**
	48-53	12" HDPE ON LONDON RD. PLAN & PROFILES
	54	LONDON ROAD CONNECTION DETAIL
	55-57	48 TH AVE E. CONNECTION PROCEDURES
	58-63	4 TH STREET CONNECTION PROCEDURES
“		

3. SHEET 8

CLARIFICATION that “rubblized concrete” in the Superior St. Typical Section detail represents the existing conditions, this material shall be replaced as “8” base concrete layer”.

4. SHEET 55 - 63

ADD the attached plan sheets 55 through 63 in their entirety which explain the procedures for construction of the 48th Ave East project and the 4th Street project.

SPECIFICATIONS

ADD the following paragraph to SP-21 MATERIALS AND WORK TO BE FURNISHED BY THE PUBLIC WORKS & UTILITIES DEPARTMENT:

“F. The Department will furnish 2” steel blind flanges for the Contractor to temporarily install on closed steel valves during the abandonment procedures of the 48th Avenue East Adaly-A pipe. Once the valves are removed the Contractor will return the blind flange materials to the City.

ADD the following section SP-29 EROSION CONTROL SUPERVISOR to the project special provisions:

“SP-29 EROSION CONTROL SUPERVISOR

Scope of the Erosion Control Supervisor bid item shall include procurement and implementation of the NPDES Construction Storm Water permit. Procurement includes completing the online application for the NPDES permit and payment of the permit fees. A copy of the permit, or a permit confirmation, shall be provided to the City of Duluth once the permit is obtained.

During the project, the erosion control practices shall be installed, inspected, and maintained under the supervision of an individual whom has completed the classroom training and obtained a Certified SWPPP Installer status in the state of Minnesota. Weekly and routine inspections based upon rain events, of the erosion control BMP’s and construction site is required as part of the permit implementation. This supervisor shall be responsible to complete inspection reports and maintain them at a designated onsite location. Copies of the inspections reports must be submitted to the City as PDF documents at the end of the project or as requested during the project.

Upon completion of the project, the final 1/3 of the bid item payment shall be released when the Contractor files the permit Notice of Termination form jointly with the City.

END OF ADDENDUM

Please acknowledge receipt of this Addendum by initialing and dating Addendum # below the bid form on the invitation for bids.

Posted Date. March 28, 2017

I:\PWU\ENGINEER\PROJECTS\1500-1999\1532_48th Ave. E. Gas Main\23-ACAD-DRAWINGS\48TH AVE. W\1532-CNX-DTLS.dwg

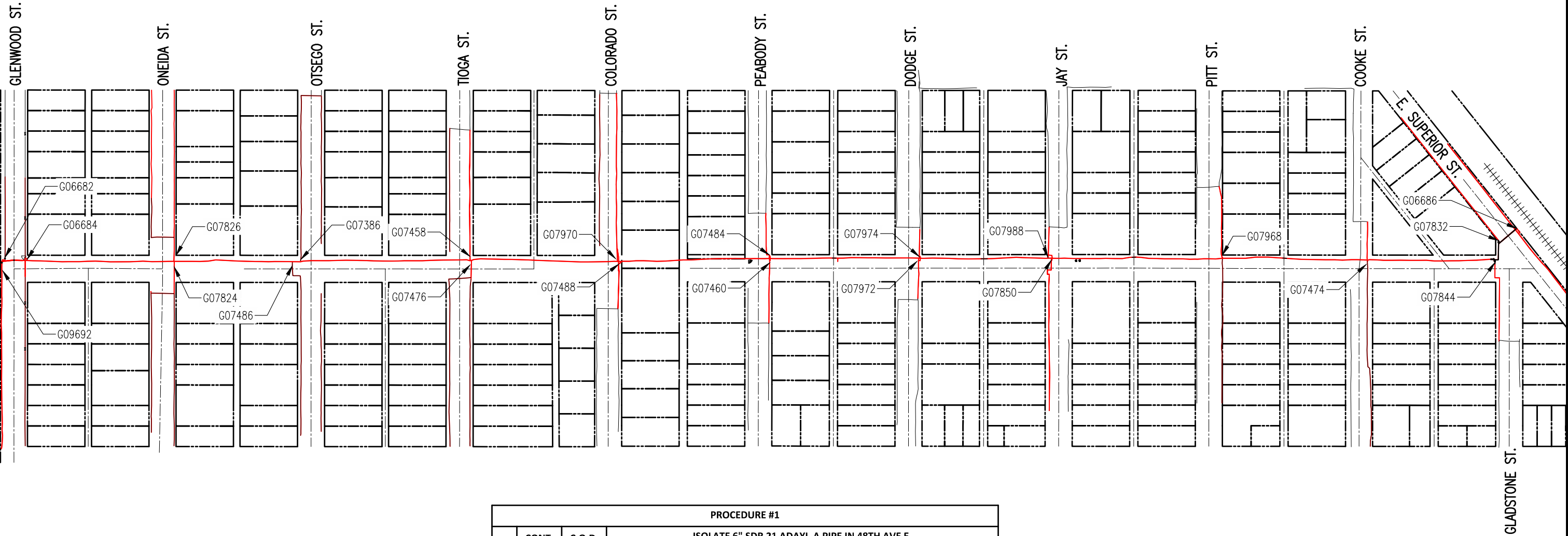

PROCEDURE #1			
	CONT.	C.O.D.	ISOLATE 6" SDR 21 ADAYL-A PIPE IN 48TH AVE E.
1	X	X	CONFIRM THAT ALL ACTIVE SERVICES HAVE BEEN REMOVED FROM THE 6" ADALY-A PIPE AND HAVE BEEN RECONNECTED TO OTHER MAINS.
2		X	ISOLATE THE 6" ADALY-A PIPE BY CLOSING THE FOLLOWING VALVES (22 TOTAL): G09692, G06682, G06684, G07826, G07824, G07486, G07386, G07458, G07476, G07970, G07488, G07484, G07460, G07972, G07974, G07988, G07850, G07968, G07474, G07844, G07832, G06686

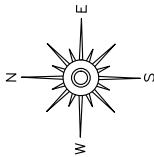

I HEREBY CERTIFY THAT THIS PLAN WAS PREPARED BY ME OR UNDER MY DIRECT SUPERVISION AND THAT I AM A DULY LICENSED PROFESSIONAL ENGINEER UNDER THE LAWS OF THE STATE OF MINNESOTA.

SIGNATURE: Howard D. Smith, P.E.

HOWARD D. SMITH, P.E.
TYPE NAME

DATE: 03/27/2017

LIC. NO: 46875



CITY OF DULUTH
ENGINEERING DIVISION
411 W. 1ST ST. STE. 211
DULUTH, MN 55802

2017 LARGE DIAMETER GAS MAIN INSTALATION PROJECTS

CITY PROJECT NO.: 1532

STATE AID PROJECT NO.: NA

DRAWN BY: J.R.L.

48TH AVE E. PROCEDURES

SHEET NO. 55 OF 63

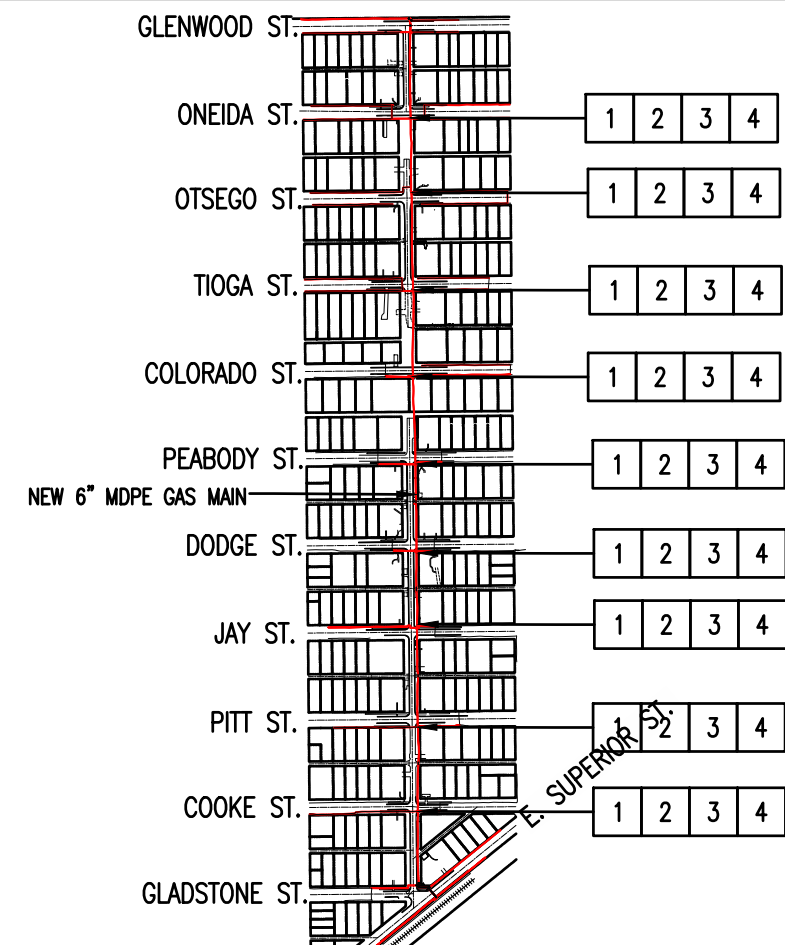
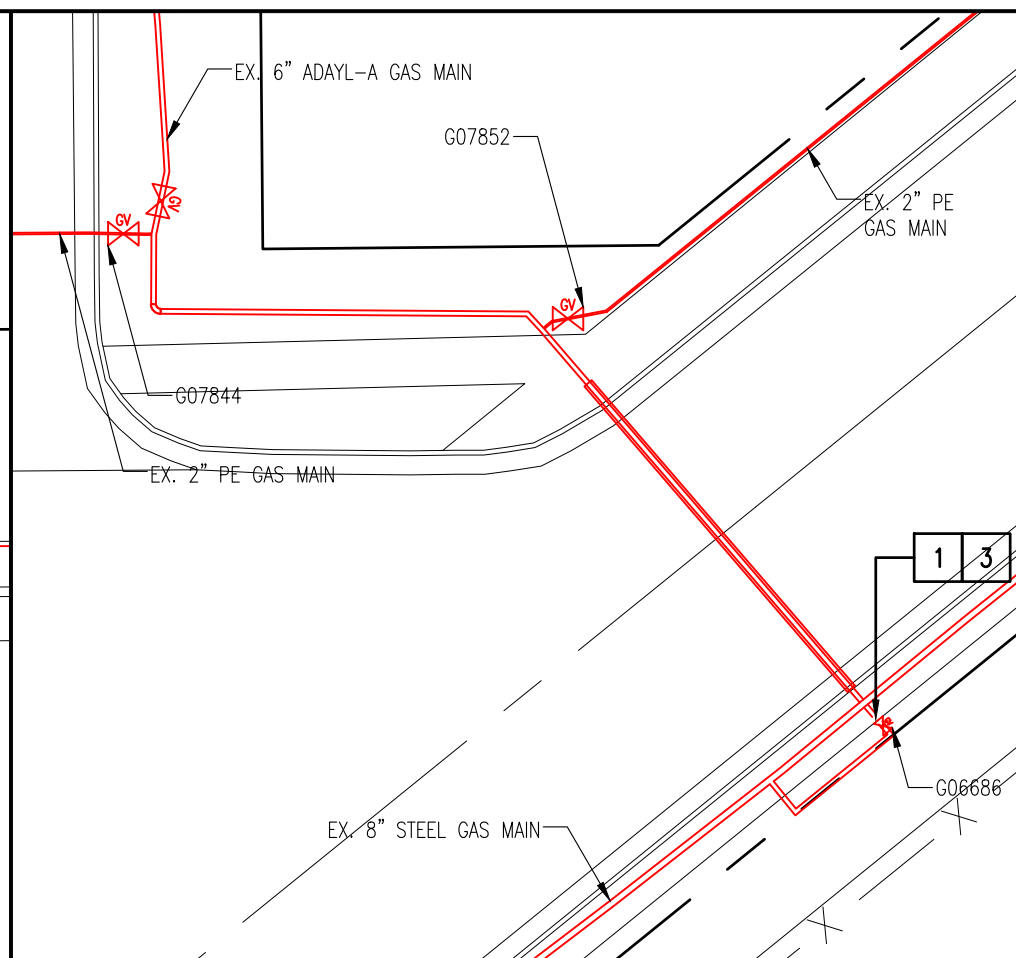
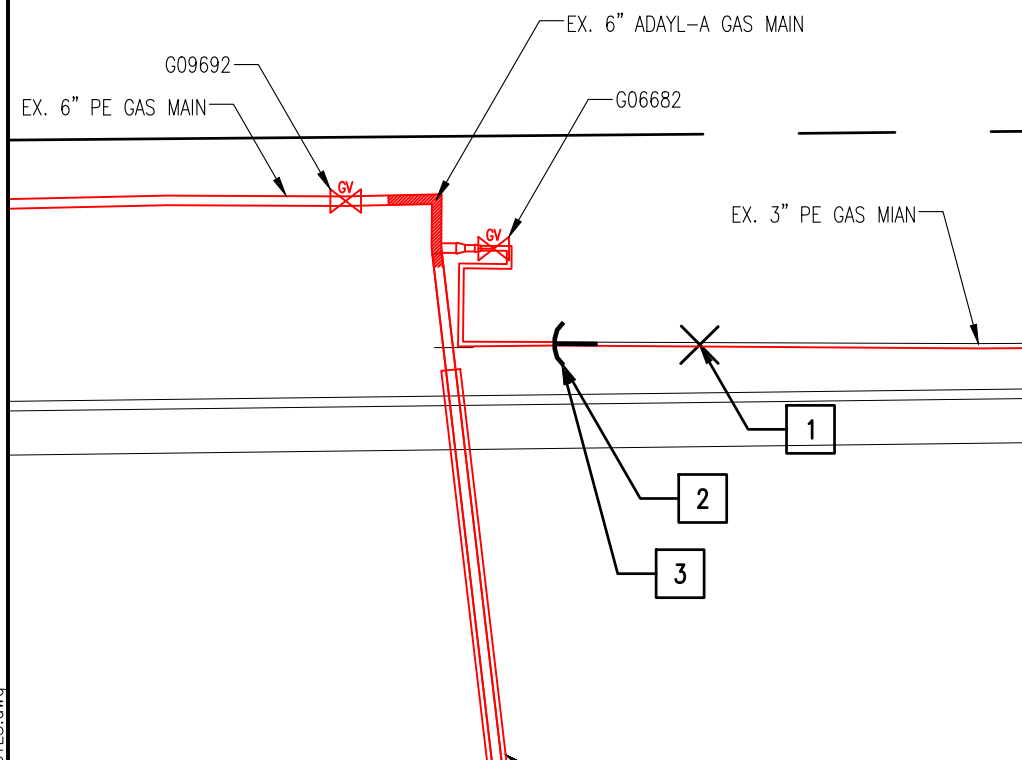
[illegible][illegible][illegible]

I HEREBY CERTIFY THAT THIS PLAN WAS PREPARED BY ME OR UNDER MY DIRECT SUPERVISION AND THAT I AM A DULY LICENSED PROFESSIONAL ENGINEER UNDER THE LAWS OF THE STATE OF MINNESOTA.

SIGNATURE: Howard Smith, P.E.

HOWARD D. SMITH, P.E.
TYPE NAME

DATE: 03/27/2017

LIC. NO: 46875



CITY OF DULUTH
ENGINEERING DIVISION
411 W. 1ST ST. STE. 211
DULUTH, MN 55802

2017 LARGE DIAMETER GAS MAIN INSTALATION PROJECTS

CITY PROJECT NO.: 1532

STATE AID PROJECT NO.: NA

DRAWN BY: J.R.L.

48TH AVE E. PROCEDURES

SHEET NO. 56 OF 63

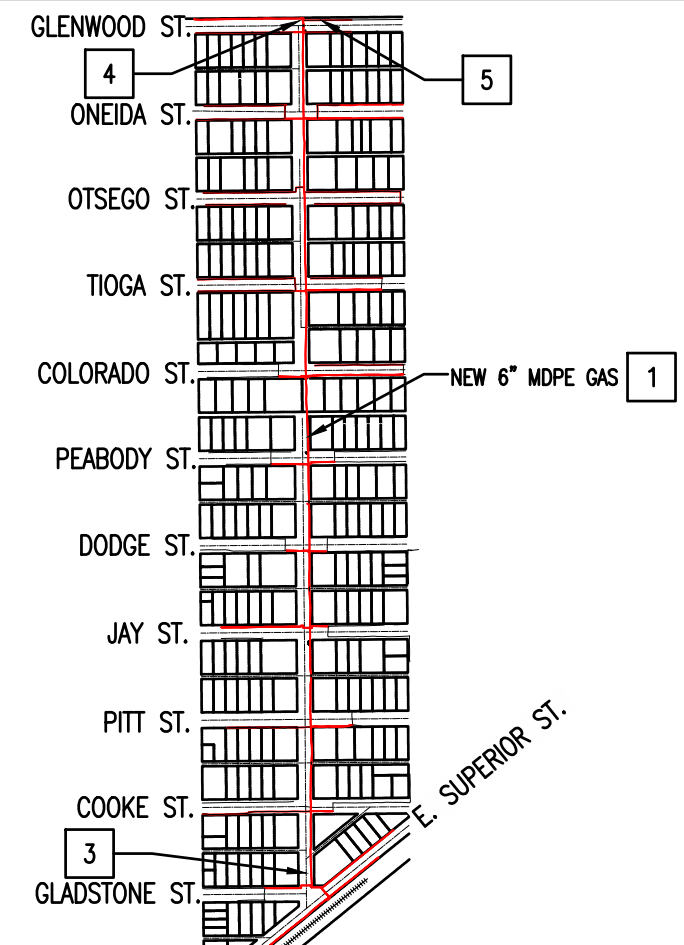
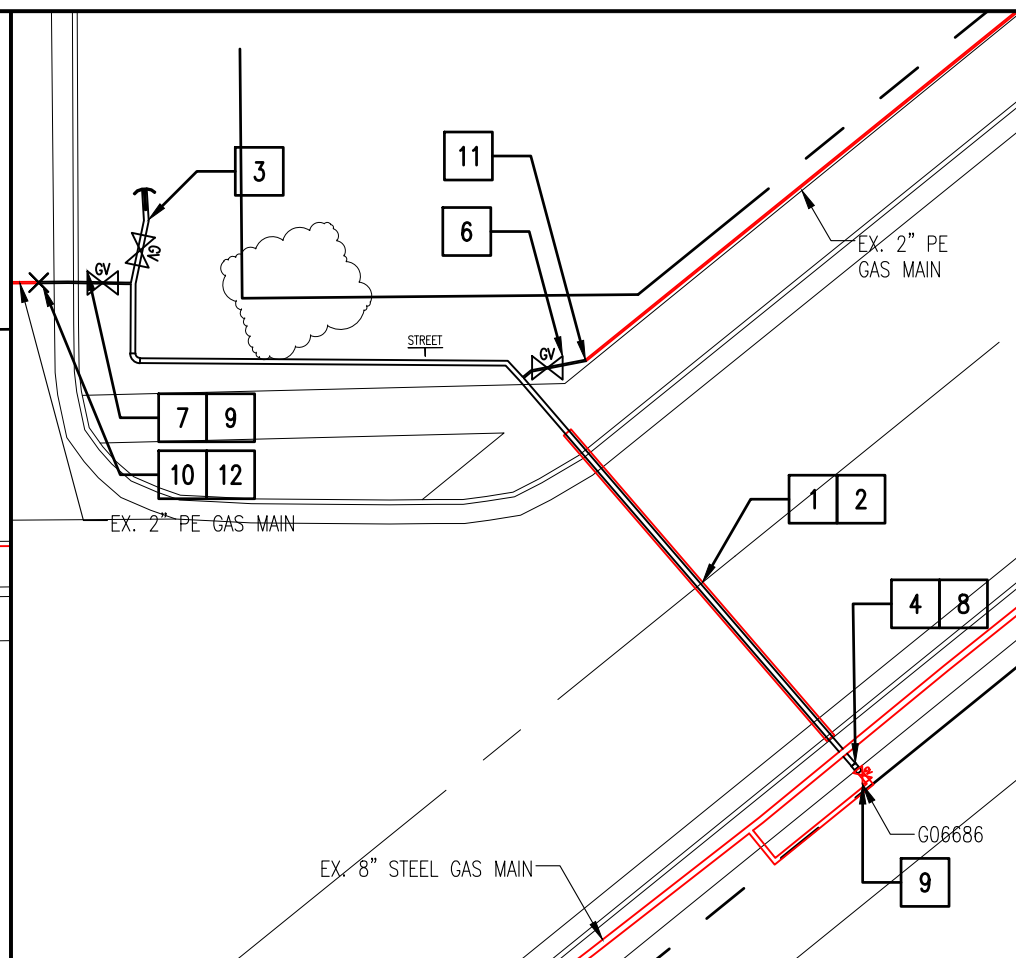
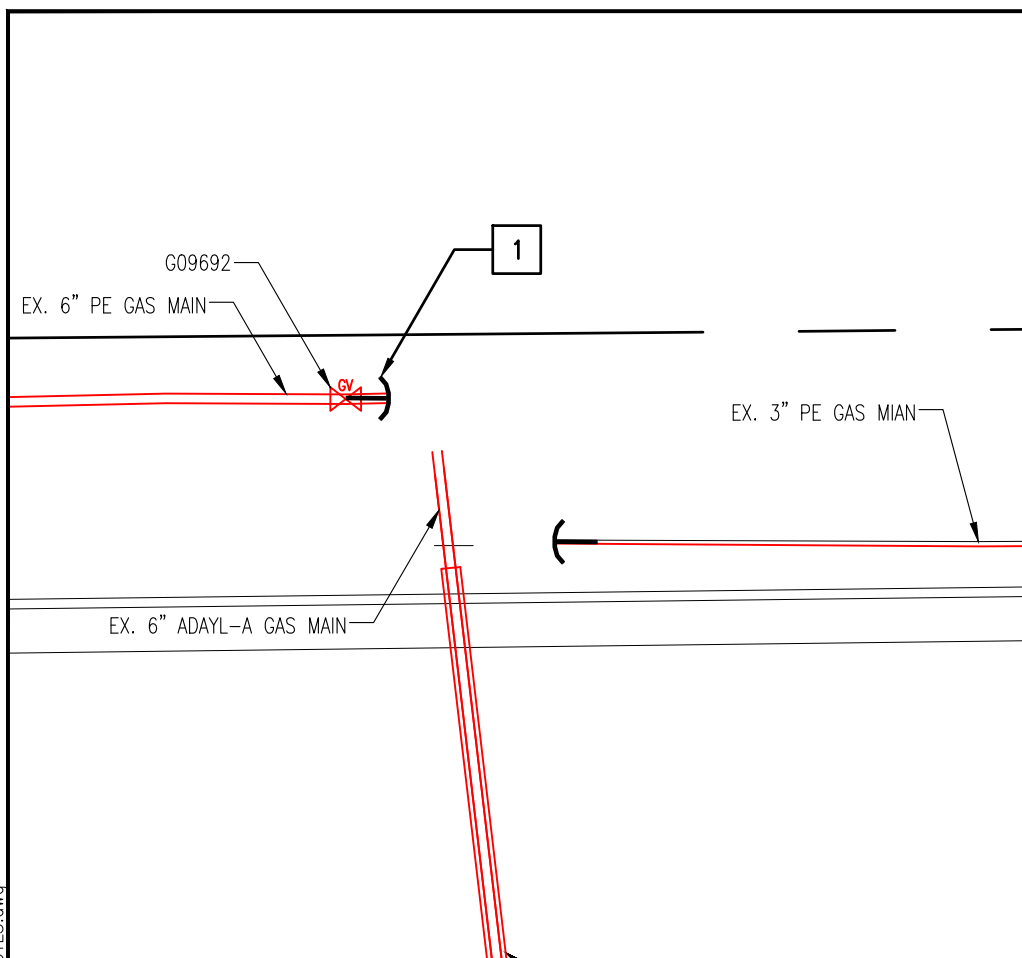
[illegible]

PROCEDURE #6			
	CONT.	C.O.D.	INSTALL AND ACTIVATE NEW 6" PE FROM CROSSING SUPERIOR STREET TO 48TH AVE E.
1	X		REMOVE 6" ADALY-A FROM THE EXISTING CASING UNDER SUPERIOR STREET
2	X		CLEAN AND INSPECT THE EXISTING CASING PER THE PROJECT SPECIAL PROVISIONS
3	X		INSTALL NEW 6" MDPE FROM VALVE G06686 TO JUST NORTH OF THE BRANCH MAIN CONNECTION ON GLADSTONE STREET
4	X		INSTALL NEW 6" FLANGED TRANSITION PROVIDED BY DEPARTMENT TO THE RECENTLY INSERTED 6" MDPE PIPE IN SUPERIOR STREET
5			AIR TEST AND PIG THIS SEGMENT OF 6" MDPE FROM VALVE G06686 TO GLADSTONE STREET
6	X	X	INSTALL 2" H.V. TEE WITH A 2" PE VALVE, A STUB OF 2" MDPE AND CAP AT THE GLADSTONE STREET & SUPERIOR STREET BRANCH MAIN CONNECTION, TEST 2" CONNECTION PIPING PRIOR TO TAPPING THE 6" MAIN
7	X	X	INSTALL 2" H.V. TEE WITH A 2" PE VALVE, A STUB OF 2" MDPE AND CAP AT THE GLADSTONE STREET & 48TH AVE. E. BRANCH MAIN CONNECTION, TEST 2" CONNECTION PIPING PRIOR TO TAPPING THE 6" MAIN
8		X	REMOVE THE TEMPORARY BLIND FLANGE AND CONNECT THE FLANGED TRANSITION END TO VALVE G06686
9	X	X	OPEN VALVE G06686 AND PURGE AIR TO GAS THROUGH THE NEW 2" H.V. TEE AND VALVE AT GLADSTONE STREET AND 48TH AVE. E., CLOSE THE NEW 2" VALVE
10	X		SQUEEZE THE EXISTING 2" PE MAIN IN GLADSTONE STREET AND 48TH AVE. E., REMOVE VALVE G07844, AND RECONNECT TO THE NEW 2" MDPE PIPE, REMOVE 2" SQUEEZE (ANY 2" MDPE USED IN THIS STEP SHALL BE PRETESTED)
11	X	X	SQUEEZE 2" MAIN IN SUPERIOR ST EAST OF EX. VALVE (G07832)
12	X		CONNECT TO THE BRANCH MAIN AT GLADSTONE STREET AND SUPERIOR STREET, TAP THE NEW 2" H.V. TEE, OPEN NEW 2" VALVE, AND SOAP TEST CONNECTION
13	X	X	SOAP TEST NEW CONNECTIONS

[illegible]

I HEREBY CERTIFY THAT THIS PLAN WAS PREPARED BY ME OR UNDER MY DIRECT SUPERVISION AND THAT I AM A DULY LICENSED PROFESSIONAL ENGINEER UNDER THE LAWS OF THE STATE OF MINNESOTA.

SIGNATURE: Howard Smith, P.E.

HOWARD D. SMITH, P.E.
TYPE NAME

DATE: 03/27/2017

LIC. NO: 46875



CITY OF DULUTH
ENGINEERING DIVISION
411 W. 1ST ST. STE. 211
DULUTH, MN 55802

2017 LARGE DIAMETER GAS MAIN INSTALATION PROJECTS

CITY PROJECT NO.: 1532

STATE AID PROJECT NO.: NA

DRAWN BY: J.R.L.

48TH AVE E. PROCEDURES

SHEET NO. 57 OF 63

I:\PWU\ENGINEER\PROJECTS\1500-1999\1532-48th Ave. E. Gas Main\23-ACAD-DRAWINGS\48TH AVE. W\1532-CNX-DTLS.dwg

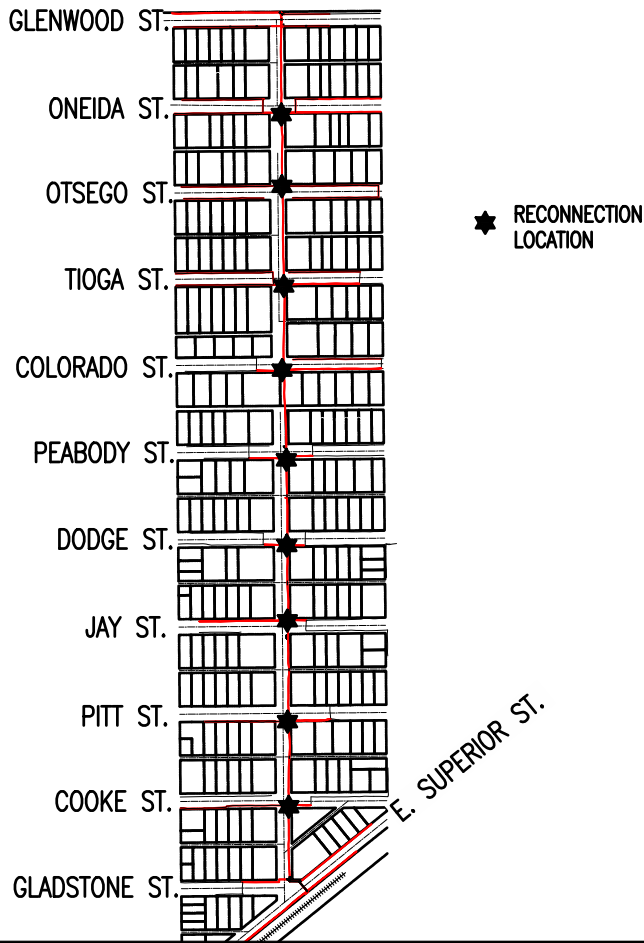
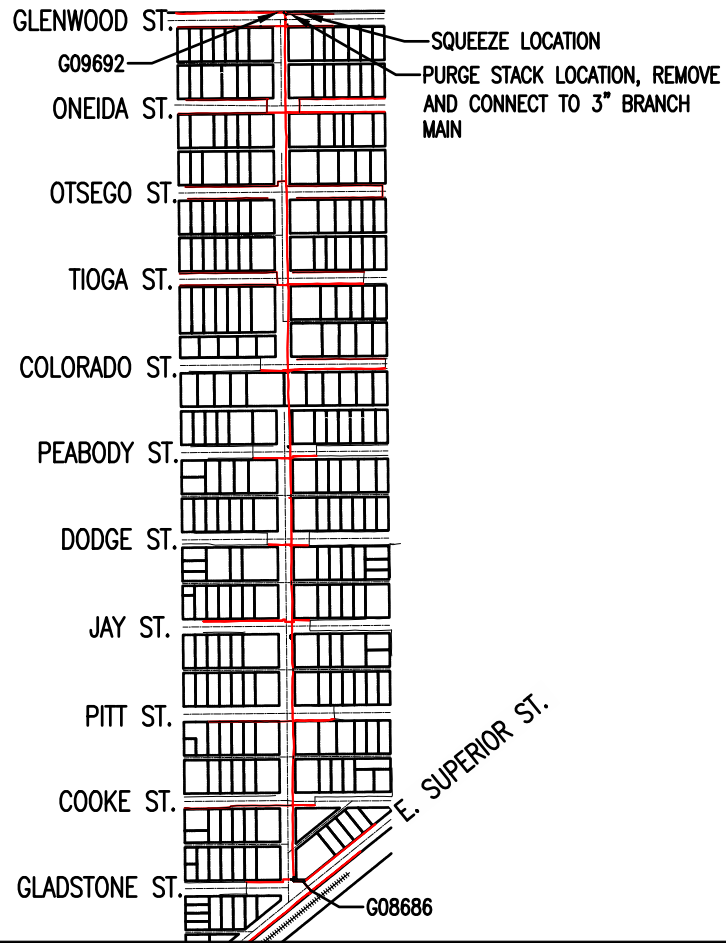

PROCEDURE #8			
	CONT.	C.O.D.	AIR TO GAS PURGE AND ACTIVATION OF NEW 6" MAIN IN 48TH AVE E.
1		X	INSTALL PURGE STACK ON 3" PE STUB OF PIPE AT GLENWOOD STREET, OPEN NEW 3" VALVE
2		X	OPEN VALVE G06686 TO PURGE AIR TO GAS THROUGH ALL THE NEW 6" MDPE GAS MAIN IN 48TH AVENUE EAST TO THE PURGE STACK INSTALLED ON THE 3" BRANCH AT GLENWOOD STREET
3		X	CLOSE VALVE NEW 3" PE VALVE AT GLENWOOD STREET AND REMOVE PURGE STACK FROM BRANCH MAIN PIPE STUB (NEW 6" MDPE MAIN IS NOW LIVE)
4	X		SOAP TEST NEW 6" CONNECTIONS AT GLADSTONE AND GLENWOOD STREETS
5		X	OPEN VALVE G09692 AND BOTH OF THE NEW 2" PE VALVES AT GLADSTONE STREET
6	X		SQUEEZE 3" MDPE MAIN EAST ALONG GLENWOOD STREET, REMOVE CAP AND CONNECT THE EXISTING 3" BRANCH MAIN TO THE NEW BRANCH STUB WHICH WAS JUST USED FOR PURGING, OPEN 3" PE VALVE AND SOAP TEST CONNECTION

PROCEDURE #9			
	CONT.	C.O.D.	RECONNECT REMAINING BRANCH MAINS
1		X	INSTALL, TEST, AND TAP CONTRACTOR SUPPLIED 6"X2" H.V. TAP TEES WITH A 2" P.E. VALVE AND A STUB OF 2" PE PIPE AT EACH BRANCH MAIN LOCATION
2	X		SQUEEZE EXISTING BRANCH MAINS TO ISOLATE THE EXISTING STEEL VALVES, REMOVE AND RETURN TEMPORARY BLIND FLANGE
3	X		REMOVE THE EXISTING VALVE, TRANSITION, AND ANY REMAINING ADALY-A PIPE
4	X		ADD PRE-TESTED 2" PE PIPE AS NECESSARY AND RECONNECT THE BRANCH MAINS TO THE NEW 2" VALVES, IF REQUIRED BY ENGINEERING PURGE THE SEGMENTS OF PIPE PRIOR TO CONNECTION
5	X		OPEN THE NEW 2" PE VALVE, PRESSURIZE SEGMENTS BETWEEN BRANCH SADDLE AND SQUEEZE, SOAP TEST CONNECTIONS, THEN REMOVE SQUEEZE
			REPEATE THIS PROCEDURE UNTIL ALL BRANCH MAINS ARE CONNECTED AS DETAILED IN THE PLANS
6	X		ABANDON AND CAP EXISTING TAP TEES USED FOR BRANCH MAIN JUMPERS DURING THIS PROJECT
7	X		REMOVE OR ABANDON THE 2" PE JUMPERS BETWEEN BRANCH MAINS AS DIRECTED BY ENGINEERING
8	X		SOAP TEST FINAL ABANDONMENTS AND CONNECTIONS

I HEREBY CERTIFY THAT THIS PLAN WAS PREPARED BY ME OR UNDER MY DIRECT SUPERVISION AND THAT I AM A DULY LICENSED PROFESSIONAL ENGINEER UNDER THE LAWS OF THE STATE OF MINNESOTA.

SIGNATURE: Howard D. Smith, P.E.

HOWARD D. SMITH, P.E.
TYPE NAME

DATE: 03/27/2017

LIC. NO: 46875



CITY OF DULUTH
ENGINEERING DIVISION
411 W. 1ST ST. STE. 211
DULUTH, MN 55802

2017 LARGE DIAMETER GAS MAIN INSTALATION PROJECTS

CITY PROJECT NO.: 1532

STATE AID PROJECT NO.: NA

DRAWN BY: J.R.L.

48TH AVE E. PROCEDURES

SHEET NO. 58 OF 63

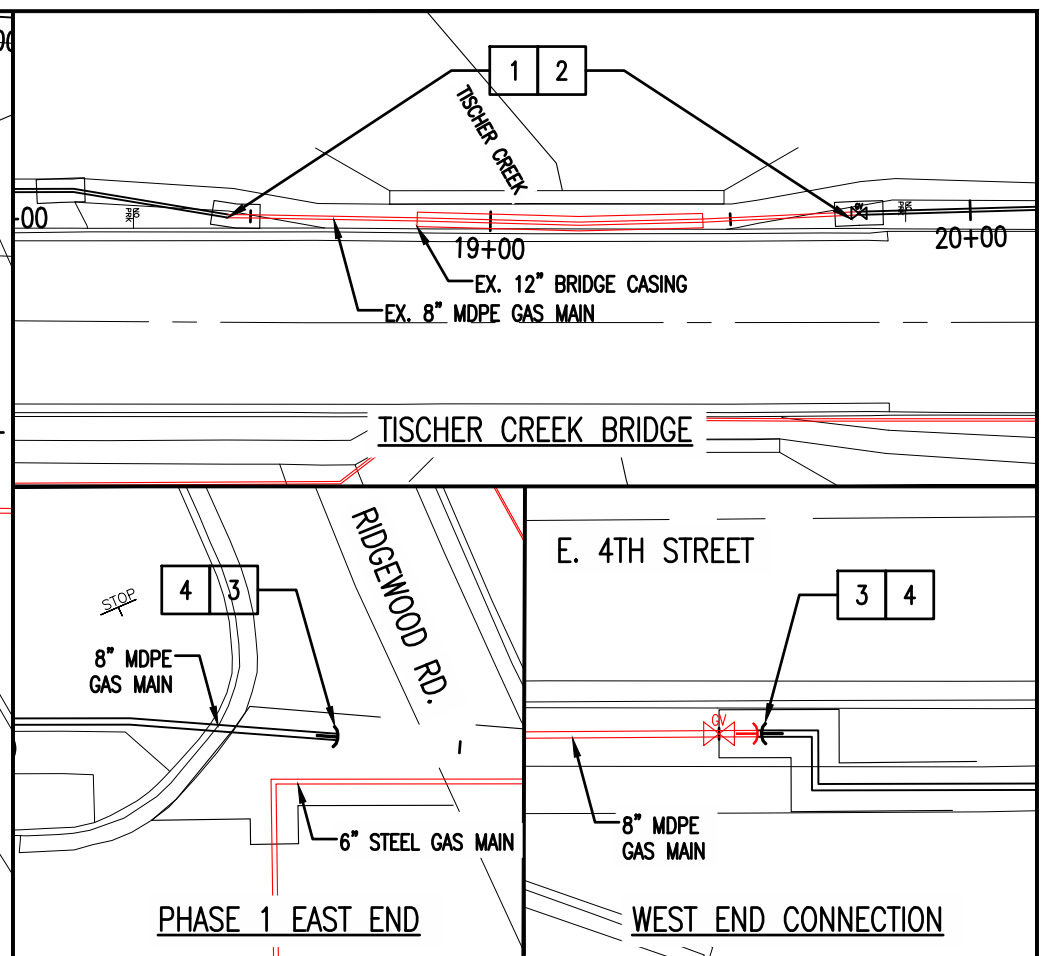
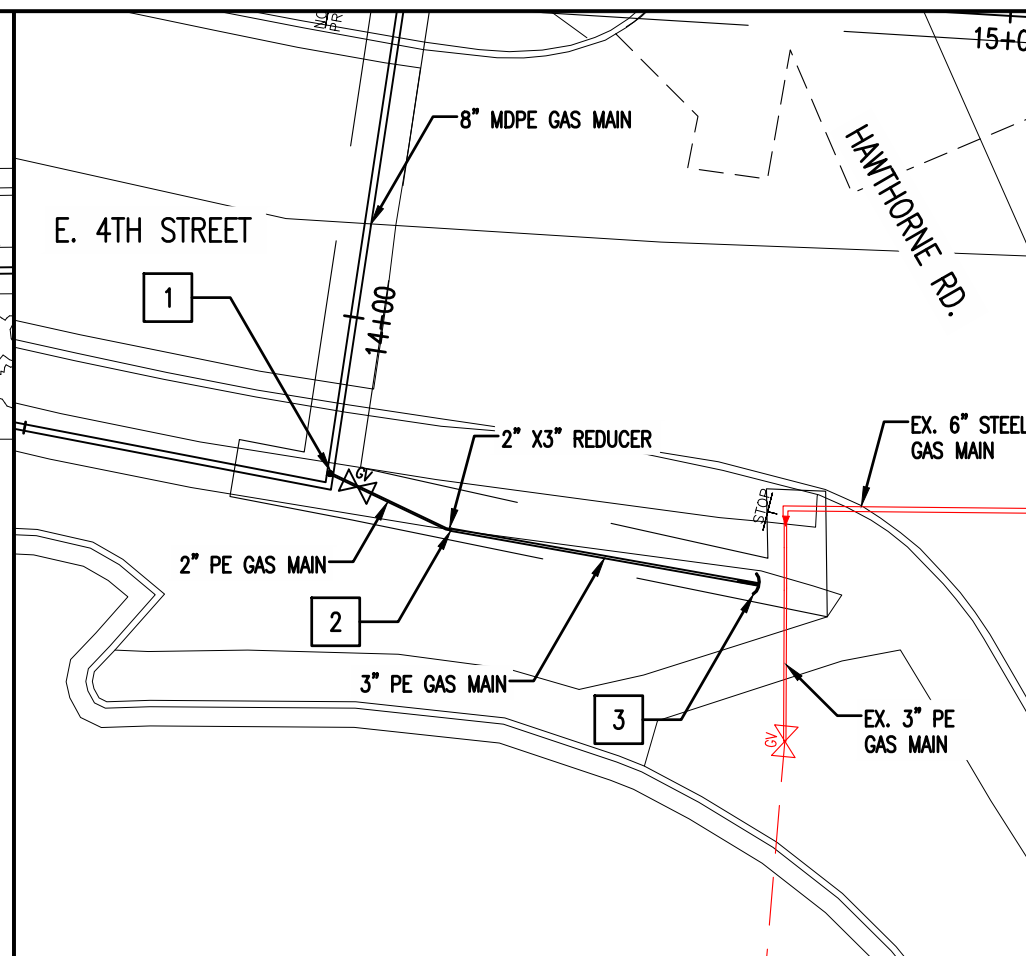
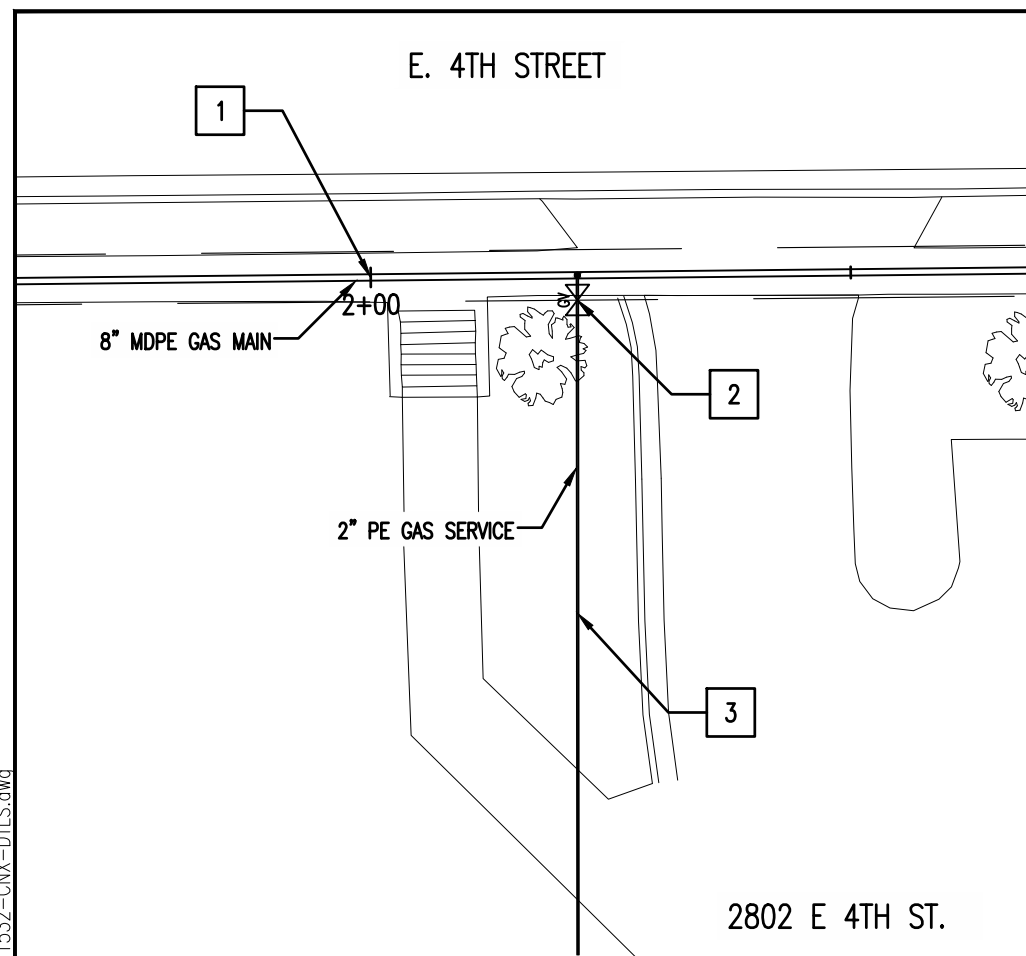
[illegible][illegible][illegible]

I HEREBY CERTIFY THAT THIS PLAN WAS PREPARED BY ME OR UNDER MY DIRECT SUPERVISION AND THAT I AM A DULY LICENSED PROFESSIONAL ENGINEER UNDER THE LAWS OF THE STATE OF MINNESOTA.

SIGNATURE: Howard Smith, P.E.

HOWARD D. SMITH, P.E.
TYPE NAME

DATE: 03/27/2017

LIC. NO: 46875



CITY OF DULUTH
ENGINEERING DIVISION
411 W. 1ST ST. STE. 211
DULUTH, MN 55802

2017 LARGE DIAMETER GAS MAIN INSTALATION PROJECTS

CITY PROJECT NO.: 1532

STATE AID PROJECT NO.: NA

DRAWN BY: J.R.L.

4TH ST PROCEDURES

SHEET NO. 59 OF 63

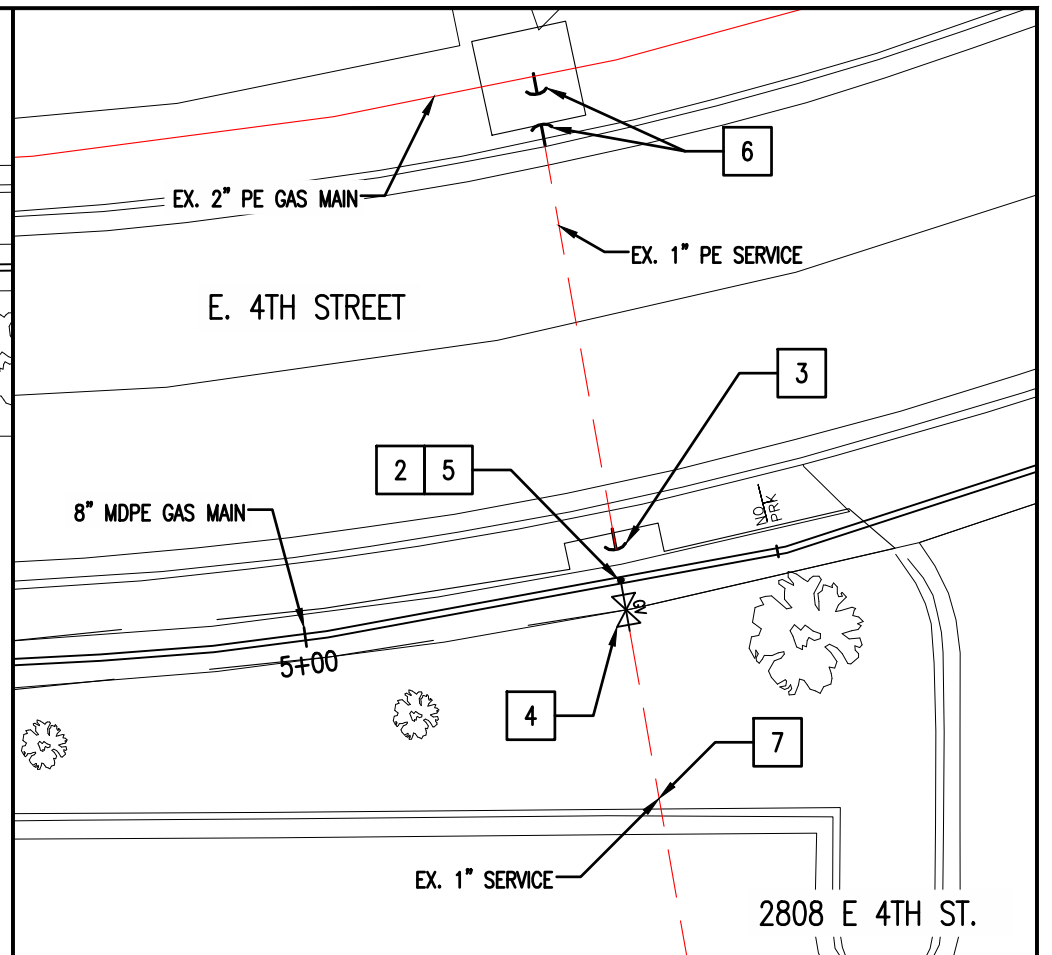
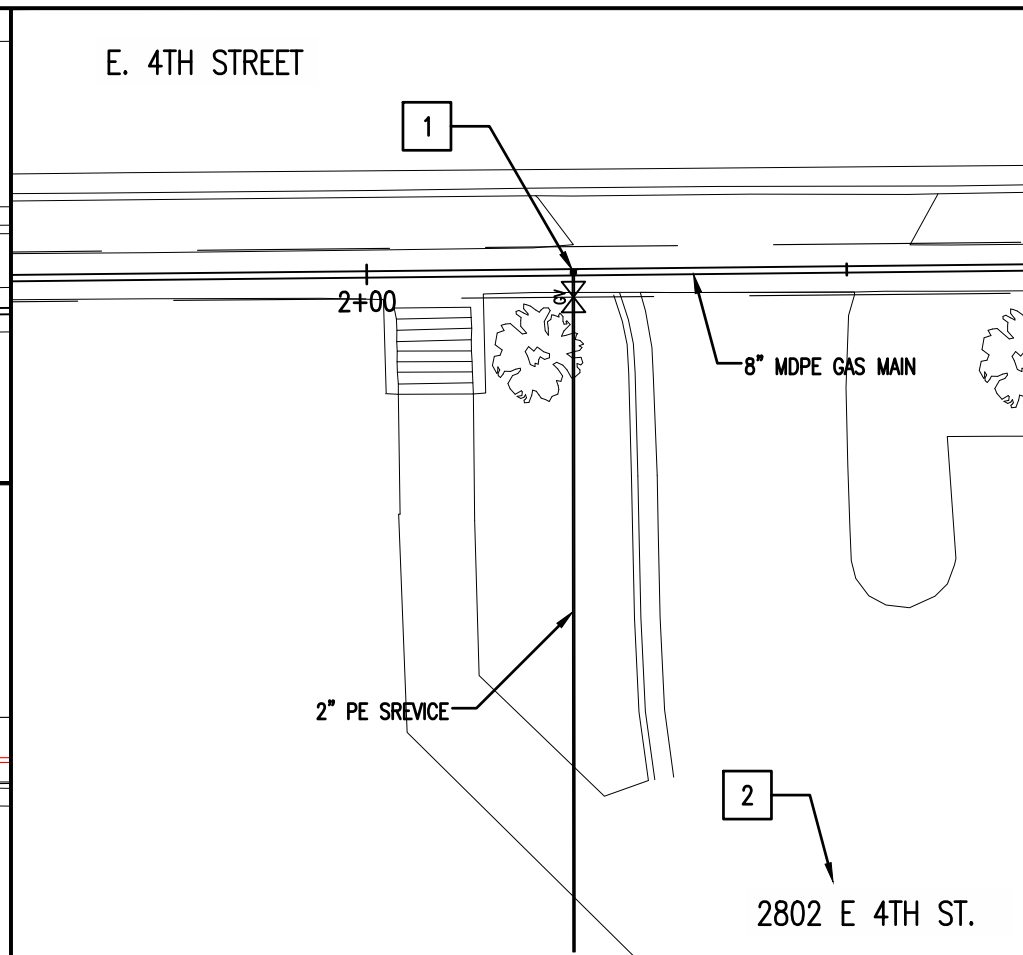
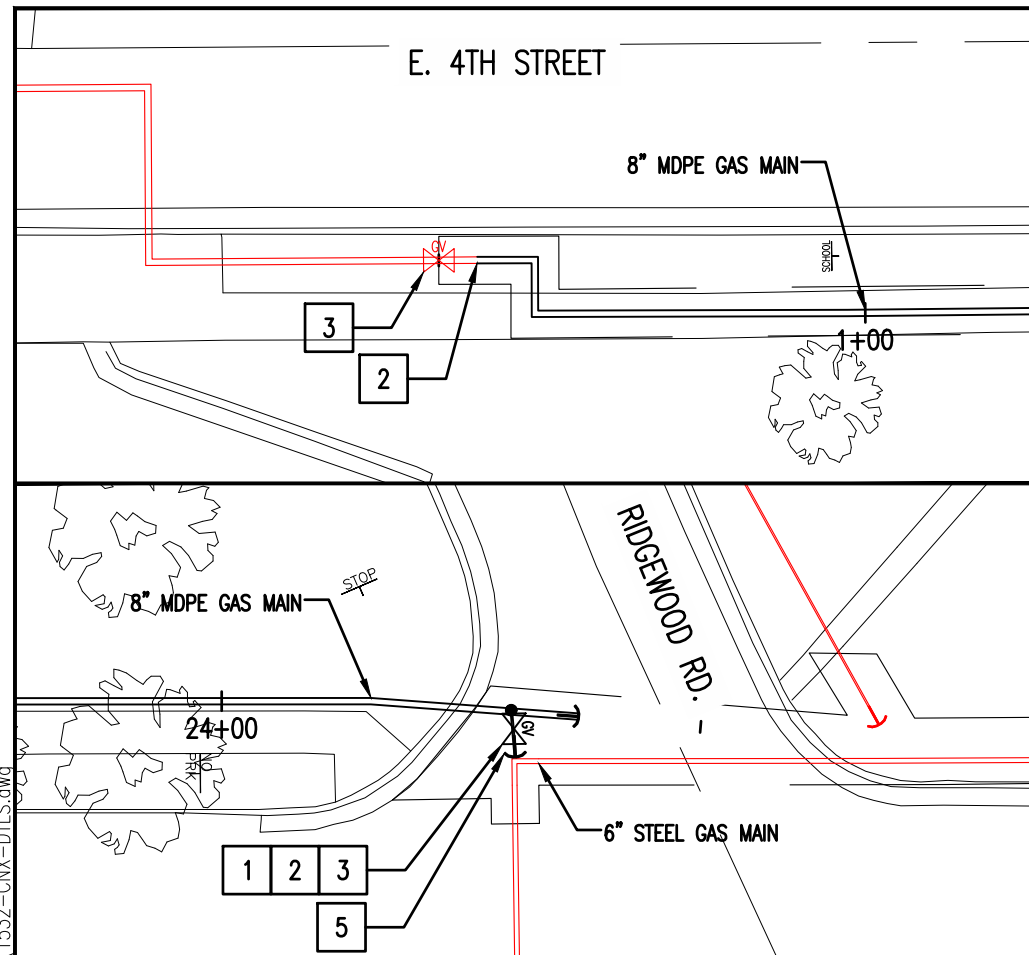
[illegible][illegible][illegible]

I HEREBY CERTIFY THAT THIS PLAN WAS PREPARED BY ME OR UNDER MY DIRECT SUPERVISION AND THAT I AM A DULY LICENSED PROFESSIONAL ENGINEER UNDER THE LAWS OF THE STATE OF MINNESOTA.

SIGNATURE: Howard Smith, P.E.

HOWARD D. SMITH, P.E.
TYPE NAME

DATE: 03/27/2017

LIC. NO: 46875



CITY OF DULUTH
ENGINEERING DIVISION
411 W. 1ST ST. STE. 211
DULUTH, MN 55802

2017 LARGE DIAMETER GAS MAIN INSTALATION PROJECTS

CITY PROJECT NO.: 1532

STATE AID PROJECT NO.: NA

DRAWN BY: J.R.L.

4TH ST. PROCEDURES

SHEET NO. 60 OF 63

I:\PWU\ENGINEER\PROJECTS\1500-1999\1532-48th Ave. E. Gas Main\23-ACAD-DRAWINGS\4TH ST. WALACE TO 34TH\1532-CNX-DTLC.dwg

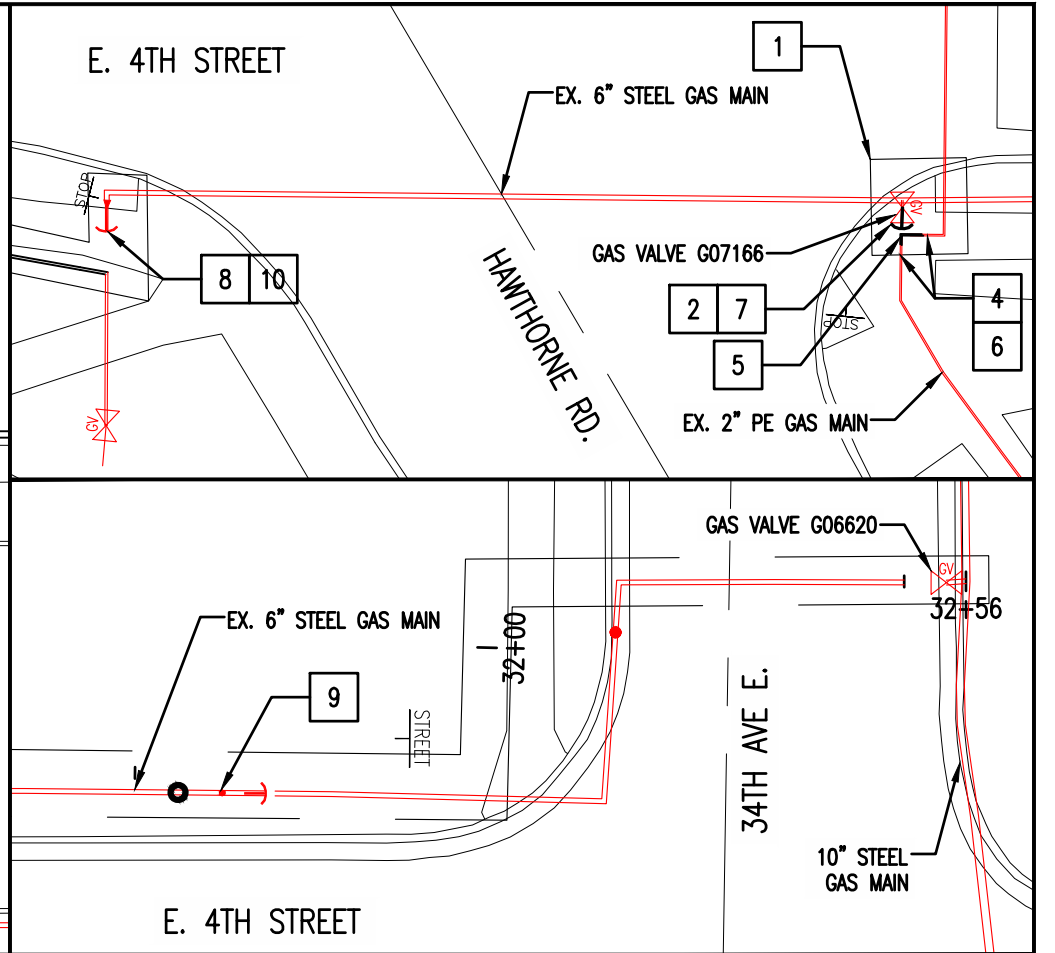
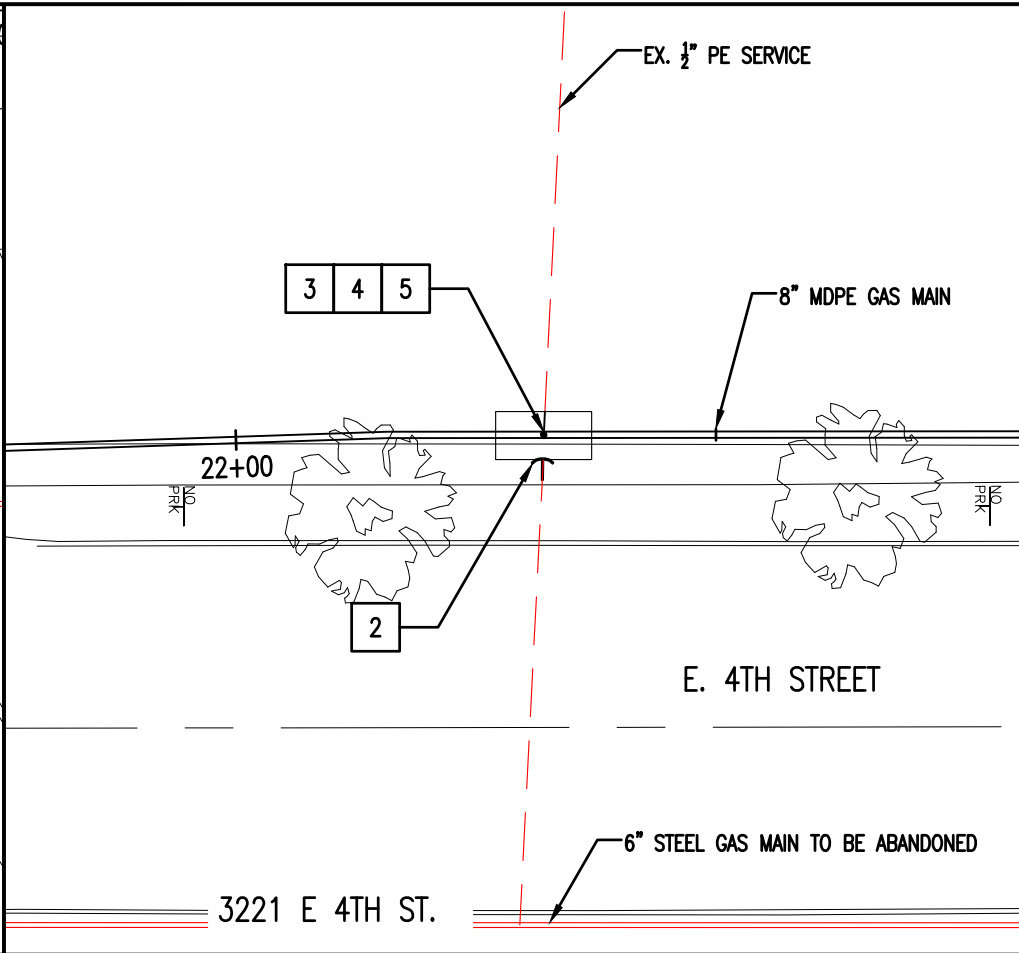
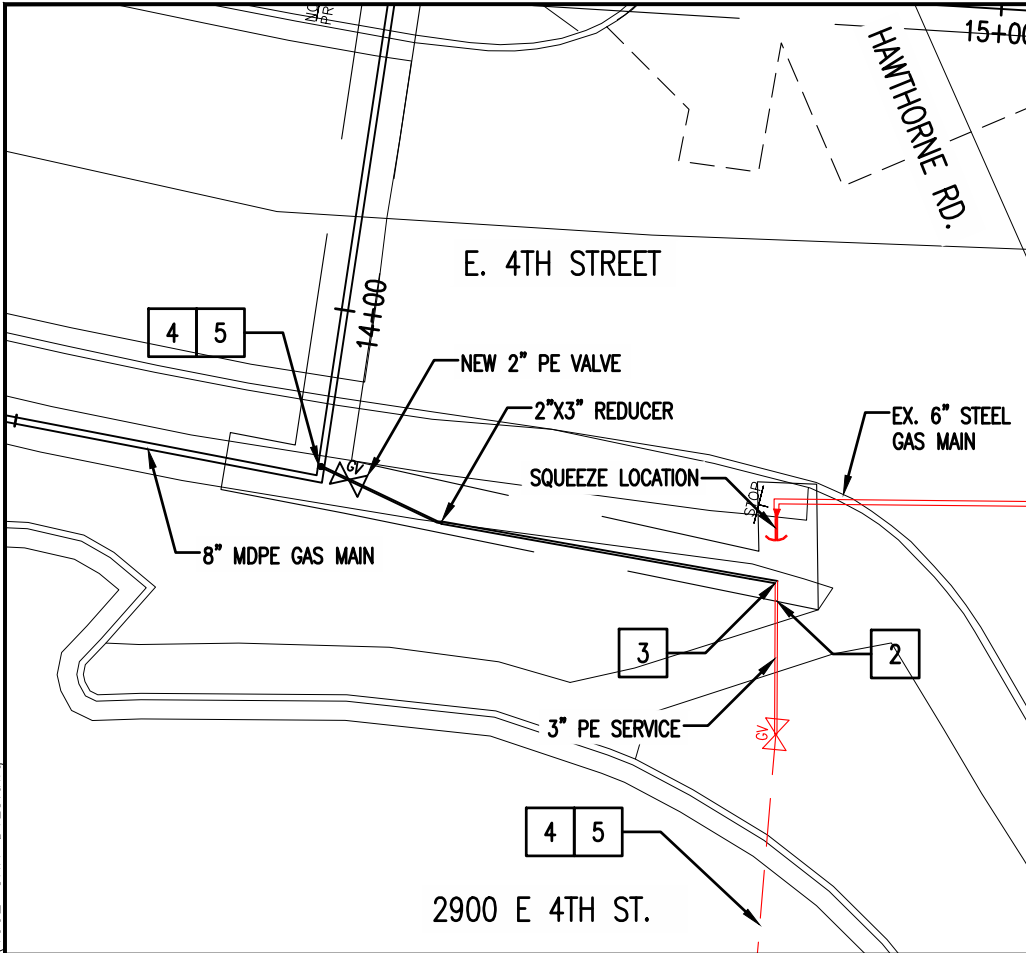

PROCEDURE #7			
	CONT.	C.O.D.	RECONNECT 3" MAIN FOR 2900 E. 4TH STREET SERVICE
INSTALLED IN PROCEDURE 2			
1		X	COORDINATE WITH SERVICE DEPARTMENT AND SCHOOL FOR SHUTDOWN AND RE-LIGHT
2	X		SQUEEZE EXISTING 3" PE MAIN AT SW CORNER OF HAWTHORNE AND 4TH STREET, DEPRESSURIZE AT THE SERVICE RISER, CUT AND CAP MAIN TOWARDS 4TH STREET, REMOVE SQUEEZE
3	X		RECONNECT EXISTING 3" MAIN TO NEW 3" MDPE PREVIOUSLY INSTALLED
4	X		TEST 3" MAIN FROM SERVICE RISER TO THE H.V. TEE
5		X	TAP H.V. TAP TEE FOR MAIN TO 2900 E. 4TH STREET AND USING THE 2" NEW VALVE, PURGE AIR TO GAS THROUGH EXISTING SERVICE RISER.
			SOAP TEST ALL CONNECTIONS

PROCEDURE #8			
	CONT.	C.O.D.	RECONNECT 3221 E. 4TH ST. GAS SERVICE TO NEW MAIN
1		X	COORDINATE WITH SERVICE DEPARTMENT FOR SHUTDOWN AND RE-LIGHT
2	X		SQUEEZE EXISTING 1/2" SERVICE AND CAP END TOWARDS THE EXISTING STEEL MAIN
3	X		INSTALL 8"X 1/2" TAP TEE WITH AN EFV AND RECONNECT TO THE EXISTING SERVICE
4	X		TEST EXISTING SERVICE AND NEW TAP TEE
5	X		TAP 1/2" TEE FOR SERVICE TO 3221 E. 4TH STREET, PURGE AIR TO GAS THROUGH EXISTING SERVICE RISER.

PROCEDURE #9			
	CONT.	C.O.D.	DISCONNECT AND ABANDON 6" STEEL MAIN
1	X		EXCAVATE AT VALVE G07166 AND EXPOSE 2" PE SOUTH TO BRANCH MAIN CONNECTION, THEN EXPOSE BEYOND BRANCH TEE 5' FOR SQUEEZE
2	X		CLOSE VALVE G07166
3		X	CONFIRM VALVES G02650, G01809, (RIDGEWOOD) AND G06620 (34TH AVE E.) ARE CLOSED AND BRANCH MAIN CONNECTS BEYOND THOSE VALVES HAVE BEEN PREVIOUSLY DISCONNECTED AND CAPED BY THE CITY.
4	X		INSTALL TWO SQUEEZES, CUT AND ROMOVE BRANCH TEE CONNECTION
5	X		INSTALL PRETESTED 2" P.E. MAIN WITH A 90° BEND TO CONNECT THE SOUTHERLY PIPE WITH THE EASTERLY PIPE
6	X		REMOVE SQUEEZES AND MARK LOCATION. SOAP TEST NEW CONNECTIONS
7		X	INSTALL PURGE STACK ON VALVE G07166, AND OPEN VALVE TO DEPRESSURISE THE 6" STEEL MAIN, CLOSE VALVE G07166 AND INSTALL BLIND FLANGE TO ABANDON
8	X	X	CUT OFF 3" CAP FROM EXISTING PE MAIN AND INSTALL PURGE STACK
9	X	X	AT STATION 31+55 INSTALL AN AIR MOVER ON THE EXISTING DRILL NIPPLE NEAR THE EXISTING 6" STOP FITTING. (PREVIOUSLY EXPOSED BY C.O.D.)
10	X	X	PURGE GAS TO AIR IN THE 6" STEEL GAS MAIN, WHEN COMPLETELY PURGED RE-INSTALL 3" PE CAP FOR ABANDONMENT PURPOSES ON THE WEST END OF THE PIPE.

I HEREBY CERTIFY THAT THIS PLAN WAS PREPARED BY ME OR UNDER MY DIRECT SUPERVISION AND THAT I AM A DULY LICENSED PROFESSIONAL ENGINEER UNDER THE LAWS OF THE STATE OF MINNESOTA.

SIGNATURE: Howard D. Smith, P.E.

HOWARD D. SMITH, P.E.
TYPE NAME

DATE: 03/27/2017

LIC. NO: 46875



CITY OF DULUTH
ENGINEERING DIVISION
411 W. 1ST ST. STE. 211
DULUTH, MN 55802

2017 LARGE DIAMETER GAS MAIN INSTALATION PROJECTS

CITY PROJECT NO.: 1532

STATE AID PROJECT NO.: NA

DRAWN BY: J.R.L.

4TH ST PROCEDURES

SHEET NO. 61 OF 63

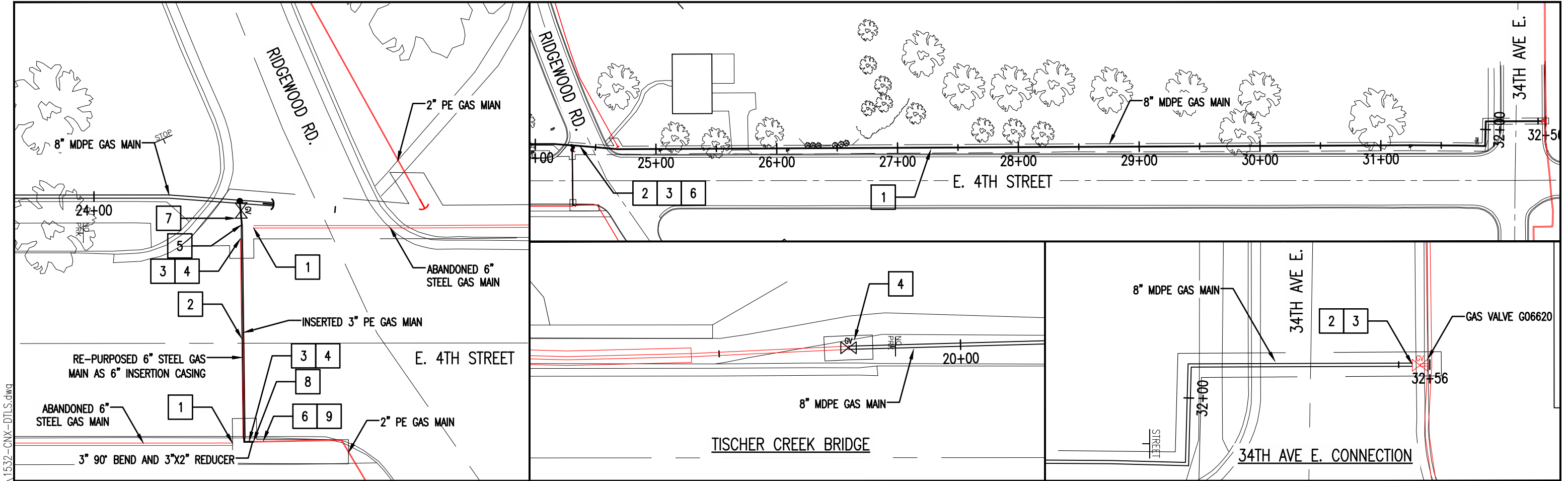

PROCEDURE #10			
	CONT.	C.O.D.	INSTALL SOUTHERLY RIDGEWOOD DRIVE MAIN EXTENTION
1	X		AT STATION 24+30 CUT AND REMOVE THE 90 DEGREE BENDS FROM THE ABANDONED 6" STEEL ON THE NORTH AND SOUTH SIDES OF 4TH STREET
2	X		INSPECT AND CLEAN IF NECESSARY THE ABANDONED 6" STEEL MAIN TO BE REPURPOSED AS AN INSERTION CASING
3	X		INSTALL 3" PE MAIN AND 90° BENDS AS PER PLAN FROM THE NORTH SIDE OF 4TH STREET, THROUGH THE INSERTION CASING, AND EAST ALONG 4TH STREET TO THE RIDGEWOOD ROAD CONNECTION LOCATION
4	X		PIG AND TEST NEW 3"
5	X		WITH A 3"x2" REDUCER, CONNECT THE NEW 3" MAIN TO THE 2" PE VALVE AT STATION 24+30 (PRE TESTED 2" PE MAIN MAY BE NEEDED)
6	X		SQUEEZE EXISTING 2" RIDGEWOOD ROAD MAIN BEYOND DEAD-END CAP (INSTALLED PREVIOUSLY BY CITY), REMOVE CAP
7	X		OPEN NEW 2" VALVE AT STA. 24+30 AND PURGE AIR TO GAS THROUGH NEWLY INSTALLED 3" MAIN, CLOSE VALVE
8	X		CONNECT TO SOUTHERLY RIDGEWOOD ROAD MAIN, OPEN VALVE AT STA 24+30 AND SOAP TEST CONNECTION, CLOSED VALVE
9	X		REMOVE SQUEEZE FROM RIDGEWOOD ROAD 2" MAIN
			SOAP TEST ALL CONNECTIONS
			VALVE CLOSED FOR PROC. #12

PROCEDURE #11			
	CONT.	C.O.D.	INSTALL MAIN FROM STA. 24+25 TO END AND MAKE CONNECT
1	X		REMOVE DECOMMISSIONED 6" STEEL GAS MAIN AND INSTALL NEW 8" MDPE GAS MAIN IN THE SAME TRENCH FROM STA. 24+35 TO 32+50
2	X		PIG AND TEST MAIN FROM STA. 24+35 TO 32+50
3	X		INSTALL END CAPS
4		X	NOTIFY 3221 E. SUPERIOR OF SHUTDOWN AND CLOSE THE NEW 8" PE VALVE AT STATION 19+75 AND THE 2" BRANCH MAIN VALVE AT STATION 24+30
5	X		DEPRESSURIZE MAIN FROM SERVICE RISER AT 3221 E 4TH STREET
6	X		REMOVE END CAP FROM THE ACTIVE 8" MDPE MAIN AT STATION 24+35 AND CONNECTION THE 8" MAIN TOGETHER, LEAVE EXPOSED FOR FUTURE SOAP TESTING

