

Addendum to Duluth Airport RFP # 17-4401

1. The RFP clearly states "janitorial and building maintenance" as reflected in tasks listed in Attachment #1. Is it your preference to have the Crew Leader be responsible for the various maintenance items in Attachment #1, or is it possible for maintenance, landscape and snow be subcontracted?
 - a. It is the preference of the Duluth Airport Authority that the Crew Leader be responsible for the various maintenance items in Attachment #1.
2. What is floor surface of restrooms?
 - a. Tile
3. Please confirm RFP response requires crew coverage 5:00 a.m. through 10:00 p.m. seven (7) days per week and Crew Leader only Monday through Friday.
 - a. The minimum coverage is based on flight schedule, the current target times are 5:00 a.m. through 10:00 p.m. Monday-Friday and 7:00 am through 7:00 pm Saturday-Sunday. The Crew Leader's typical shift is Monday through Friday and an alternate or fill-in for the weekend.
4. Please confirm equipment noted in Section IV.11 means any and all equipment not identified as Airport responsibility in Section V.2 is the full responsibility of contractor to provide.
 - a. Any and all equipment not identified as Airport responsibility in section V.2 is the full responsibility of the contractor to provide.
5. Is Non Standard Work as listed additional invoiced tasks?
 - a. Non Standard work will be conducted by the crew leader, if additional hours beyond the contract are required those hours would be invoiced.
6. Please identify current Airport approved floor finish system and if current system meets Airport Authority expectations.
 - a. Terra Glaze Acrylic Floor Seal
7. The RFP does not mention subcontracting. Is subcontracting allowed for janitorial work when closely managed by successful contractor?
 - a. Subcontracting is possible; specifically subcontractors can be used for project work. Beyond that subcontracting would need to be discussed during the contract phase.
8. Can a subcontractor be programmed into contract to perform specialized "Project Work" items?
 - a. See #7.

1st Floor

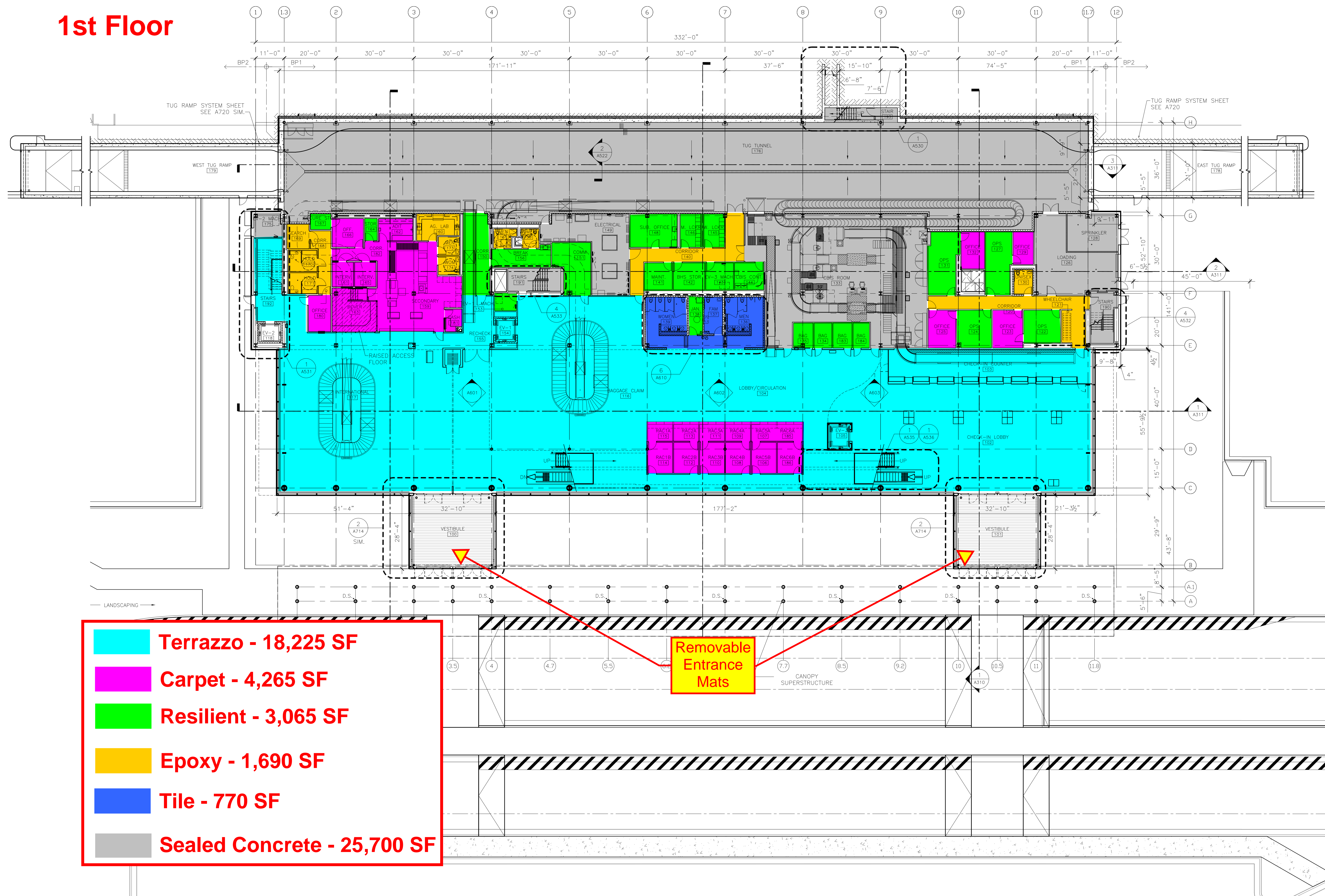

This document is to be used as supplemental information. Quantities and flooring type to be field verified by bidding contractor

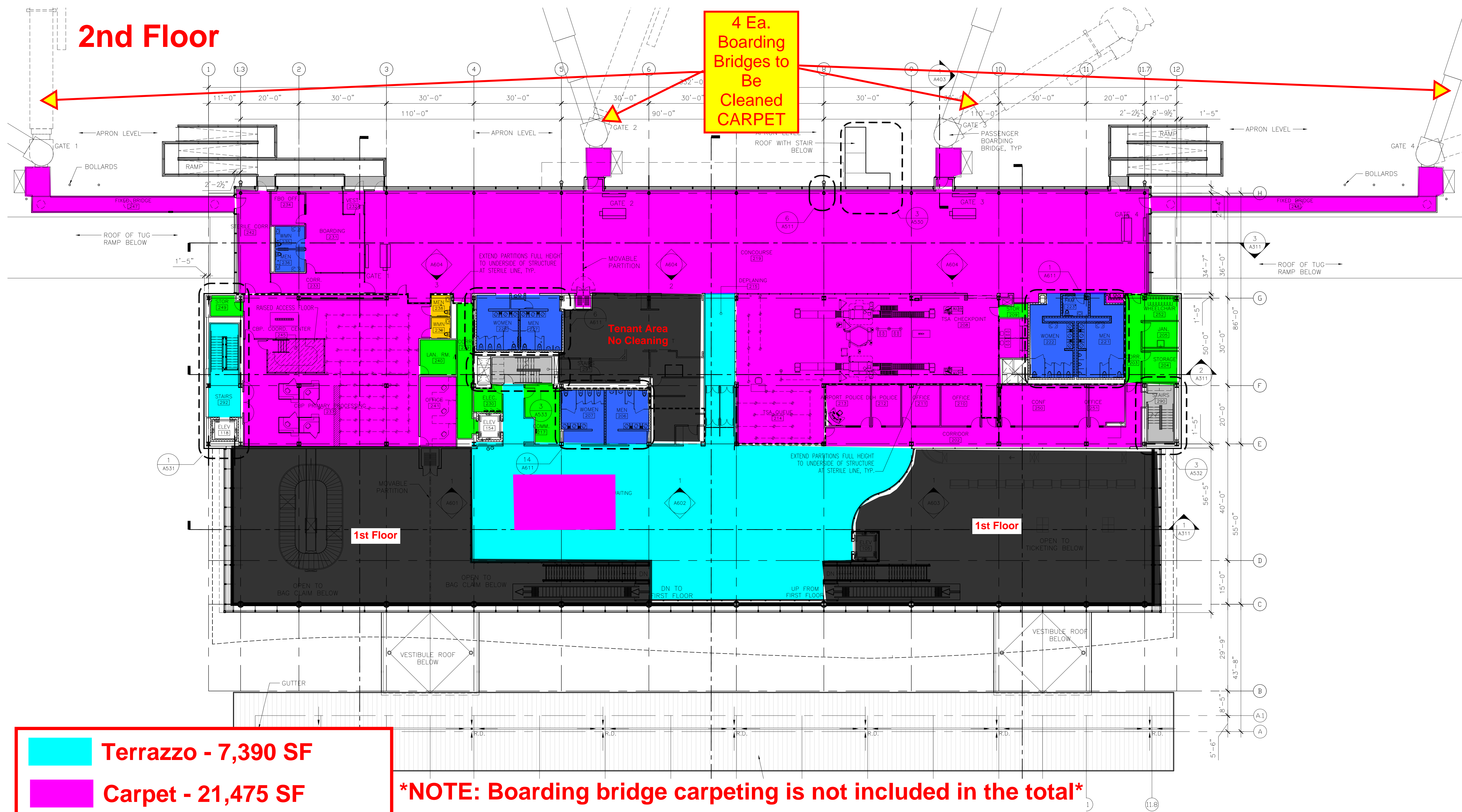

This document is to be used as supplemental information. Quantities and flooring type to be field verified by bidding contractor

3rd Floor

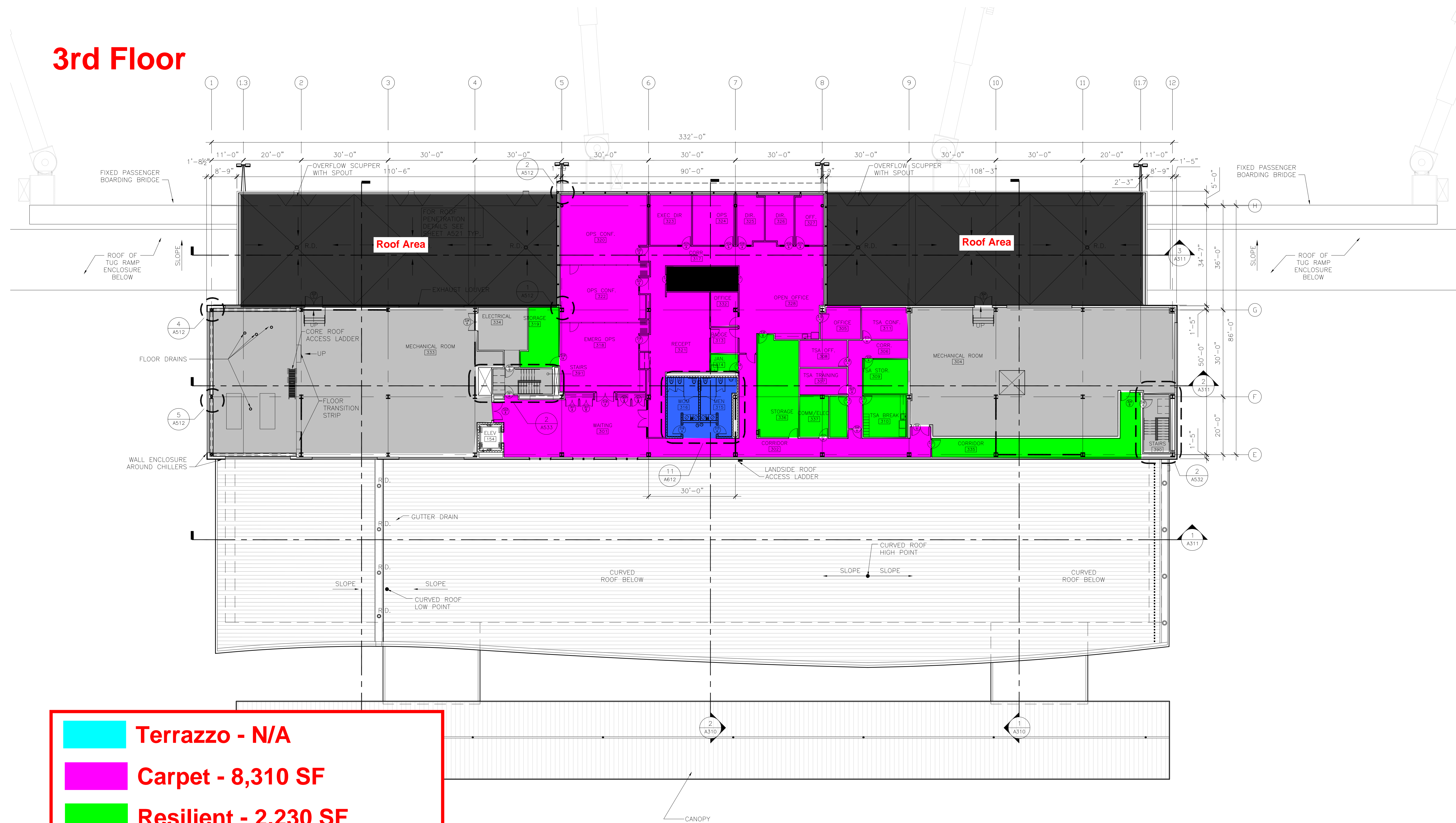

This document is to be used as supplemental information. Quantities and flooring type to be field verified by bidding contractor

**DULUTH INTERNATIONAL AIRPORT
AIRLINE FLIGHT SCHEDULE JANUARY 2017**

GATE	ARRIVALS				TIME	DEPARTURES			
	AIRLINE	FLIGHT	EQPT.	FROM		TO	AIRLINE	FLIGHT	EQPT.
		RON			0500	MSP	9E	4029	CM9
		RON			0625	ORD	UA	5099	CRJ
	UA	5030	CRJ	ORD	1047				
	OO	4496	RJS	MSP	1110				
					1116	ORD	UA	5127	CRJ
					1135	MSP	OO	4496	RJS
	UA	5168	CRJ	ORD	1404				
					1435	ORD	UA	5167	CRJ
	OO	4814	RJS	MSP X 6	1435				
					1500	MSP X 6	OO	4587	RJS
	OO	4678	RJS	MSP X 6	1640				
					1715	MSP X 6	OO	4465	RJS
	UA	5142	CRJ	ORD	2239	RON			
	9E	4159	CM0	MSP	2328	RON			

1 = MONDAY 2 = TUESDAY

Delta

3 = WEDNESDAY 4 = THURSDAY

5 = FRIDAY 6 = SATURDAY 7 = SUNDAY

UNITED

RON = REST OVER NIGHT

Flight times may vary on certain days

Launch Flight Times and #'s Change Periodically