

DOCUMENT 00 00 14

**ADDENDUM NO. 4
JUNE 16, 2023**

**2023 CONSTRUCT SRE BUILDING
AIP No. 3-27-0025-19-2023
CITY OF DULUTH NO. 23-4402
SKY HARBOR AIRPORT
DULUTH, MN**

SEH No. DULAI 167772

From: Short Elliott Hendrickson Inc.
3535 Vadnais Center Drive
St. Paul, MN 55110-3507
651.490.2000

To: Document Holders

DOCUMENT HOLDERS on the above-named project are hereby notified that this document shall be appended to, take precedence over and become part of the original bidding documents dated May 10, 2023 and Addenda dated May 22, 2023, May 31, 2023, and June 2, 2023, for this work. Bids submitted for the construction of this work shall conform to this document.

This addendum consists of 1 page and Section 00 01 10 Table of Contents (6 pages), Section 01 71 23 Field Engineering (2 pages), Section 32 92 00 Stabilized Turf Establishment (4 pages) and Drawings G2.01 and C2.00.

Changes to Introductory Information:

1. Section 00 01 10 Table of Contents, DELETE in its entirety and REPLACE with attached specification.

Changes to Specifications:

2. Section 01 71 23 Field Engineering, DELETE in its entirety and REPLACE with attached specification.
3. Section 32 92 00 Stabilized Turf Establishment, DELETE in its entirety and REPLACE with attached specification.

Changes to Plan Drawings:

4. Drawing G2.01 – General Notes and Statement of Estimated Quantities, DELETE in its entirety and REPLACE with attached drawing.
 1. Updated quantities and SEQ notes.
5. Drawing C2.00 – Grading Plan, DELETE in its entirety and REPLACE with attached drawing.
 1. Clarified estimated retaining wall height.

Note: Receipt of this Addendum No. 4, dated June 16, 2023, shall be acknowledged on [Bid Express](#). Failure to do so will not allow Bidder to submit Bid.

END OF ADDENDUM

TABLE OF CONTENTS

Number	Document
Volume 1	
Introductory Information	
00 01 01	Title Page
00 01 05	Certification
00 01 08	Project Directory
00 01 10	Table of Contents
Bidding Requirements	
00 11 13	Advertisement for Bids
00 21 13	Instructions to Bidders
00 31 32	Geotechnical Data
00 41 00	Bid Form
00 43 00	Bid Bond
00 43 37	List of Proposed Suppliers
00 45 19	Affidavit of Non-Collusion
00 45 45	Verification of Compliance with Minnesota Statutes 16C.285
00 45 47	Certification of Compliance
00 45 49	Buy American Certificate for Total Facility
00 46 00	Demonstration of Good Faith DBE Efforts
Contract Forms	
00 51 00	Notice of Award
00 52 00	Standard Form of Agreement
00 55 00	Notice to Proceed
00 61 13	Performance Bond
00 61 14	Payment Bond
FAA General Provisions	
Section 10	Definitions and Terms
Section 20	Proposal Requirements and Conditions
Section 30	Award and Execution of Contract
Section 40	Scope of Work
Section 50	Control of Work
Section 60	Control of Materials
Section 70	Legal Regulations and Responsibility to Public
Section 80	Execution and Progress
Section 90	Measurement and Payment
Conditions of the Contract	
00 72 00	Standard General Conditions
00 73 00	Supplementary Conditions
00 73 30	Additional Special Provisions for Federally-Funded Contracts
00 73 45	Minnesota Labor and Wage Rate Requirements
DIVISION 1 - GENERAL REQUIREMENTS	
Summary	
01 11 00	Summary of Work
01 23 00	Alternates

01 25 13	Price and Payment Procedures
01 26 00	Product Substitution Procedures Contract Modification Procedures
01 31 13	Administrative Requirements
01 31 19	Coordination
01 33 00	Project Meetings Submittal Procedures
01 42 15	Quality Requirements
01 42 19	Specification Format, Definitions and Abbreviations
01 45 10	Reference Standards for Building Construction Quality Control for Building Construction
01 51 36	Temporary Facilities and Controls
01 55 15	Temporary Water
01 57 33	Maintenance and Restoration of Haul Roads Application of Water for Dust Control
01 60 00	Product Requirements Product Requirements
01 71 23	Execution and Closeout Requirements
01 78 23	Field Engineering
01 78 37	Operation and Maintenance Data Product Warranties

DIVISION 2 - EXISTING CONDITIONS

02 41 33	Demolition and Structure Moving Removing Pavement and Miscellaneous Structures
----------	--

DIVISION 3 - CONCRETE

03 11 00	Maintenance of Concrete
03 20 00	Concrete Forming Concrete Reinforcing
03 30 00	Cast-in-Place Concrete Cast-in-Place Concrete

DIVISION 7 - THERMAL AND MOISTURE PROTECTION

07 21 00	Thermal Protection
07 29 13	Thermal Insulation Pre-Engineered Building Insulation
07 92 00	Sealant Joint Sealant

DIVISION 8 - OPENINGS

08 11 13	Doors and Frames Hollow Metal Doors and Frames (Commercial)
08 36 13	Specialty Doors and Frames Sectional Steel Overhead Doors
08 51 13	Windows Aluminum Windows

08 71 00 **Hardware**
Door Hardware

08 80 00 **Glazing**
Glazing

DIVISION 9 - FINISHES

09 91 00 **Painting and Coating**
Painting
09 29 00 Gypsum Board

DIVISION 10 - SPECIALTIES

10 14 19 **Information Specialties**
Dimensional Letter Signage and Plaques

10 44 00 **Interior Specialties**
Safety Specialties

DIVISION 13 - SPECIAL CONSTRUCTION

13 34 00 **Special Structures**
Fabricated Engineered Structures

DIVISION 22 – MECHANICAL

22 05 00 Basic Mechanical Requirements for Plumbing
22 05 10 Mechanical Related Work for Plumbing
22 05 12 Plumbing Pipes and Pipe Fittings
22 05 13 Electrical Provisions of Mechanical Work for Plumbing
22 05 19 Meters and Gages for Plumbing
22 05 23 Plumbing Valves
22 05 29 Hangers and Supports for Plumbing
22 07 00 Mechanical Insulation for Plumbing
22 11 16 Domestic Water Piping
22 11 19 Piping Specialties for Plumbing
22 13 16 Sanitary Waste and Vent Piping
22 33 00 Water Heaters
22 40 00 Plumbing Fixtures
23 05 00 Basic Mechanical Requirements for HVAC
23 05 10 Mechanical Related Work for HVAC
23 05 12 HVAC Pipes and Pipe Fittings
23 05 13 Electrical Provisions of Mechanical Work for HVAC
23 05 19 Meters and Gages for HVAC
23 05 23 HVAC Valves
23 05 29 Hangers and Supports for HVAC
23 05 93 Testing, Adjusting and Balancing for HVAC
23 07 00 Mechanical Insulation for HVAC
23 09 93 Sequence of Operation for HVAC Controls
23 11 19 Piping Specialties for HVAC
23 11 26 Gas System
23 21 13 Hydronic Piping
23 21 23 Hydronic Pumps
23 31 13 Metals Ducts
23 33 00 Air Ductwork Accessories
23 34 23 HVAC Power Ventilators
23 37 13 Diffusers, Registers and Grillers
23 52 23 Boilers
23 55 10 Fuel Fired Heaters
23 83 16 Radiant Floor Heating Systems

VOLUME 2

DIVISION 26 – ELECTRICAL

26 00 00	Electrical General
26 00 10	Electrical Provisions for Mechanical Work
26 05 00	Common Work Results for Electrical
26 05 19	Medium Voltage Cables
26 05 26	Grounding and Bonding for Electrical Systems
26 05 29	Hangers and Supports for Electrical Systems
26 05 33	Conduits and Raceways
26 05 34	Raceways and Boxes for Electrical Systems
26 05 53	Identification for Electrical Systems
26 24 12	Service and Distribution
26 24 16	Panelboards
26 27 26	Wirings Devices
26 28 16	Enclosed Switches and Circuit Breakers
26 29 13	Enclosed Controllers
26 51 00	Interior Lighting

DIVISION 31 - EARTHWORK

	Earth Moving
31 22 10	Site Grading
31 22 20	Earthwork for Building Sites
31 23 33	Trench Excavation and Backfill
31 25 10	Stormwater Management
	Earthwork Methods
31 34 10	Geosynthetic Installation
31 41 40	Structural Shoring

DIVISION 32 - EXTERIOR IMPROVEMENTS

	Bases, Ballasts, and Paving
	Base Courses
32 11 22	Aggregate Base
	Flexible Paving
32 12 13	Bituminous Tack Coat
32 12 16	Plant-Mixed Asphalt Pavement
	Paving Specialties
32 18 20	Walks
	Landscaping
32 92 00	Stabilized Turf Establishment

DIVISION 33 - UTILITIES

	Sanitary Sewage Utilities
33 36 10	Septic Systems

FAA TECHNICAL SPECIFICATIONS

	Part 2 – General Construction Items
Item C-105	Mobilization
	Part 3 – Site Work
Item P-152	Excavation, Subgrade, and Embankment

Item L-115

Part 13 – Lighting Installation
Electrical Manholes and Junction Structures

Item T-901
Item T-905

Part 14 – Turf Establishment
Seeding
Topsoil

APPENDIX A

Geotechnical Exploration Report

APPENDIX B

Prevailing Wage Rates

APPENDIX C

Equal Employment Opportunity Special Provisions (EEO)

APPENDIX D

Certification of Exemption, Form ST3

APPENDIX E

Direct Deposit

APPENDIX F

Subsurface Septic Treatment System Forms – St. Louis County, MN

APPENDIX G

City of Duluth Construction Standard Specifications

APPENDIX H

Safety Plan and Compliance Narrative (SPCN)

APPENDIX I

MnDOT DBE Special Provision

This Page Left Blank Intentionally

SECTION 01 71 23
FIELD ENGINEERING

PART 1 GENERAL

1.01 SUMMARY

- A. Section Includes:
 - 1. Field engineering provided by Contractor.
 - 2. Horizontal and vertical control points (By Engineer)
 - 3. Construction Staking (By Contractor)
 - 4. Quantity surveys and computations (By Contractor)
- B. Method of Measurement: All field engineering will be measured as shown on the Bid Form.
- C. Method of Payment: All field engineering will be paid as shown on the Bid Form.

1.02 SUBMITTALS

- A. Submit name and qualifications of surveyor that will perform Work.
- B. Submit log or other records of all survey Work completed.
- C. Submit copies of measurement and calculations for quantity surveys.

1.03 QUALITY ASSURANCE

- A. All Work in this Section shall be under the direction of a surveyor registered in the State in which the Project is located.

1.04 SITE CONDITIONS

- A. Engineer shall establish necessary horizontal and vertical control. Contractor shall provide the Engineer 3-working days' of notice for staking control on project.
- B. Engineer will provide the Contractor with survey files for verification purposes (upon execution of the CAD Release of Liability Form – to be provided by Engineer)
- C. Benchmarks and control points are identified on the Drawings.

PART 2 PRODUCTS

Not Used

PART 3 EXECUTION

3.01 EXAMINATION

- A. Contractor shall verify locations of control points prior to start of Work and notify Engineer in writing that Contractor concurs with the control points.
- B. Contractor shall relate information given on the Drawings to existing Site conditions.
- C. Contractor shall promptly advise Engineer of any discrepancies.

3.02 PREPARATION

- A. Contractor shall protect and preserve all benchmarks and control points. In case of negligence on the part of the Contractor or their employees, resulting in the destruction of any horizontal and vertical control, the resulting costs will be deducted as a liquidated damage against the Contractor.
- B. Advise Engineer of the required relocation of any reference points due to grade changes or other reasons.
- C. Replace dislocated reference points based on original survey control.

3.03 SURVEY REQUIREMENTS

- A. Construction Staking (by Contractor):
 - 1. Establish locations, layouts, lines and elevations by instrumentation and similar methods for the project.
 - 2. Tolerances:
 - a. Horizontal Distances: 1/7500
 - b. Horizontal Angles: 0 degrees - 00 minutes - 00 feet - 01 inches
 - c. Elevation:
 $0.050ft.x\sqrt{length (miles)}$
 - 3. Maintain log or record book indicating all Work completed for review and submittal.
 - 4. Laser, GPS, string line, or other automatic control shall be checked with temporary control as necessary. In the case of error, on the part of the Contractor, their surveyor, employees or subcontractors, resulting in established grades, alignment or grade tolerances that do not concur with those specified or shown on the plans, the Contractor is solely responsible for correction, removal, replacement and all associated costs at no additional cost to the Owner.
- B. Quantity Surveys (By Contractor):
 - 1. Perform surveys of the area specified below to determine final quantities for the project:
 - a. Subgrade Elevations (Common & Borrow Excavation, Structure Excavation, Structural Backfill)
 - b. Aggregate Base Course Elevations
 - c. Sidewalk, Retaining Wall and Pavement Boundaries.
 - 2. Excavation or field grading quantities outside of the grading limits shall be determined quantities from a topographic survey from before & after the work. The survey data shall be submitted to the engineer.
 - 3. Submit copies of all measurements and calculations to Engineer for review.
- C. As-Built Surveys (by Contractor):
 - 1. Perform final as-built survey of the site grading as well as capturing building corners, final floor elevations, pavement limits, concrete sidewalk, septic holding tank location, and utility service routes.
 - 2. Surveys shall include pipe sizes, lengths installed, and depths of pipes. Record accurate locations of services installed for this project.
 - 3. Provide Engineer with survey files in PDF, csv, and CAD format.
 - 4. As-Built Surveys completed by the Contractor will be used to verify Quantities installed, such as utility routes, silt fence, and other lineal footage items.
- D. Certification Surveys (by Contractor)
 - 1. Provide certification survey of existing conditions prior to construction commencing. Survey shall incorporate lease area.
 - 2. Provide certification survey of the finished floor of the building. Certification shall be submitted to the City of Duluth.

END OF SECTION

SECTION 32 92 00

STABILIZED TURF ESTABLISHMENT

PART 1 GENERAL

1.01 SUMMARY

- A. Provide the following:
 - 1. Accessories including, but not limited to:
 - a. Weed barrier.
 - b. Edging.
 - c. Rock.
- B. Method of Measurement: Stabilized Turf Establishment: Measure by area in square feet.
- C. Basis of Payment:
 - 1. Payment for Stabilized Turf Establishment shall be at the Contract Unit Price as listed on the Bid Form. All associated Work items, shall be considered incidental.
 - 2. No separate payment will be made for supplying and placing edging.
 - 3. No separate payment will be made for supplying and placing weed barrier.
 - 4. No separate payment will be made for supplying and placing rock.

1.02 SUBMITTALS

- A. Refer to Section 01 33 00.
 - 1. Product Data:
 - a. For each type of product indicated.
- B. Provide with Product Data: Buy-American Certification and/or Build America, Buy America (BABA) for manufactured goods of products supplied, steel or iron products, if applicable.
- C. Qualification Data: For installer.

1.03 QUALITY ASSURANCE

- A. Qualifications:
 - 1. Installer: A qualified installer whose work has resulted in successful lawn establishment.
- B. Substitutions: Refer to Section 01 25 13.

1.04 DELIVERY, STORAGE, AND HANDLING

- A. Rock: Place in an area not to disruption construction or airfield operations.

1.05 PROJECT CONDITIONS

- A. Existing Conditions:
 - 1. Inspect the Project prior to installation.
 - 2. If conditions do not meet approval, notify Engineer.
 - 3. Proceeding without notification implies acceptance of conditions.

1.06 WARRANTY

- A. Warranty for a period of 1 year after date of substantial completion against defects, including death and unsatisfactory growth, except for defects resulting from neglect by Owner, abuse or damage by others, or unusual phenomena or incidents which are beyond installer's control.

PART 2 PRODUCTS

2.01 LANDSCAPE ACCESSORIES

- A. Rock:
 - 1. Rock shall be MN River Rock, Lake Superior River Rock or WI River Rock.
- B. Weed Barrier:
 - 1. 6-mil black polyethylene film **OR** Filtration/Separation Fabric: Water permeable filtration fabric of fiberglass or polypropylene fabric.
- C. Edging:
 - 1. 4" high edging.
 - 2. Edging shall be made of steel material.
 - 3. Anchors shall be provided to secure edging to ground, per the manufacture's recommendations.

PART 3 EXECUTION

3.01 PERMENANT TURF ESTABLISHMENT WORK

- A. Permanent Layout:
 - 1. Install the permanent turf establishment at the location shown on the Plans. Layout shall size and shape shall be coordinated with the Airport prior to installation.
- B. Weed Barrier:
 - 1. Lay film continuously over compacted subgrade prior to placing rock. Overlap edges 4 inches at joints between sheets. Secure to ground with nails to prevent rolling or movement when placing landscape rock.
- C. Edging:
 - 1. Install edging along the perimeter of the area prior to placement of rock.
 - 2. Edging shall be installed per the manufacturer's recommendations.
- D. Rock:
 - 1. Weed barrier must be placed prior to placing of rock.
 - 2. Install rock to a depth of 4-inches.

3.02 CLEANUP, MAINTENANCE, AND PROTECTION

- A. During work, keep pavements clean and work area in an orderly condition.
- B. Promptly remove soil and debris created by lawn work from paved areas.
- C. Clean wheels of vehicles before leaving site to avoid tracking soil onto roads, walks, or other paved areas.
- D. Disposal:
 - 1. Remove waste and foreign materials, including weeds, stones, soil cores, grass, vegetation, and sod and legally dispose of them off Owner's property.
 - 2. Divert from landfill disposal whenever possible.

3. Topsoil containing foreign materials resulting from Contractor's operations, including oil drippings, fuel spills, shall be disposed of legally.

3.03 INSPECTION AND ACCEPTANCE

- A. Inspection: When work is completed, including maintenance, Engineer will, upon request, inspect to determine acceptability.
- B. Rejected Work: When inspected work does not comply with requirements, replace rejected work and continue specified maintenance until reinspected by Engineer and found to be acceptable.

END OF SECTION

This Page Left Blank Intentionally

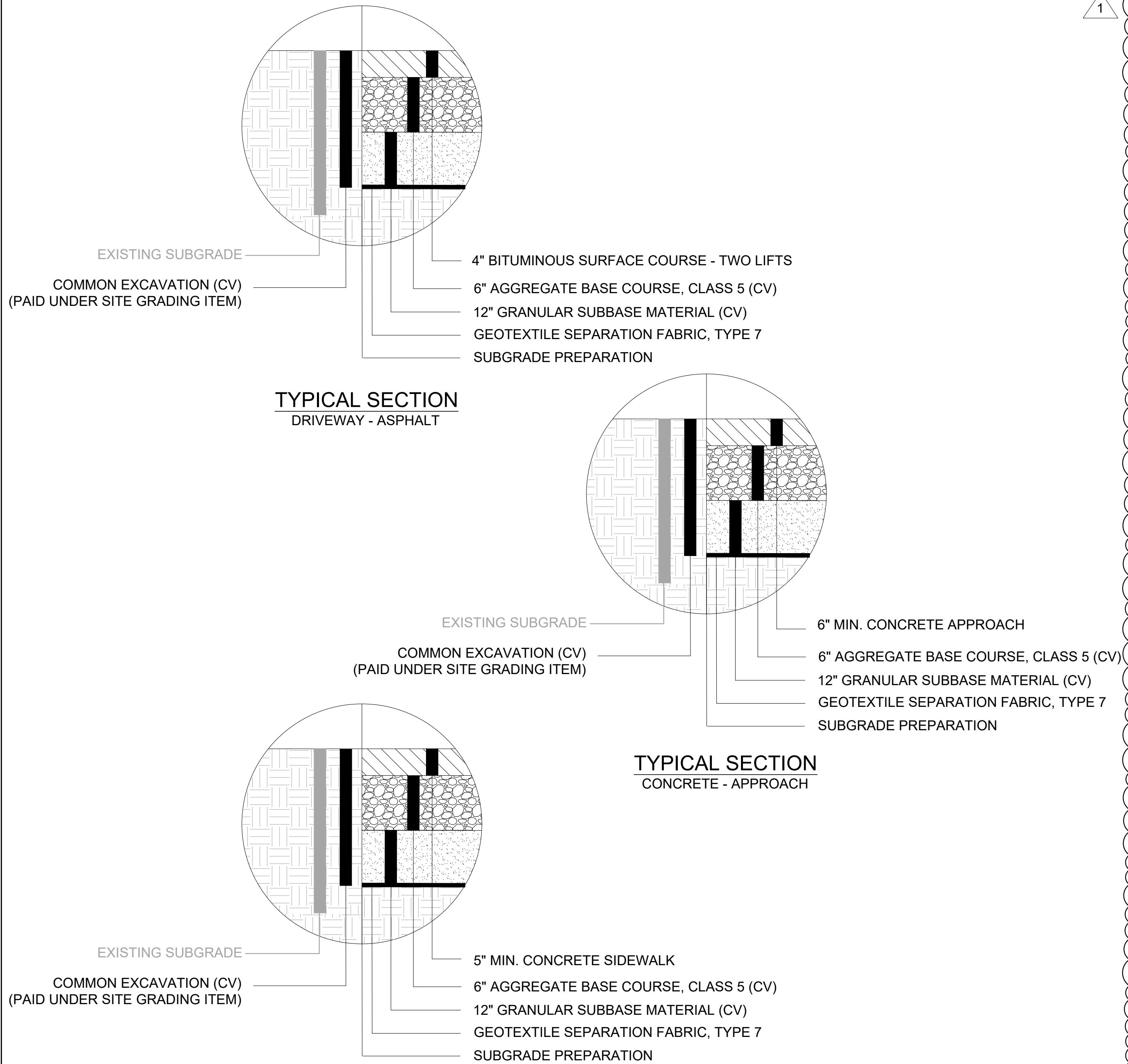

STATEMENT OF ESTIMATE QUANTITY NOTES:

ITEM NO. 1/39/47: THE TERM "GENERAL CONDITIONS" IS USED TO DESCRIBE EXPENSES THAT SUPPORT A PROJECT WITHOUT DIRECTLY RELATING TO JOBSITE ACTIVITIES, INCLUDING BUT NOT LIMITED TO SITE MANAGEMENT, PROJECT MANAGEMENT, COORDINATION OF EACH SCHEDULE AND PERMITTING WITH CITY OF DULUTH & ST. LOUIS COUNTY, SCHEDULING, ETC.

ITEM NO. 2/40/48: LIMITED TO 10% OF TOTAL PROJECT COSTS RELATED TO THE BID SCHEDULE.

ITEM NO. 3: INSTALLATION, MAINTENANCE AND REMOVAL OF ALL SIGNAGE, BARRICADES, AND TRAFFIC CONTROL DEVICES.

ITEM NO. 6: PROVIDING CONSTRUCTION SURVEY THROUGHOUT THE PROJECT, AS REQUIRED IN THE SPECIFICATIONS, AND CERTIFICATION OF ELEVATION OF THE BUILDING INCLUDING DOCUMENTING ELEVATIONS OF STRUCTURE EXCAVATION, STRUCTURAL FILL, SUBGRADE, BASE COURSE AND OTHER QUANTITY SURVEYS SUPPLIED TO THE ENGINEER FOR PAYMENT.

ITEM NO. 8/50: SALVAGING EXISTING BASE MATERIAL FOR REUSE.

ITEM NO. 10/51: GRADING THE BUILDING SITE TO PROPOSED CONDITIONS AND PLACING SALVAGED BASE MATERIAL PRIOR TO PAVING.

ITEM NO. 9: PROVIDING TEMPORARY SHORING TO AVOID ANY DISTURBANCE TO THE EXISTING FENCE LINE AND CONSTRUCTING PROJECT ELEMENTS.

ITEMS NO. 11/15/16: QUANTITIES ARE FOR THE HMA DRIVEWAY AND CONCRETE SECTIONS. OTHER MATERIALS SHALL BE INCLUDED IN ITEM NO. 24.

ITEM NO. 19: CONSTRUCTING SIDEWALK BETWEEN CONCRETE STOOP AND CONCRETE APPROACH OF THE BUILDING.

ITEM NO. 20: PROVIDING FOUNDATION DESIGN FOR THE PROJECT. FOUNDATION DESIGN MUST ACCOUNT FOR WET-FLOODPROOFING, AS STATED IN THE CODE REVIEW OF THE PLANS.

ITEM NO. 21: SUPPLYING AND INSTALLING BOLLARD SLIP COVER WITH REFLECTIVE BANDS.

ITEM NO. 24: CONSTRUCTING CONCRETE FOUNDATION, FOUNDATION WALLS, CONCRETE STOOPS, FLOOD VENTS AND CONCRETE APPROACH TO SRE BUILDING AND NECESSARY MATERIALS TO COMPLETE THE BUILDING AS SHOWN.

ITEM NO. 27: REMOVING EXISTING CONDUIT AND CIRCUIT OUTSIDE OF BUILDING FOOTPRINT, PROVIDING TEMPORARY POWER AS NECESSARY, COORDINATION WITH MNDOT & FAA TO MAKE AN OPERABLE SYSTEM.

ITEM NO. 28: SUPPLYING AND INSTALLING CONDUCTORS ASSOCIATED WITH RTR & AWOS TO COMPLETE OPERABLE SYSTEMS.

ITEM NO. 33: PROVIDING SEPTIC HOLDING TANK, CONNECTIONS, ST. LOUIS COUNTY PERMITTING, OVERFILL ALARM, EQUIPMENT AND ACCESSORIES TO MAKE AN OPERABLE SYSTEM.

ITEM NO. 34: PROVIDING ENGINEERING TO DESIGN THE RETAINING WALL.

ITEM NO. 35: PROVIDING 2-FT HIGH RETAINING WALL ALONG THE FENCE LINE AND MATCHING PROPOSED GRADES.

ITEM NO. 37/60: PROVIDING NECESSARY SEED, FERTILIZER, AND HYDRAULIC MULCH TO ESTABLISH TURF.

ITEM NO. 41/42: PROVIDING DOMESTIC WATER USE INSIDE THE SRE BUILDING, INCLUDING PLUMBING FIXTURES, HOSE BIB, PIPING, WATER HEATER, UTILITY SINK, EYE WASH, ETC.

ITEM NO. 43/44/45/46: PROVIDING WATER SERVICE AND CONNECTIONS TO THE SRE BUILDING.

ITEM NO. 53: PLACING SALVAGED BASE MATERIAL DURING BITUMINOUS PAVEMENT REMOVALS.

BASE BID SCHEDULE B: SCHEDULE IS TO PROVIDE DOMESTIC WATER USE FOR SRE BUILDING.
 BASE BID SCHEDULE C: SCHEDULE IS TO PROVIDE WATER MAIN EXTENSION THAT WILL PROVIDE SERVICE TO THE SRE BUILDING.

STATEMENT OF ESTIMATED QUANTITIES					
LINE NO.	ITEM NO.	ITEM DESCRIPTION	UNIT	ESTIMATED QUANTITY	FINAL QUANTITY
BASE BID SCHEDULE A - CONSTRUCT SRE BUILDING & SITE WORK (FAA ELIGIBLE)					
1	GENERAL	GENERAL CONDITIONS	LS	1	
2	C-105	MOBILIZATION (10% OF TOTAL SCHEDULE COST ALLOWED)	LS	1	
3	70-08	TRAFFIC PROVISIONS/AIRPORT SECURITY & DEVICES/PHASING	LS	1	
4	70-08	ORANGE CONSTRUCTION FENCE	LF	300	
5	01 55 15	MAINTENANCE AND RESTORATION OF AIRPORT HAUL ROUTES	LS	1	
6	01 71 23	FIELD ENGINEERING	LS	1	
7	02 41 33	SAWING BITUMINOUS PAVEMENT (FULL DEPTH)	LF	60	
8	02 41 33	REMOVING BITUMINOUS PAVEMENT (3 - 4" THICK)	SY	75	
9	31 41 40	STRUCTURAL SHORING (TEMPORARY)	LF	50	
10	31 22 10	SITE GRADING	LS	1	
11	31 22 10	GRANULAR SUBBASE MATERIAL (CV)	CY	65	
12	31 25 10	ROCK CONSTRUCTION ENTRANCE (INCLUDES MAINTENANCE AND REMOVAL)	EACH	1	
13	31 25 10	SILT FENCE, TYPE PRESASSEMBLED (INCLUDES MAINTENANCE AND REMOVAL)	LF	500	
14	31 25 10	SEDIMENT CONTROL LOG (INCLUDES MAINTENANCE AND REMOVAL)	LF	300	
15	31 34 10	GEOTEXTILE INSTALLATION, TYPE 7 (SEPARATION FABRIC)	SY	200	
16	32 11 22	AGGREGATE BASE, CLASS 5 (CV)	CY	35	
17	32 12 13	BITUMINOUS TACK COAT	GAL	15	
18	32 12 16	BITUMINOUS PAVEMENT (4" THICK - 2 LIFTS)	TON	50	
19	32 18 20	5-INCH CONCRETE SIDEWALK (5-FT WIDE)	SY	20	
20	1001	FOUNDATION ENGINEERING	LS	1	
21	1002	BOLLARDS (INCLUDING SLIP COVER W/ REFLECTIVE BANDS)	EACH	4	
22	31 22 20	STRUCTURE EXCAVATION, CLASS U (CV)	CY	500	
23	31 22 20	ENGINEERED STRUCTURAL BACKFILL (CV)	CY	500	
24	13 34 00	PRE-ENGINEERED METAL BUILDING CONSTRUCTION	LS	1	
25	MECH.	BUILDING MECHANICAL	LS	1	
26	ELEC.	BUILDING ELECTRICAL AND UTILITIES	LS	1	
27	ELEC.	ELECTRICAL DEMOLITION	LS	1	
28	ELEC.	FURNISH & INSTALL ELECTRICAL POWER CONDUIT FOR RTR & AWOS (INCLUDING CONDUCTORS)	LF	165	
29	L-115-5.1	FURNISH & INSTALL COMPOSITE HANDHOLES (L-867, 13"X 24"X 24")	EACH	2	
30	2504	SEWER TRACER BOX	EACH	1	
31	2504	4" PVC SANITARY SERVICE PIPE (SDR 35)	LF	50	
32	2504	4" PVC SANITARY CLEANOUT	EACH	1	
33	33 36 10	FURNISH & INSTALL 2,000-GALLON SEPTIC HOLDING TANK (INCLUDING EQUIPMENT)	LS	1	
34	3001	RETAINING WALL ENGINEERING	LS	1	
35	3002	PREFABRICATED MODULAR GRAVITY BLOCK WALL	SF	200	
36	32 90 00	STABILIZED TURF ESTABLISHMENT (INCLUDES ROCK, FABRIC, AND EDGING)	SF	100	
37	T-901-5.1	TURF ESTABLISHMENT (INCLUDES FERTILIZER, SEED, MULCHING AND STABILIZATION)	LS	1	
38	T-905-5.1	SELECT TOPSOIL BORROW (SALVAGED) (CV)	CY	150	
BASE BID SCHEDULE B - CONSTRUCT BUILDING PLUMBING AND ASSOCIATED FIXTURES (FAA ELIGIBLE)					
39	GENERAL	GENERAL CONDITIONS	LS	1	
40	C-105	MOBILIZATION (10% OF TOTAL SCHEDULE COST ALLOWED)	LS	1	
41	MECH.	BUILDING PLUMBING	LS	1	
42	MECH.	PLUMBING FIXTURES (EYE WASH, UTILITY SINK, HOSE BIBS AND ASSOCIATED PIPING AND CONNECTIONS TO THESE ITEMS)	LS	1	
43	2504.602	8" x 1-1/2" TAPPING TEE W/ ELECTROFUSION SADDLE	EACH	1	
44	2504.602	1-1/2" CURB STOP AND BOX	EACH	1	
45	2504.602	WATER TRACER BOX	EACH	1	
46	2504.603	1-1/2" HDPE SDR 11 SERVICE PIPE	LF	40	
BASE BID SCHEDULE C - CONSTRUCT WATER MAIN EXTENSION (FAA INELIGIBLE)					
47	GENERAL	GENERAL CONDITIONS	LS	1	
48	C-105	MOBILIZATION (10% OF TOTAL SCHEDULE COST ALLOWED)	LS	1	
49	02 41 33	SAWING BITUMINOUS PAVEMENT (FULL DEPTH)	LF	70	
50	02 41 33	REMOVING BITUMINOUS PAVEMENT (3 - 4" THICK)	SY	50	
51	31 22 10	SITE GRADING	LS	1	
52	31 22 10	GRANULAR SUBBASE MATERIAL (CV)	CY	20	
53	32 11 22	AGGREGATE BASE, CLASS 5 (CV) (SALVAGED MATERIAL)	CY	15	
54	32 12 13	BITUMINOUS TACK COAT	GAL	5	
55	32 12 16	BITUMINOUS PAVEMENT (4" THICK - 2 LIFTS)	TON	20	
56	2504.602	CONNECT TO EXISTING WATER MAIN (INCLUDING D.I. FITTINGS)	EACH	1	
57	2504.602	8" GATE VALVE AND BOX (INCLUDING D.I. FITTINGS)	EACH	1	
58	2504.602	8" DUCTILE IRON 90 DEGREE BEND (INCLUDING D.I. FITTINGS)	EACH	3	
59	2504.603	8" DIPS HDPE WATER MAIN SDR 11	LF	40	
60	2504.603	8" DIPS HDPE WATER MAIN SDR 11 (HORIZONTAL DIRECTIONAL DRILL)	LF	165	
61	T-901-5.1	TURF ESTABLISHMENT (INCLUDES FERTILIZER, SEED, MULCHING AND STABILIZATION)	LS	1	

X:\AE\IDUL\167725-final-dsgn\51-drawings\65-Aviation\Plans\G2.00 CSPP NOTES AND SEQ_Addendum No.4.dwg 6/15/2023 8:28 AM rfrach

3535 MADISON CENTER DR
 ST PAUL, MN 55110
 FAX: 651-402-2150
 WA 1775: 800.525.5055
 www.sehinc.com

I HEREBY CERTIFY THAT THIS PLAN, SPECIFICATION, OR CONTRACT DOCUMENTS WERE PREPARED BY ME OR UNDER MY DIRECT SUPERVISION AND THAT I AM A duly LICENSED PROFESSIONAL ENGINEER UNDER THE LAWS OF THE STATE OF MINNESOTA.

Ryan M. Falch
 Ryan M. Falch, PE
 DATE: 05.10.2023 LICENSE NO: 68048

SKY HARBOR AIRPORT
 2023 CONSTRUCT SRE BUILDING
 DULUTH, MN

MARK	DATE	DESCRIPTION
6/16/23	5/16/23	APPENDUM NO. 4

SEH FILE NO. DULAL_167772
 STATE PROJECT NO. N/A
 ISSUE DATE 05.10.2023
 DESIGNED BY RMF
 DRAWN BY RMF
 Short Elliott Hendrickson, Inc. © (SEH)
 © 2023 Short Elliott Hendrickson, Inc.

SHEET TITLE
 GENERAL NOTES AND STATEMENT OF ESTIMATED QUANTITIES

SHEET
G2.01

X:\A\ID\167772\5-final-dsgn\5-drawings\65-Aviation\Plans\DYT-167772_GP_ADD_#4.dwg 6/16/2023 9:14 AM rfeich

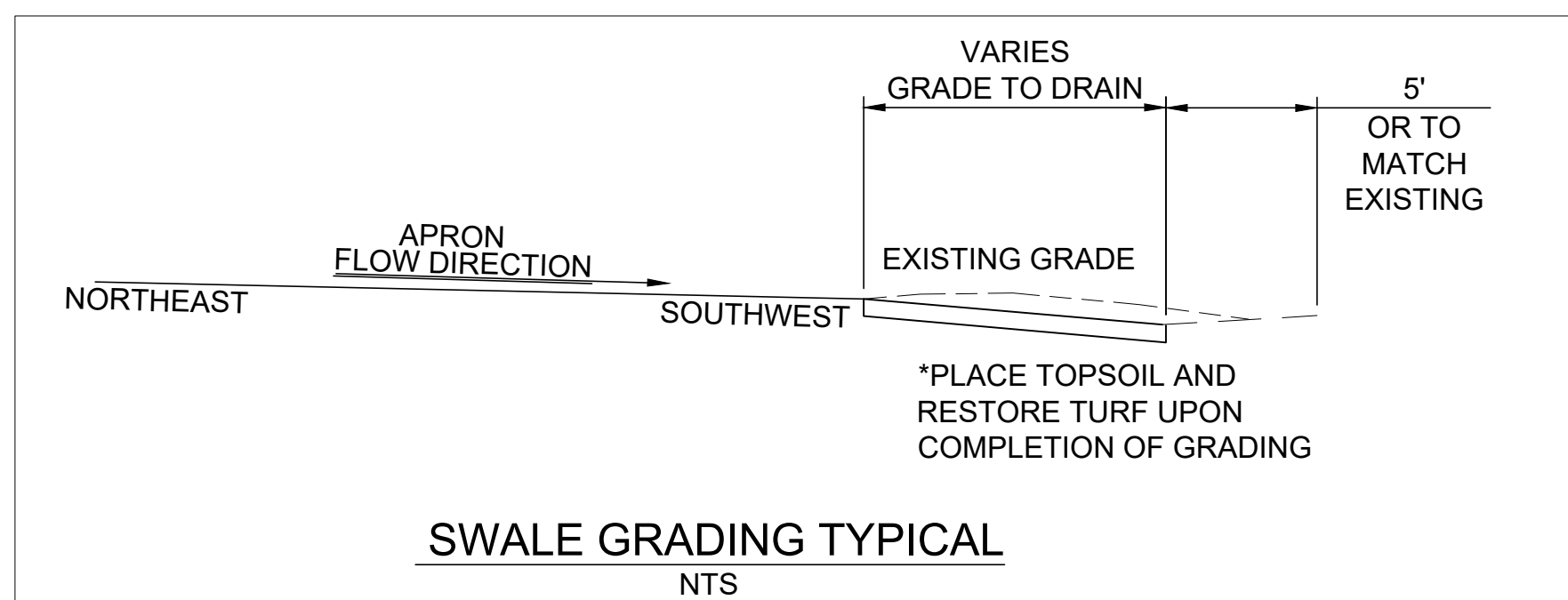

1. ASSUME AVERAGE EXCAVATION DEPTH OF 8", PAID AS "SITE GRADING (LS)"
2. 4" TOPSOIL PLACEMENT AND TURF RESTORATION TO BE PAID AS "SELECT TOPSOIL BORROW (CV) (CY)" AND "TURF ESTABLISHMENT (LS)".
3. EXCESS MATERIAL TO BECOME PROPERTY OF CONTRACTOR FOR DISPOSAL OFF-SITE.

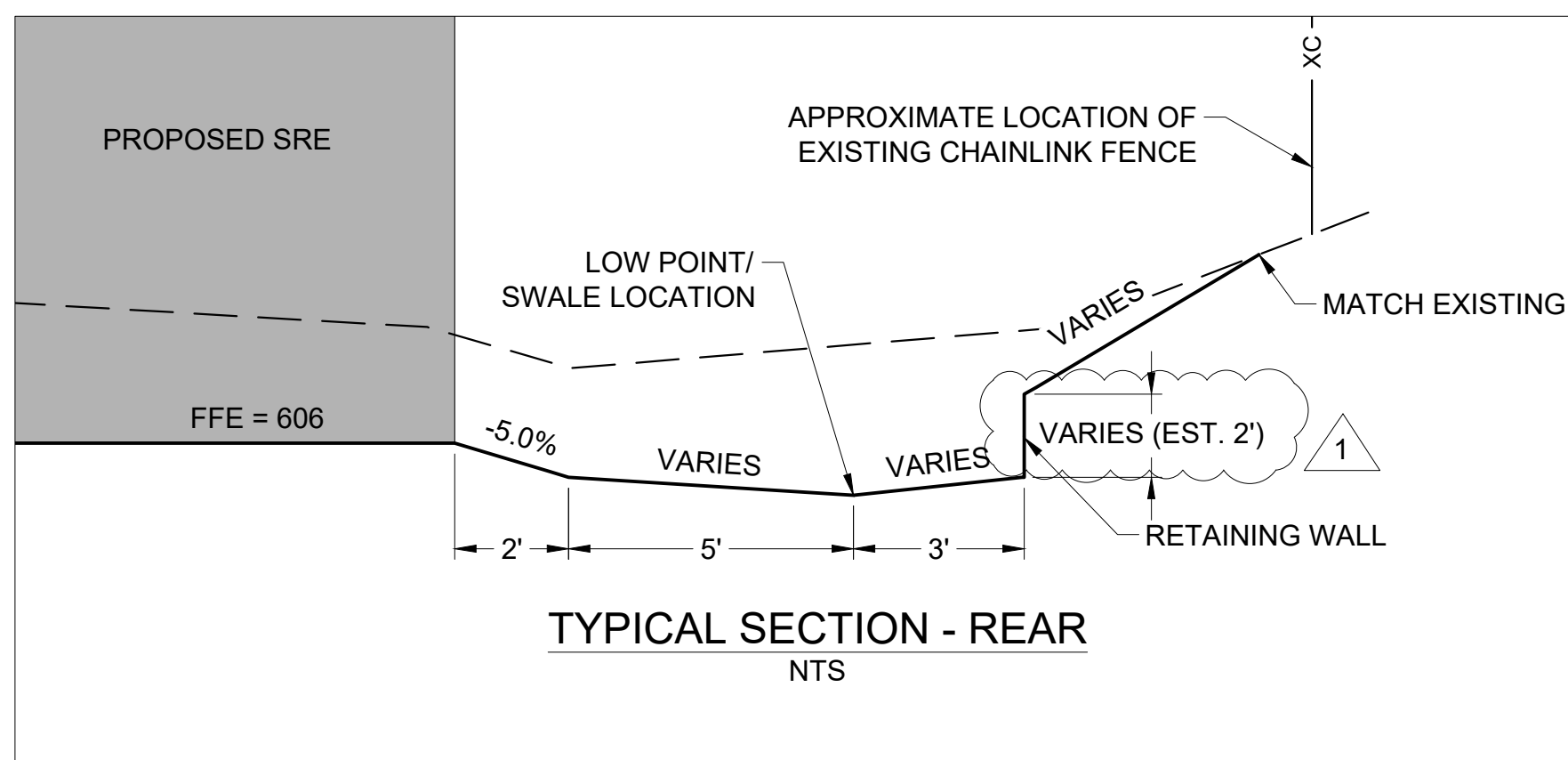

- LEGEND:**
- ← IMPROVE EXISTING SWALE
 - PROPOSED CONTOURS
 - - - EXISTING CONTOURS
 - · - · - APROX CONSTRUCTION LIMITS
 - RETAINING WALL
 - PROPOSED SRE BUILDING

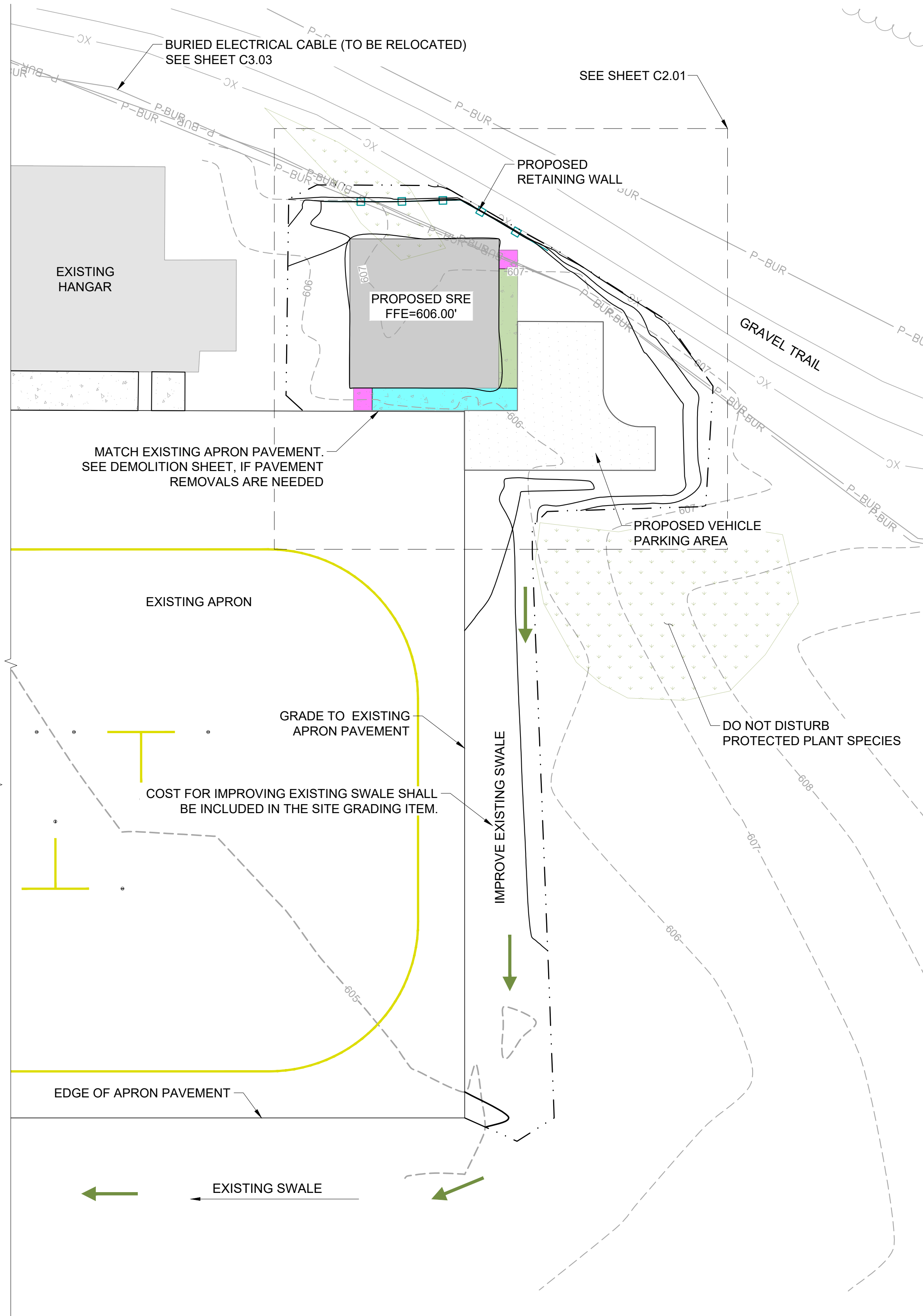
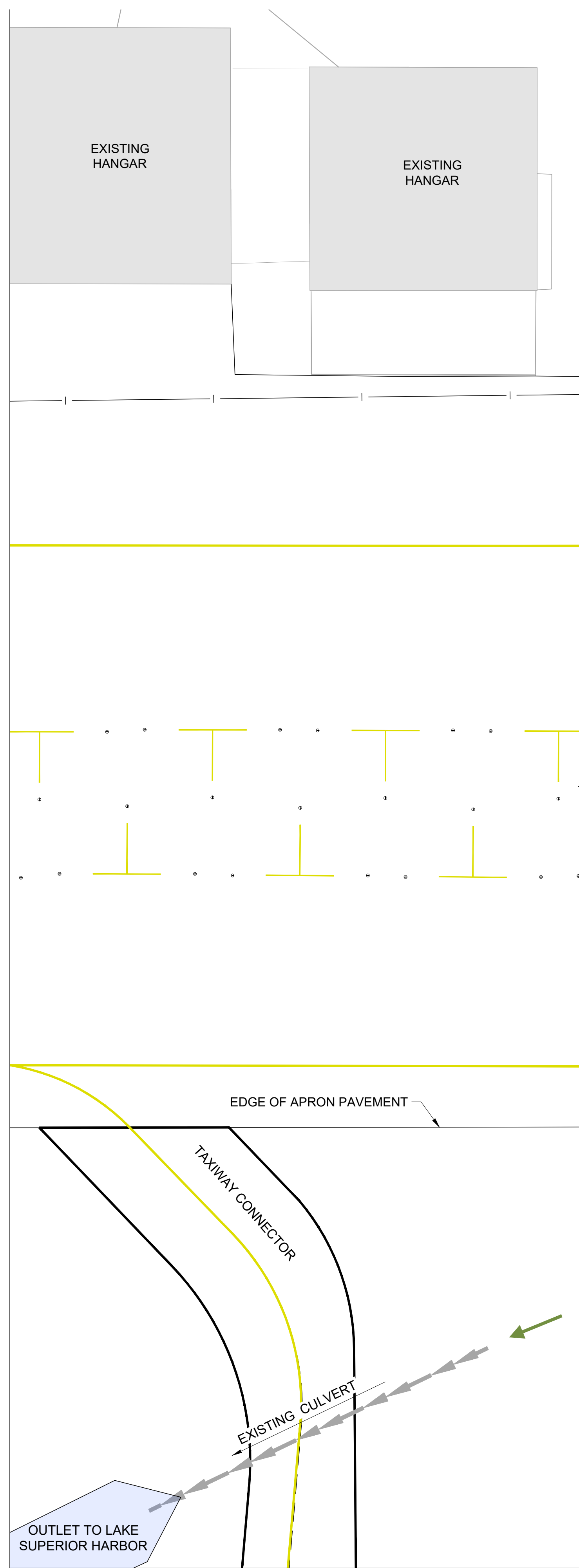
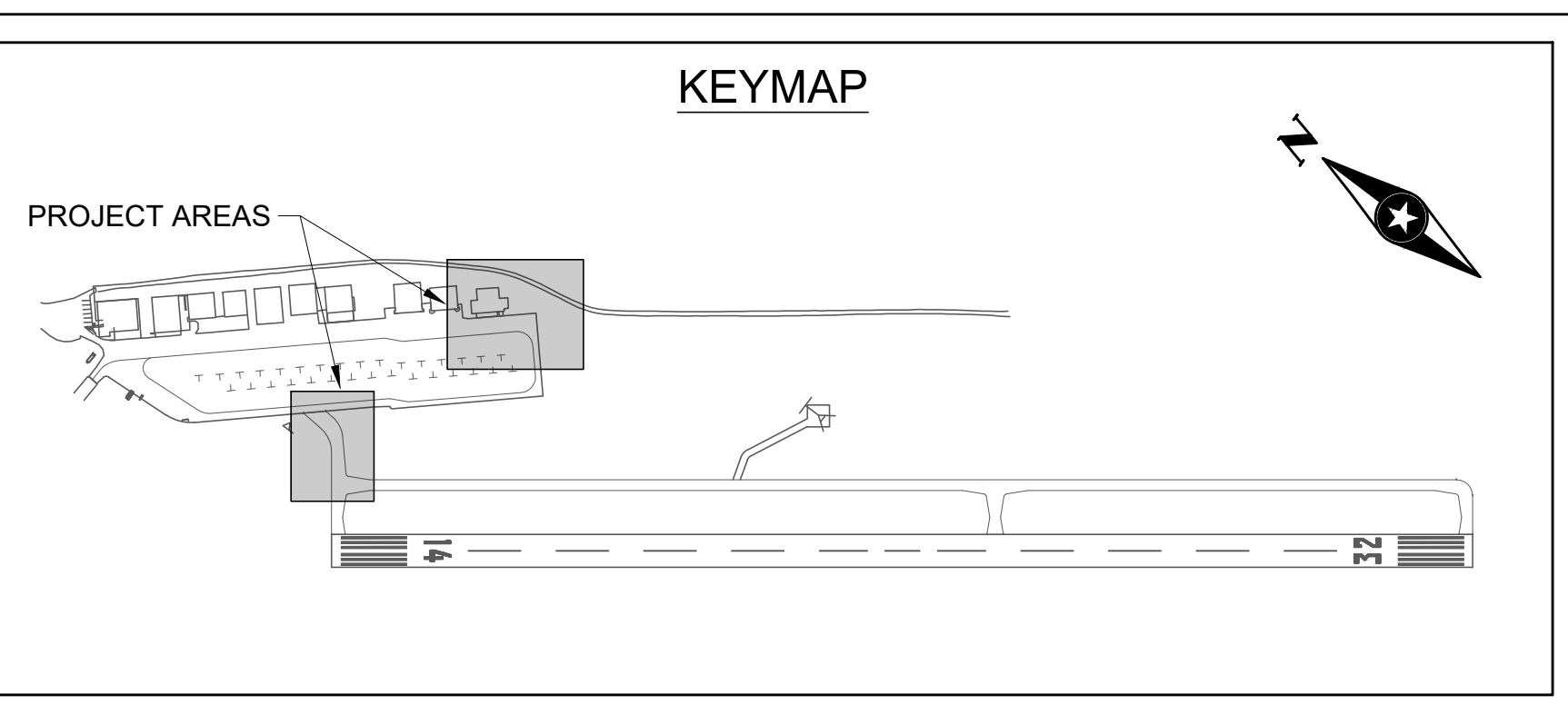
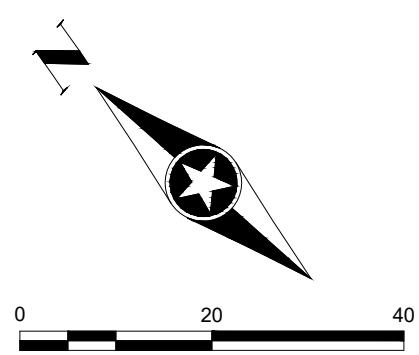

NOTES:

1. ALL SUBSURFACE UTILITIES, INCLUDING SANITARY SEWER AND ELECTRICAL DUCTS TO BE PROTECTED BY CONTRACTOR. ANY DAMAGED UTILITIES TO BE REPAIRED BY CONTRACTOR AT NO COST TO OWNER. NOT ALL UTILITIES MAY BE SHOWN ON THE PLAN.
2. LOCATE & PROTECT ALL EXISTING AIRFIELD ELECTRICAL CIRCUITRY AND COMPONENTS.
3. CONTRACTOR IS RESPONSIBLE LOCATING ALL EXISTING PUBLIC AND PRIVATE UTILITIES WITHIN THE PROJECT AREA.

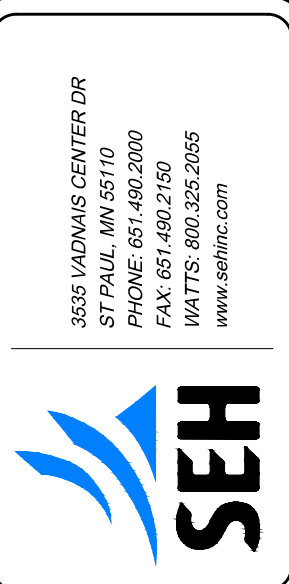

I HEREBY CERTIFY THAT THIS PLAN, SPECIFICATION, OR CONTRACT DOCUMENTS WERE PREPARED BY ME OR UNDER MY DIRECT SUPERVISION AND THAT I AM A DULY LICENSED PROFESSIONAL ENGINEER UNDER THE LAWS OF THE STATE OF MINNESOTA.

Ryan M. Falck
Ryan M. Falck, PE
DATE: 05.10.2023 LICENSE NO: 60406

SKY HARBOR AIRPORT
2023 CONSTRUCT SRE BUILDING
DULUTH, MN

MARK	DATE	DESCRIPTION	REVISIONS
6/16/23	ADDENDUM NO. 4		

SEH FILE NO. DULAL_167772
STATE PROJECT NO. N/A
ISSUE DATE 05.10.2023
DESIGNED BY SL
DRAWN BY SL
Short Elliott Hendrickson, Inc. © (SEH)
© 2023 Short Elliott Hendrickson, Inc.

SHEET TITLE
GRADING PLAN

SHEET
C2.00