

Gunnar Birkerts and Associates
Architects

292 Harmon Street Birmingham Michigan 48204
Tel 644 0004

Robert M. Darvas & Associates
STRUCTURAL ENGINEERS
ANN ARBOR, MICHIGAN

Hoyem-Basso Associates
INCORPORATED
MECHANICAL & ELECTRICAL ENGINEERS
BLOOMFIELD HILLS, MICHIGAN

Duluth Public Library
DULUTH, MINNESOTA

INTERIOR FURNISHINGS

GROUND FLOOR PLAN

tel 644 06
292 Harmon street Birmingham Michig

**Hoyem-Basso
Associates
Incorporated**
MECHANICAL & ELECTRICAL
ENGINEERS
BLOOMFIELD HILLS, MICHIGAN

REVISION

DRAWN
CHECKED
APPROVED
APPROVED FOR CONSTR
DATE JUNE 21, 1979 - BLDG
SCALE 1/8" = 1' 0"

7306	F2
------	----

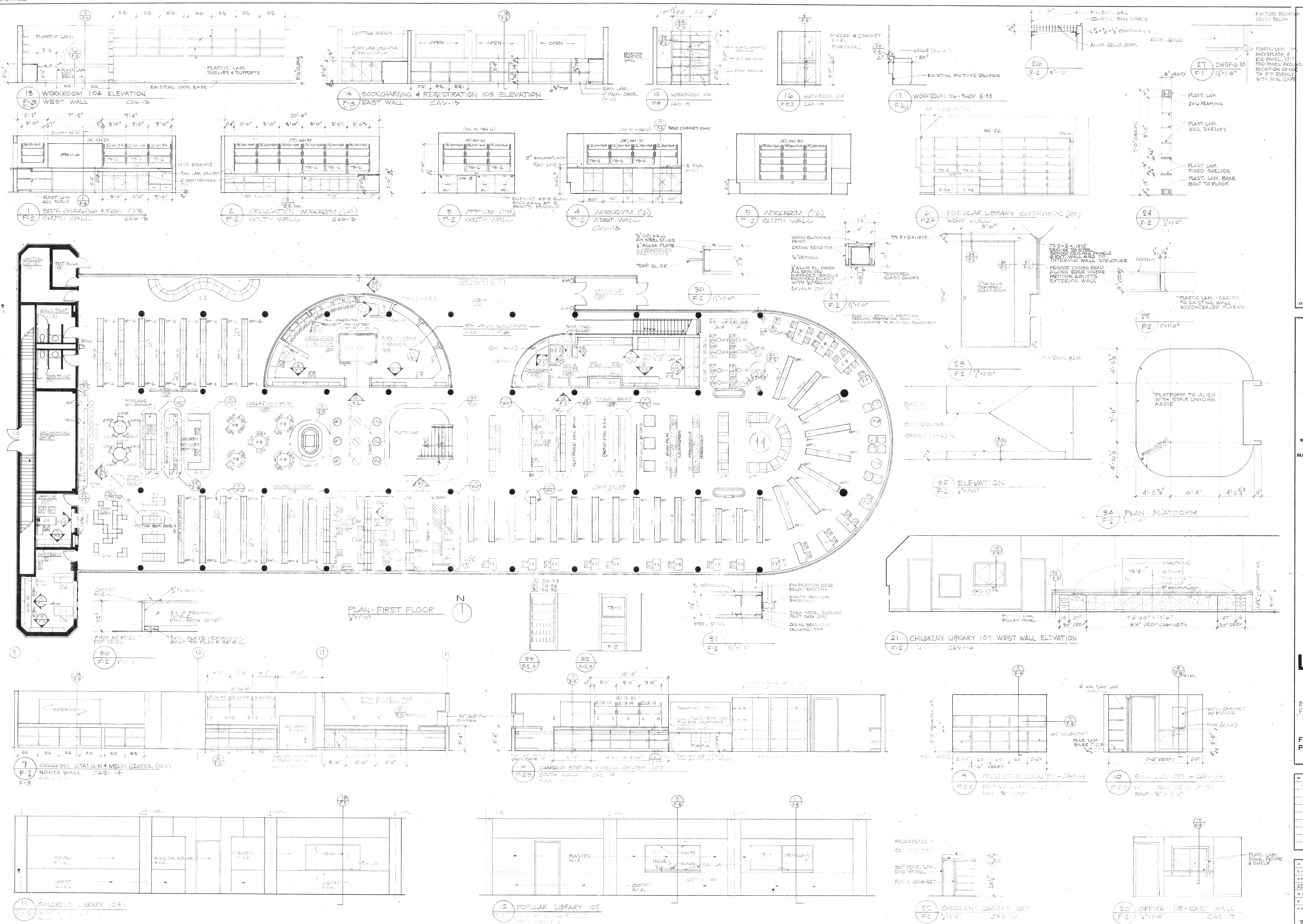

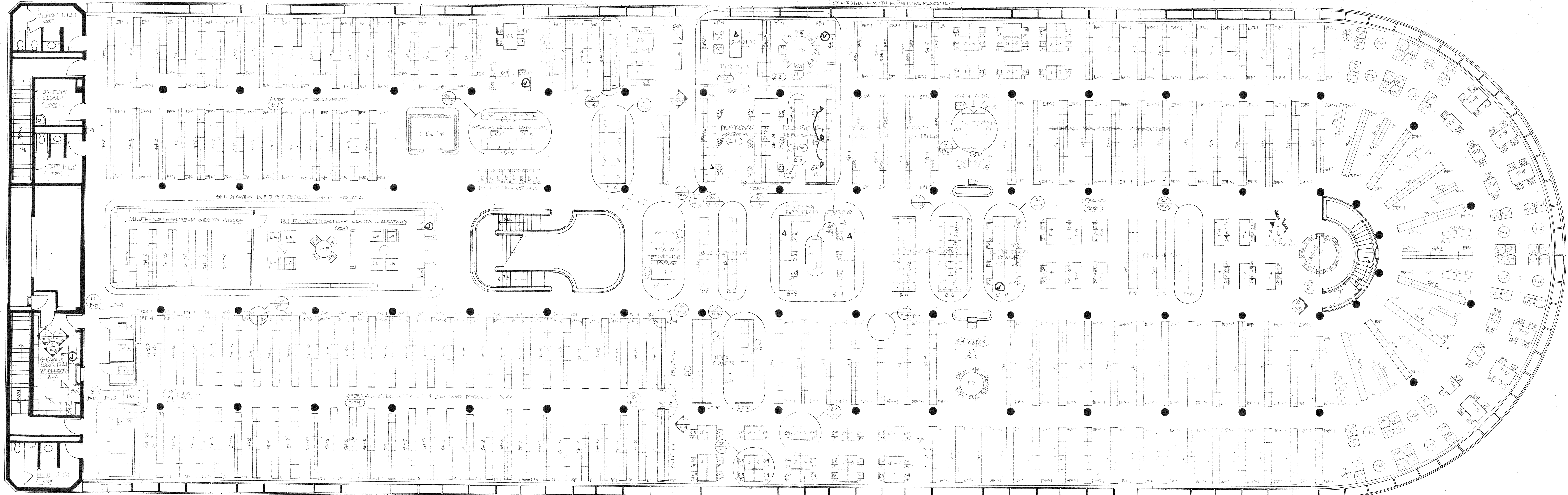
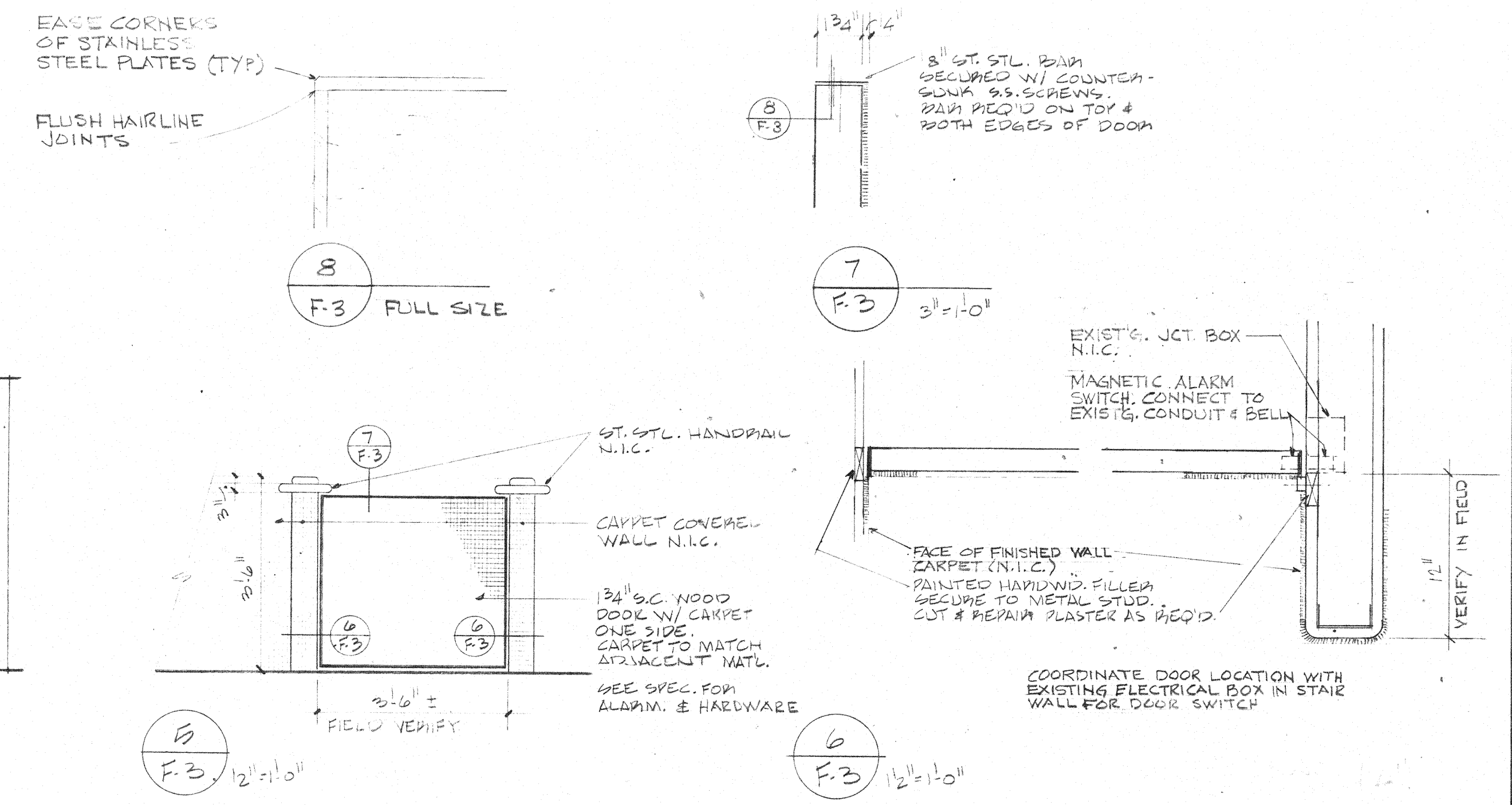
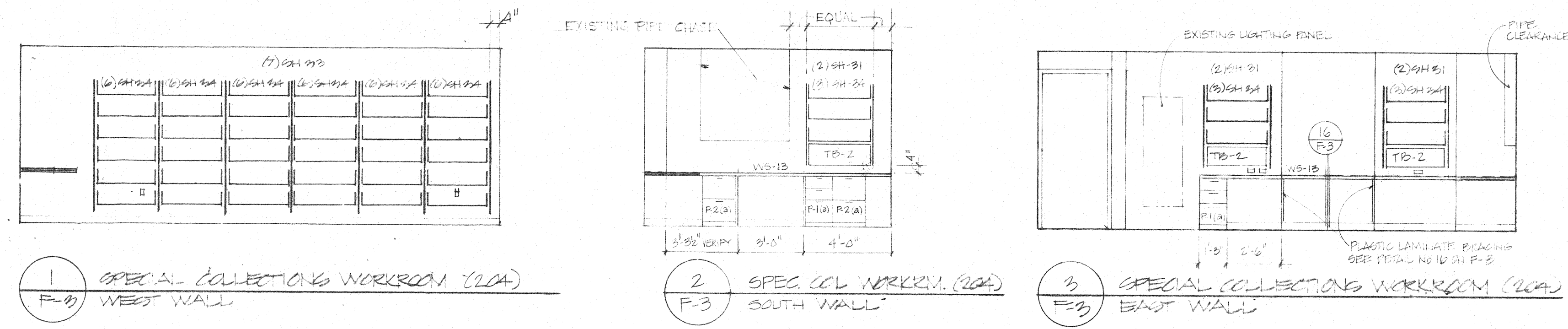

LOCATION OF ELECTRIC CONDUIT
FEEDING PERIMETER CIRCUIT
COORDINATE WITH FURNITURE PLACEMENT

SECOND FLOOR PLAN

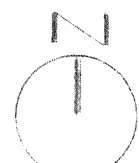

NOTES
SEE DRAWING NO. F-1

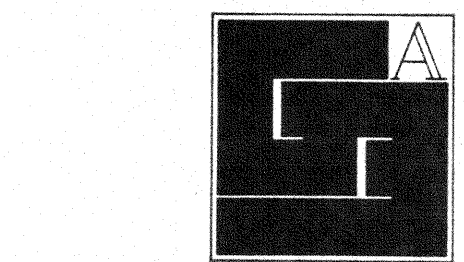

Gunnar Birkerts
and
Associates
Architects

252 Harmon Street Birmingham, Michigan

Robert M. Darvas
&
Associates
STRUCTURAL ENGINEERS
ANN ARBOR, MICHIGAN

Hoyem-Basso
Associates
INCORPORATED
MECHANICAL & ELECTRICAL
ENGINEERS
BLOOMFIELD HILLS, MICHIGAN

Duluth
Public
Library
DULUTH, MINNESOTA

INTERIOR
FURNISHINGS

SECOND FLOOR
PLAN

EDA LPW 06-01-0278

REVISIONS		
ITEM	DATE	BY

DRAWN	
CHECKED	
APPROVED	
DATE	JUNE 20, 1973 - EDA
SCALE	1/4" = 1'-0"
PROJECT	
7306	F3

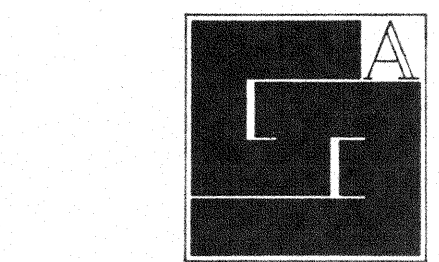
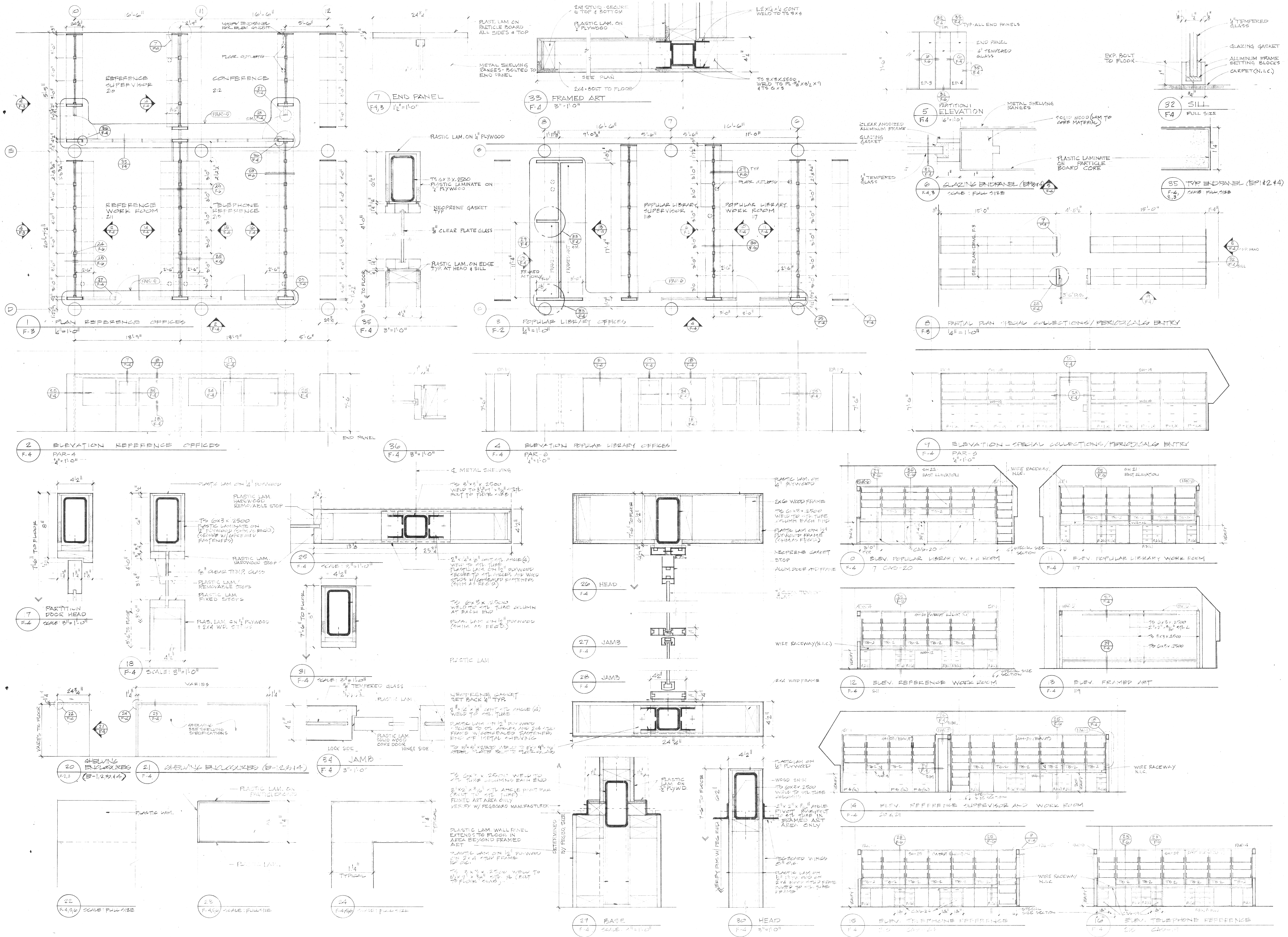

**Gunnar Birkerts
and
Associates
Architects**

292 Harmon Street Birmingham, Michigan 48202
Tel 664 6004

**Robert M. Darvas
&
Associates**
STRUCTURAL ENGINEERS
ANN ARBOR, MICHIGAN

**Hoyem-Basso
Associates
Incorporated**
MECHANICAL & ELECTRICAL
ENGINEERS
BLOOMFIELD HILLS, MICHIGAN

**Duluth
Public
Library**
DULUTH, MINNESOTA

INTERIOR
FURNISHINGS

ELEVATIONS AND
DETAILS

IDA LPW 8-1-127-1

REVISIONS	ITEM	DATE	BY

DRAWN: AGS
CHECKED: AGS
APPROVED: AGS
DATE: 2/19/77
SCALE: 1/4" = 1'-0"
PROJECT: 7306

F4

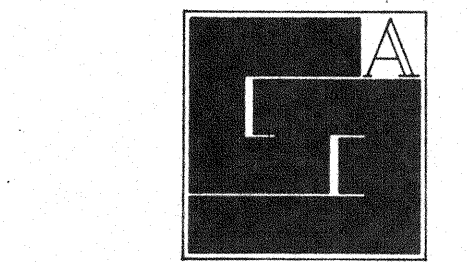
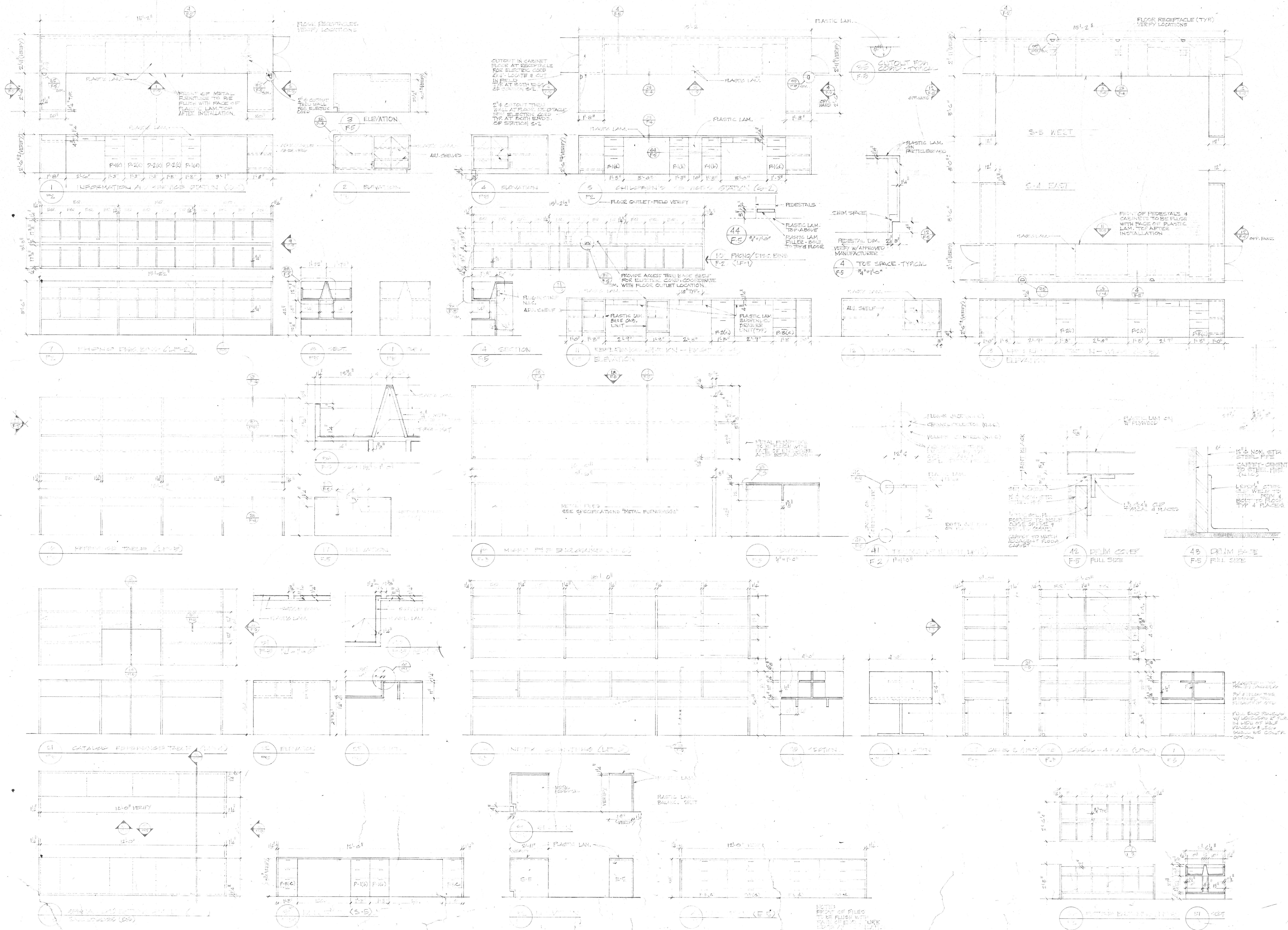

Gunnar Birkerts and Associates Architects

282 Harmon Street Birmingham, Michigan

Robert M. Darvas & Associates
STRUCTURAL ENGINEERS
ANN ARBOR, MICHIGAN

Hoyem-Basso Associates Incorporated
MECHANICAL & ELECTRICAL ENGINEERS
BLOOMFIELD HILLS, MICHIGAN

Duluth Public Library
DULUTH, MINNESOTA

INTERIOR FURNISHINGS

ELEVATIONS AND DETAILS

REVISIONS	ITEM	DATE	BY
1	OWNER	8-74	
2	OWNER	9-74	
3	OWNER	10-74	
4	OWNER	11-74	
5	OWNER	12-74	
6	OWNER	1-75	
7	OWNER	2-75	
8	OWNER	3-75	
9	OWNER	4-75	
10	OWNER	5-75	

DRAWN	CHECKED	APPROVED	DATE
SCALE	PROJECT		
7306	F5		

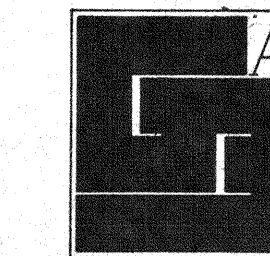

Gunnar Birkerts and Associates Architects

1st 644 0804
222 Harmon Street, Birmingham, Michigan

Robert M. Darvas & Associates
STRUCTURAL ENGINEERS
ANN ARBOR, MICHIGAN

Hoyem-Basso Associates Incorporated
MECHANICAL & ELECTRICAL ENGINEERS
BLOOMFIELD HILLS, MICHIGAN

Duluth Public Library
DULUTH, MINNESOTA

INTERIOR FURNISHINGS

ELEVATIONS AND DETAILS

EDA LPW 06-S1-02786

REVISIONS		
ITEM	DATE	BY

DRAWN
CHECKED
APPROVED
APPROVED
DATE: 06/21/97 - CJS
SCALE: 1/8" = 1'-0"
PROJECT
7306 **F6**

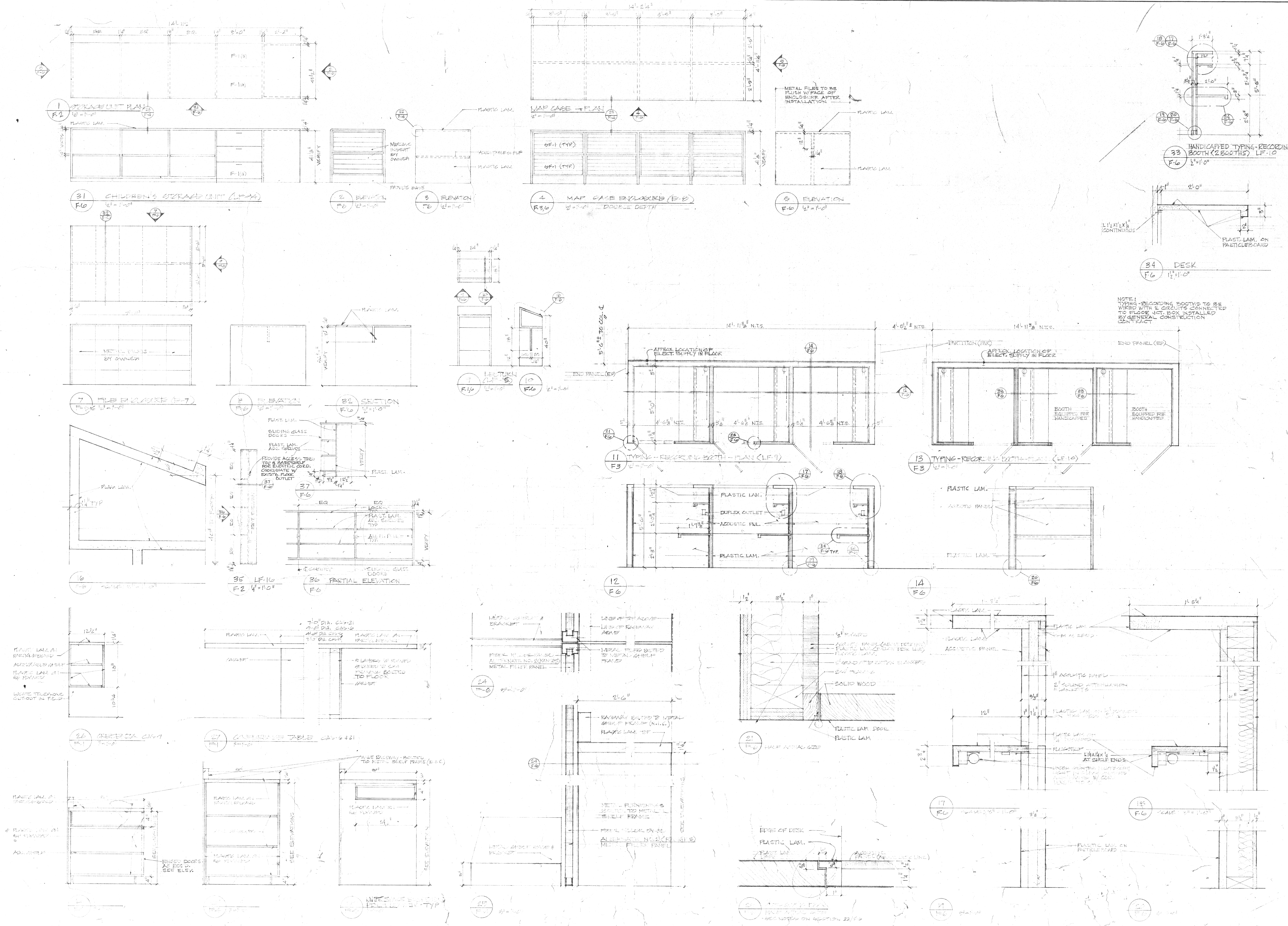

tel 644 0604
292 Harmon street Birmingham Michigan

**Hoyem-Basso
Associates
Incorporated**
MECHANICAL & ELECTRICAL
ENGINEERS
BLOOMFIELD HILLS, MICHIGAN

INTERIOR FURNISHINGS

[illegible]

DRAWN <i>AC</i>	
CHECKED	
APPROVED	
APPROVED FOR CONGR	
DATE <i>JUNE 21, 1979 - BUD</i>	
SCALE <i>AS NOTED</i>	
PROJECT	
7612	F.7

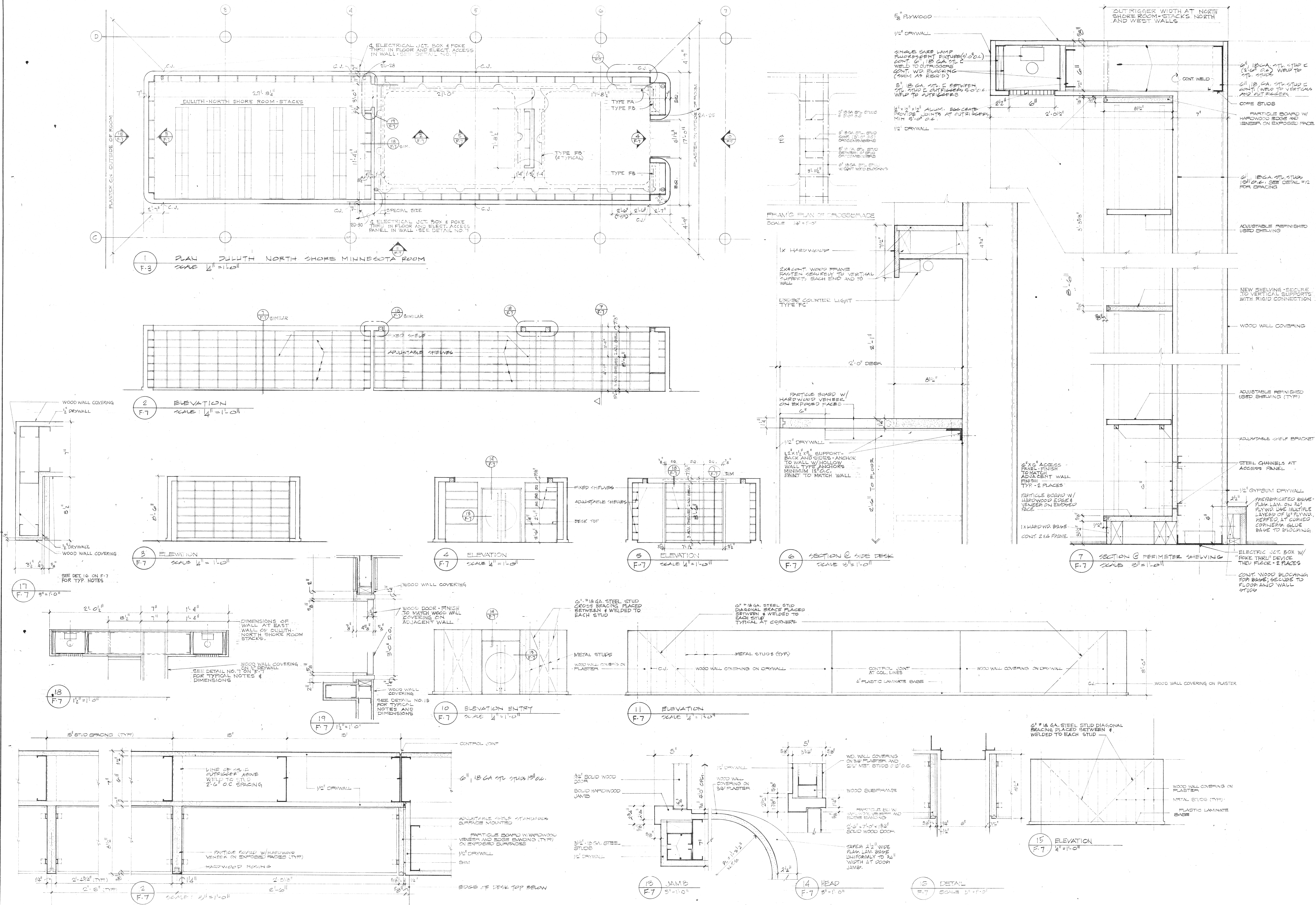

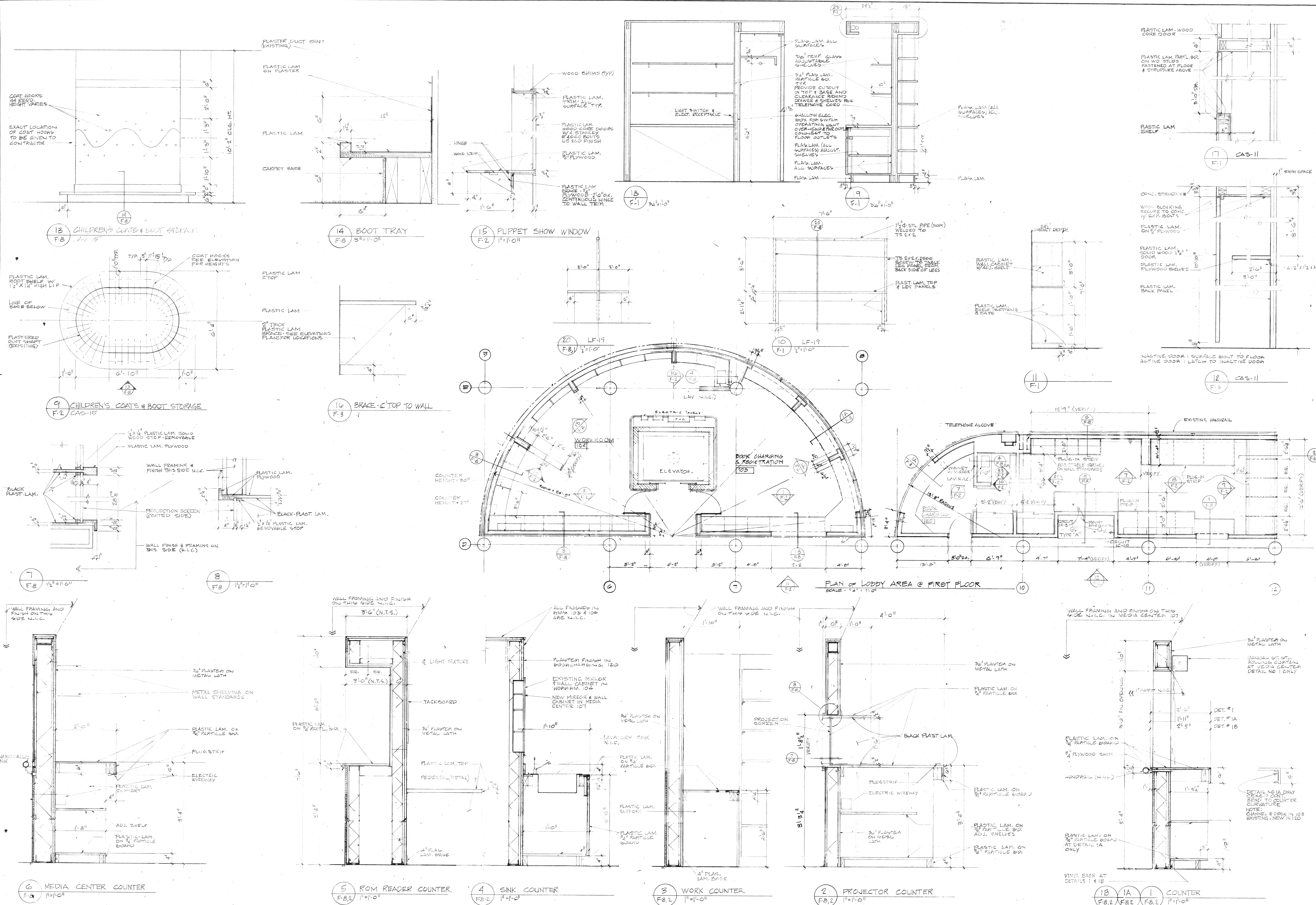

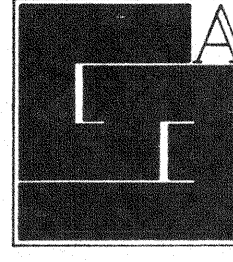

Gunnar Birkerts and Associates Architects

1st 244.0804
Birmingham, Michigan

Robert M. Darvas & Associates

STRUCTURAL ENGINEERS
ANN ARBOR, MICHIGAN

Hoyem-Basso Associates Incorporated

MECHANICAL & ELECTRICAL ENGINEERS
BLOOMFIELD HILLS, MICHIGAN

Duluth Public Library

DULUTH, MINNESOTA

INTERIOR FURNISHINGS

MISCELLANEOUS DETAILS

EDA:TPW 96-51-02786

REVISIONS		
ITEM	DATE	BY

NOTES

1. SEE DRAWING F-1

2. REMOVE ANY EXISTING VINYL BASES TO INSTALL BASE CABINETS.

F-8

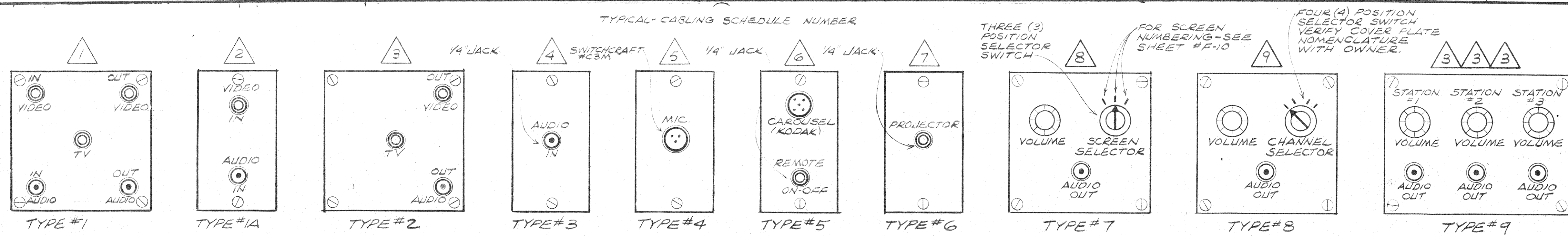

T.V. DISTRIBUTION & A-V SYSTEM WALL PLATES

- NOTES:
1. ALL PLATES SHALL BE STAINLESS STEEL WITH ENGRAVED NAMEPLATE TO INDICATE FUNCTION AS SHOWN.
 2. CONNECTOR TYPES: VIDEO-BNC, AUDIO-1/4 JACK, TV-F TYPE
 3. VERIFY IN FIELD AND WITH OWNER SIZE OF COVER, NOMENCLATURE & ENGRAVING PROCESS BEFORE FABRICATION.
 4. THE VOLUME CONTROLS MOUNTED ON COVER PLATES #7, 8 & 9 SHALL BE COORDINATED WITH EQUIPMENT & HEADPHONES AND SHALL BE MANUFACTURED BY MALLORY, CENTRAL LAB OR OTHER APPROVED.
 5. THE THREE (3) & FOUR (4) POSITION SELECTOR SWITCHES SHALL BE COORDINATED WITH EQUIPMENT AND SHALL BE MANUFACTURED BY SWITCHCRAFT, CENTRAL LAB, ORTRON OR OTHER APPROVED.

SYMBOL LIST	
SYMBOL	DESCRIPTION
(A)	EQUIPMENT SCHEDULE LETTER
(5)	OUTLET PLATE NUMBERING
(A)	WIRE SCHEDULE NUMBER
---	EXISTING CONDUIT
⊕	EXISTING 120V 1ϕ RECEPTACLE
AFF	ABOVE FINISHED FLOOR
N.I.C.	NOT IN CONTRACT

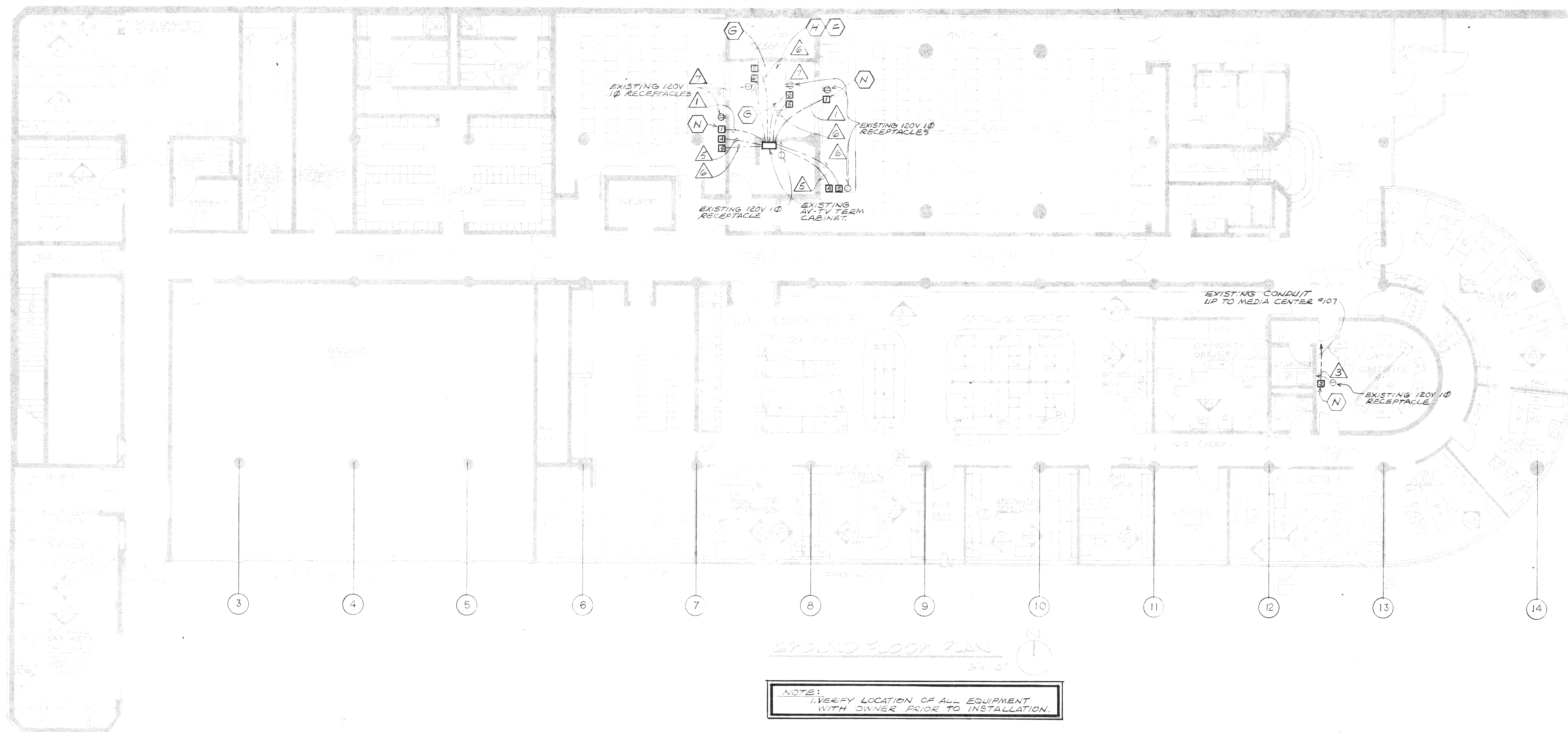

EQUIPMENT SCHEDULE		
EQUIP LETTER	DESCRIPTION	REMARKS
(A)	AUDIO-VISUAL DISTRIBUTION SYSTEM ENCLOSURE	
(B)	MAIN COLOR RECEIVER/MONITOR	
(C)	TURNABLES	
(D)	STEREO CASSETTE DECK	
(E)	MOBILE MULTIPLEXER	
(F)	16MM PROJECTOR	
(G)	CAROUSEL PROJECTOR	
(H)	SUPER 8MM SOUND PROJECTOR	
(I)	SOUND FILM STRIP PROJECTOR	
(J)	DUAL 8MM PROJECTOR	
(K)	VIDEO CASSETTE RECORDER	
(L)	16MM FILM INSPECTION MACHINE	
(M)	8MM FILM INSPECTION MACHINE	
(N)	REMOTE COLOR RECEIVER/MONITOR	
(O)	MICROFILM READER	STORED ITEM
(P)	MICROFICHE READER	STORED ITEM
(Q)	6'X8' PULL DOWN SCREEN	STORED ITEM
(R)	5'X5' PULL DOWN SCREEN	STORED ITEM
(S)	COLOR CAMERA	STORED ITEM
(U)	PORTABLE VHS SYSTEM	STORED IN OWNER SELECTED CABINET
(V)	SLIDE STORAGE UNIT	NO HOOK-UP REQ'D
(W)	HEAD PHONES	STORED IN OWNER SELECTED CABINET
(X)	SPLICING BLOCKS	
(Y)	REAR PROJECTION LENSES	STORED IN OWNER SELECTED CABINET

WIRING SCHEDULE						
CABLING NUMBER	NUMBER OF CABLES	NUMBER OF CONDUCTORS	GAUGE AWG	MANUFACTURER & STYLE NUMBER	REFERENCE OUTLET PLATE NUMBER	REMARKS
1	3	1/2 SHIELDED	22	BELDEN # 8241	1	VIDEO IN & OUT TV CABLE
	2	3/4 SHIELDED	20	BELDEN # 8772		AUDIO IN & OUT
2	1	1/2 SHIELDED	22	BELDEN # 8241	1A	VIDEO IN
	1	3/4 SHIELDED	20	BELDEN # 8772		AUDIO OUT
3	2	1/2 SHIELDED	22	BELDEN # 8241*	2 & 9	VIDEO OUT & TV CABLE
	1	3/4 SHIELDED	20	BELDEN # 8772		AUDIO OUT
4	1	3/4 SHIELDED	20	BELDEN # 8772	3	AUDIO IN
	1	3/4 SHIELDED	20	BELDEN # 8772	4	MICROPHONE
5	1	5/C	20	BELDEN # 9445	5	CAROUSEL SLIDE PROJECTOR
	1	5/C	18	BELDEN # 8762	6	REMOTE ON-OFF
6	1	3/4 SHIELDED	20	BELDEN # 8772	7	PROJECTOR
	1	3/4 SHIELDED	20	BELDEN # 8772	7	AUDIO OUT
7	3	3/4 SHIELDED	16	BELDEN # 8470		SELECTOR SW.
	1	3/4 SHIELDED	20	BELDEN # 8772	8	AUDIO OUT
8	4	3/4 SHIELDED	16	BELDEN # 8470		SELECTOR SW.

NOTE: FOR COVERPLATE #9 COMBINE THREE (3) SETS.

* CABLE 16 FOR VIDEO ON PLATE 1A2 ONLY. DO NOT PROVIDE CABLE FOR PLATE 1A9

Gunnar Birkerts and Associates Architects

202 Harmon street Birmingham Michigan

Robert M. Darvas & Associates STRUCTURAL ENGINEERS ANN ARBOR, MICHIGAN

Hoyem-Basso Associates Incorporated MECHANICAL & ELECTRICAL ENGINEERS BLOOMFIELD HILLS, MICHIGAN

Duluth Public Library DULUTH, MINNESOTA

INTERIOR FURNISHINGS

AUDIO-VISUAL PLAN GROUND FLOOR

REVISIONS		
ITEM	DATE	BY

DRAWN	CHECKED
APPROVED	APPROVED FOR OWNER
DATE: JUNE 21, 1979 - EHS	SCALE: 1/8" = 1'-0"
PROJECT	F9
7306	

ter 84-0604
292 Harmon street Birmingham Michigan

**Hoyem-Basso
Associates
Incorporated**
MECHANICAL & ELECTRICAL
ENGINEERS
BLOOMFIELD HILLS, MICHIGAN

INTERIOR
FURNISHINGS

EDA LPW 06-51-0278r

DRAWN
CHECKED
APPROVED
APPROVED FOR CONSTR
DATE <i>JUNE 21, 1971 - BJD</i>
SCALE <i>1" = 1'-0"</i>
PROJECT

7306

F10

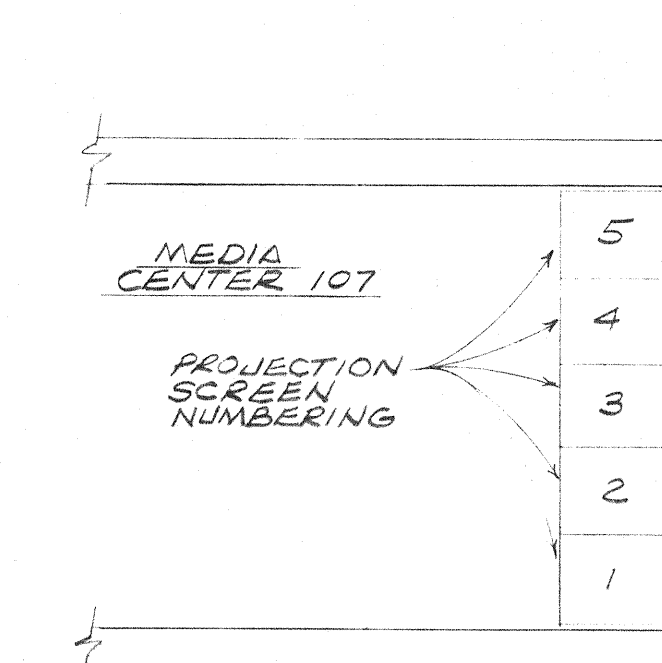
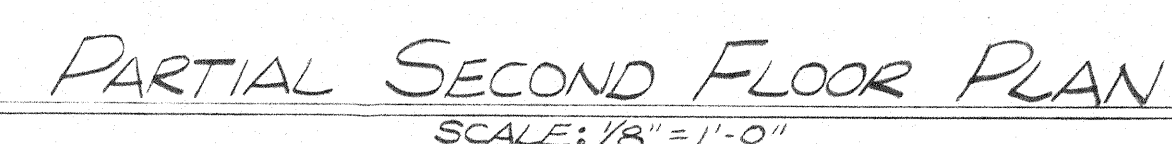

DETAIL OF SCREEN SELECTION NUMBERING
NO SCALE

