

# WAABIZHESHIKANA



## MARTEN TRAIL

DECEMBER 2020



# Boozhoo / Hello



John Koepke

Urban Ecosystems



Samuel Geer

Urban Ecosystems



Christine Carlson

Historian



Sarah Agaton Howes

Heart Berry

Artist



# Today's Meeting

- **Background & Context**
- **Big Stories**
- **Interpretative Approach**
- **Bringing the Plan to Life**



WAABIZHESHIKANA: TRAIL ALIGNMENT



# Presentation Goals

- **Stories**  
*Present Approach to Interpretation & Storytelling.*
- **Big Stories**  
*Tell the big stories that made this place..*
- **Interpretation**  
*Present proposed interpretive elements and experiences*



Harvesting Manoomin / Wild Rice, John Fritzen  
Fond du Lac: Head of the Lake,



# Engagement Goals

- **Hear your Stories**  
*Gather stories about the people, places and communities of the Estuary.*
- **Engagement**  
*Introduce Social Pinpoint tool for community engagement.*
- **Partnerships**  
*Identify Opportunities for collaboration and community participation*





An aerial photograph of a river and forested landscape. A semi-transparent topographic map is overlaid on the image, showing contour lines and elevation numbers. The river flows from the left towards the right, with several islands and peninsulas. The surrounding area is densely forested. In the lower right, there are some buildings and a road. A small orange dot is visible on the right bank of the river. The text "BACKGROUND & CONTEXT" is centered over the image.

## BACKGROUND & CONTEXT



# Study Area

- **Segments**  
*Implementation structure for the trail.*
- **Neighborhoods**  
*The communities that exist beside the river.*
- **River Places**  
*Landmarks and destinations along the river.*

## LEGEND

- Trail
- Passage
- Railroad
- Open Water
- Wetland
- River Places





# Mini-Master Plan



Lake Superior & Mississippi Railroad Excursion Train, 2020, Steve Durrant



Riverfront Park Plan for Spirit Lake Contained Disposal Facility, 2019,



# Planning Project Timeline

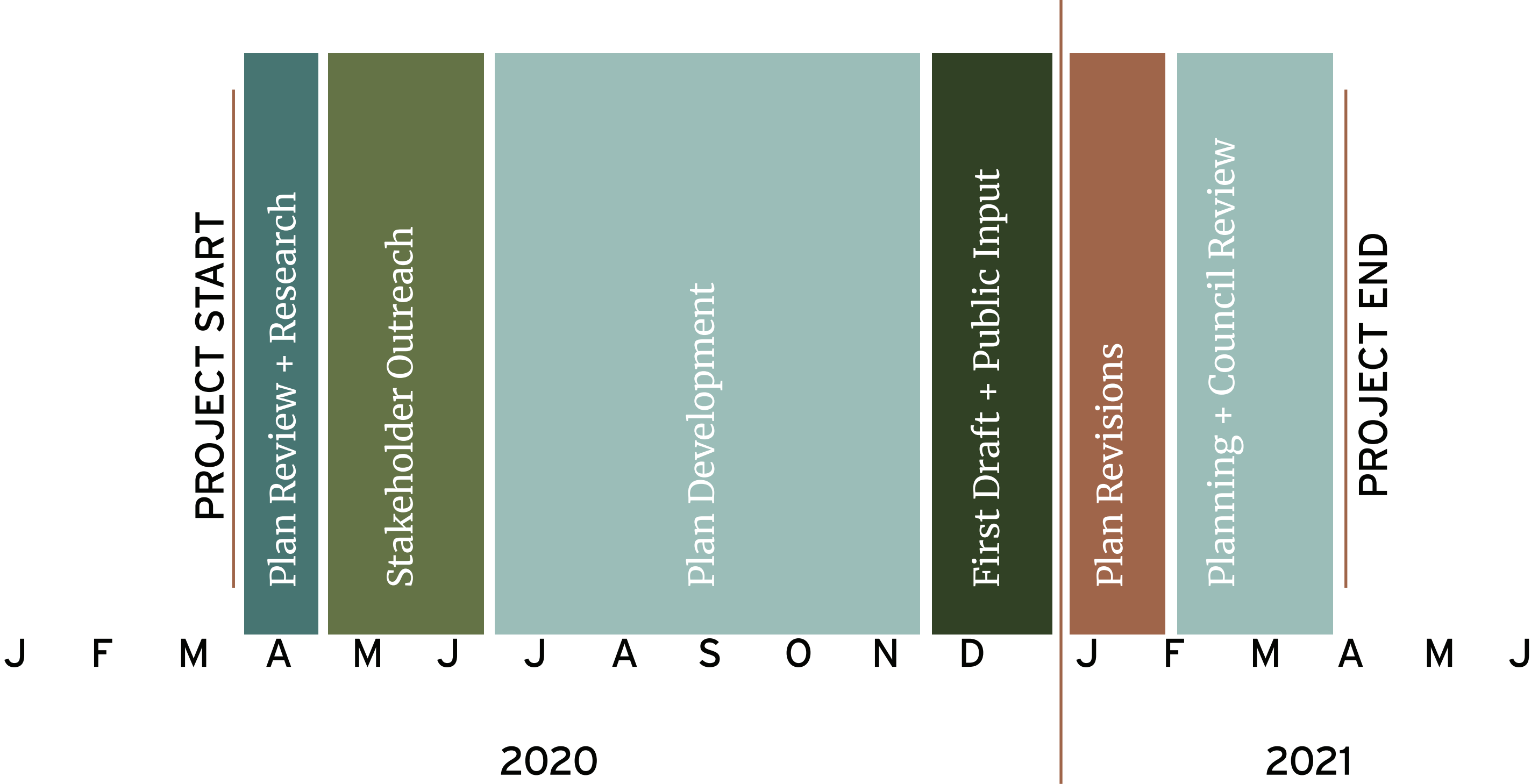



# Plan Components

## STORY THREADS

The big stories that shaped this place.

## INTERPRETIVE APPROACH

Visitor experience goals and storytelling methods

## INTERPRETIVE ELEMENTS

Creations that tell stories

## RIVER PLACES

Profiling the places along the Waterfront

## IMPLEMENTATION

Implementation Strategies and Estimated Costs

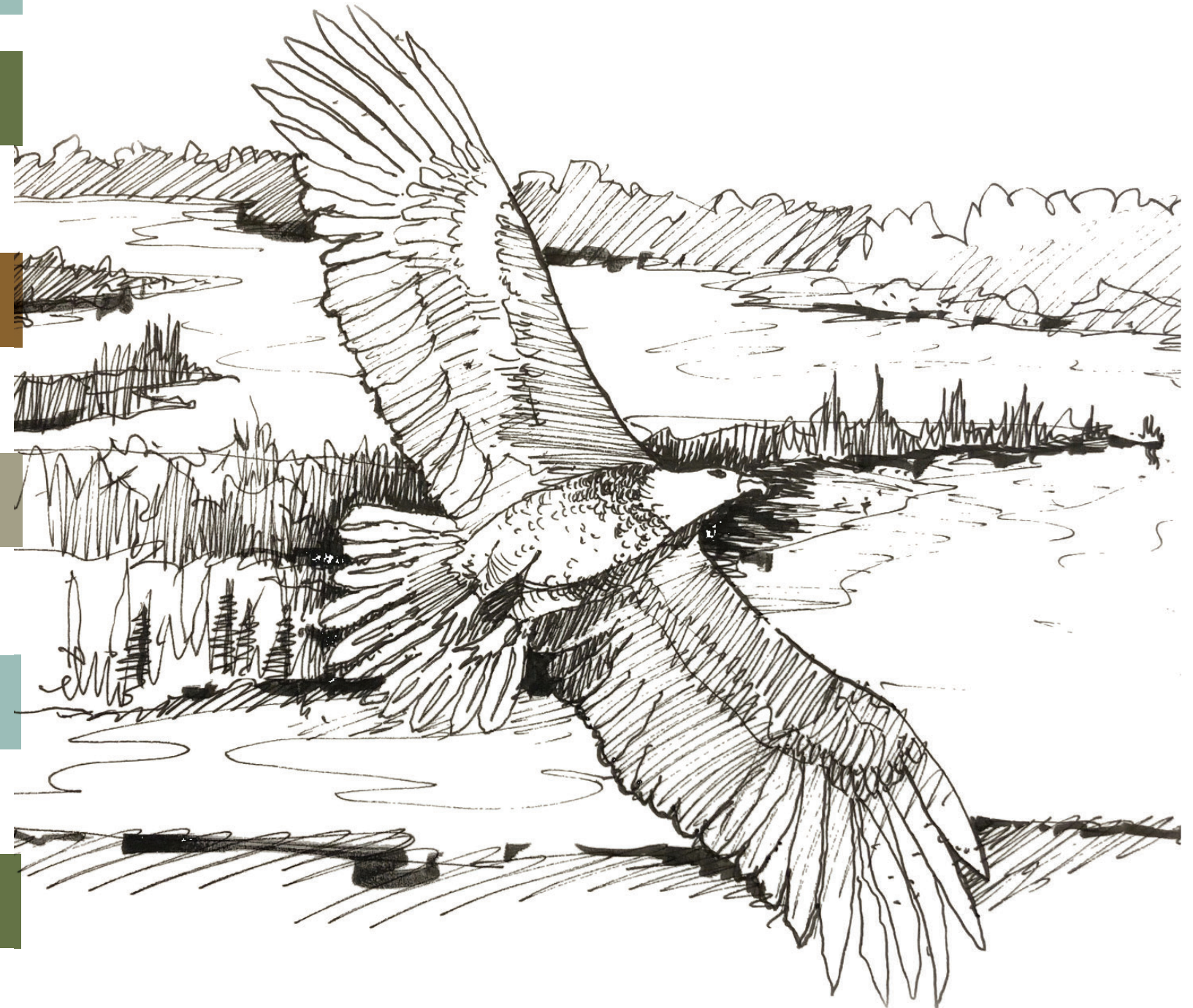

Migizi, 2020, John Koepke



# Approach to Research & Art



Marten Trail Logo, 2020, Sarah Agaton Howes



Manoomin, 2020, Sarah Agaton Howes



Chambers' quarry at Fond du Lac, 1881. University of Minnesota Duluth, Kathryn A. Martin Library, Northeast Minnesota Historical Center Collections. Research by Christine Carlson



Amik (Beaver) 2020, John Koepke



An aerial photograph of a river estuary, likely the Saginaw River, showing its winding path through a lush green forested landscape. The river flows from the upper left towards the lower right, eventually emptying into a larger body of water. The banks are densely wooded with green trees. A semi-transparent topographic map is overlaid on the entire image, showing contour lines and numerical elevation values. The text "BIG STORIES OF THE ESTUARY" is centered in the middle of the image in a bold, black, sans-serif font. At the bottom of the image, there is a horizontal bar composed of several colored segments: teal, dark green, olive green, brown, and tan.

# BIG STORIES OF THE ESTUARY



# Story Threads



Natural Estuary

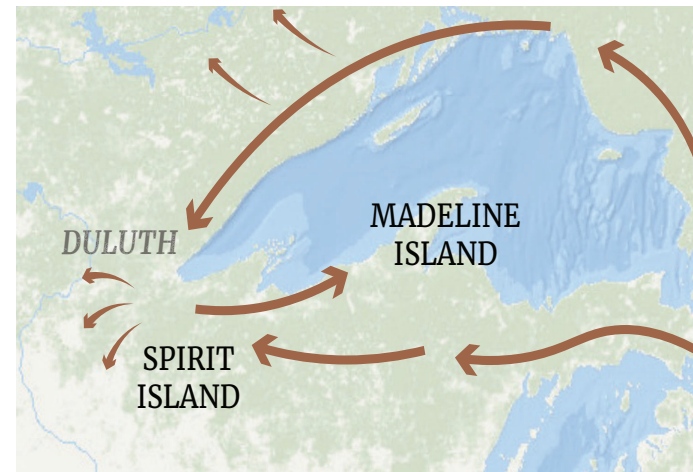

Great Migrations

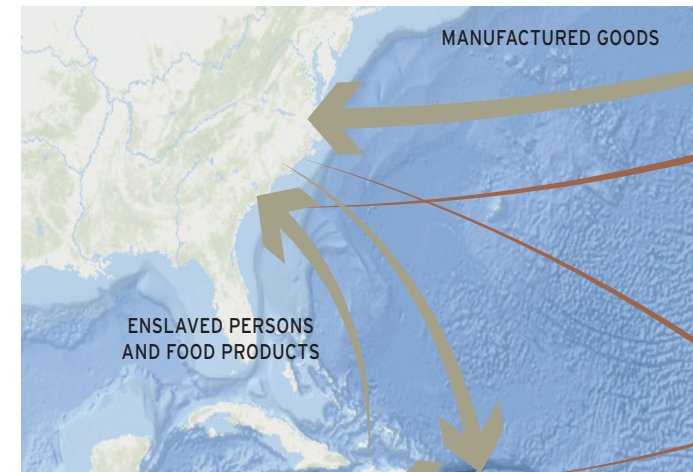

Global Connections



Fur Trade

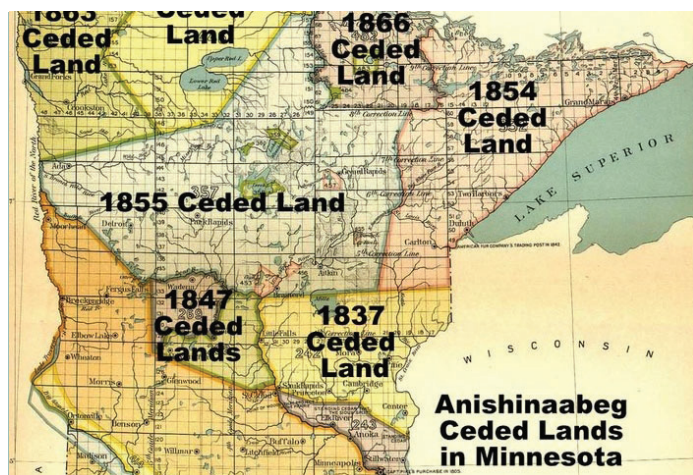

Treaties &  
Reservations



City of Industry



Restoration &  
Reciprocity



Seven Fires Prophecy



# Plant & Animal Guides

Zhashagi - John Koepke



Apakweshwayag - Sarah Agaton Howes



# People of the Estuary



New Duluth Boys - Personal Collection of Christine Carlsen



O-See-Gwun, 1826



# Lifeways (Making a Living)



Manoomin (Wild Rice), 1997, GLIFWC



# Lifeways (Making a Living)



Lumberjacks and river log drive on St. Louis River, near Duluth, Minnesota, 1888. Digitally enhanced image courtesy of University of Minnesota Duluth, Kathryn A. Martin Library, Northeast Minnesota Historical Center Collections.



# River Places

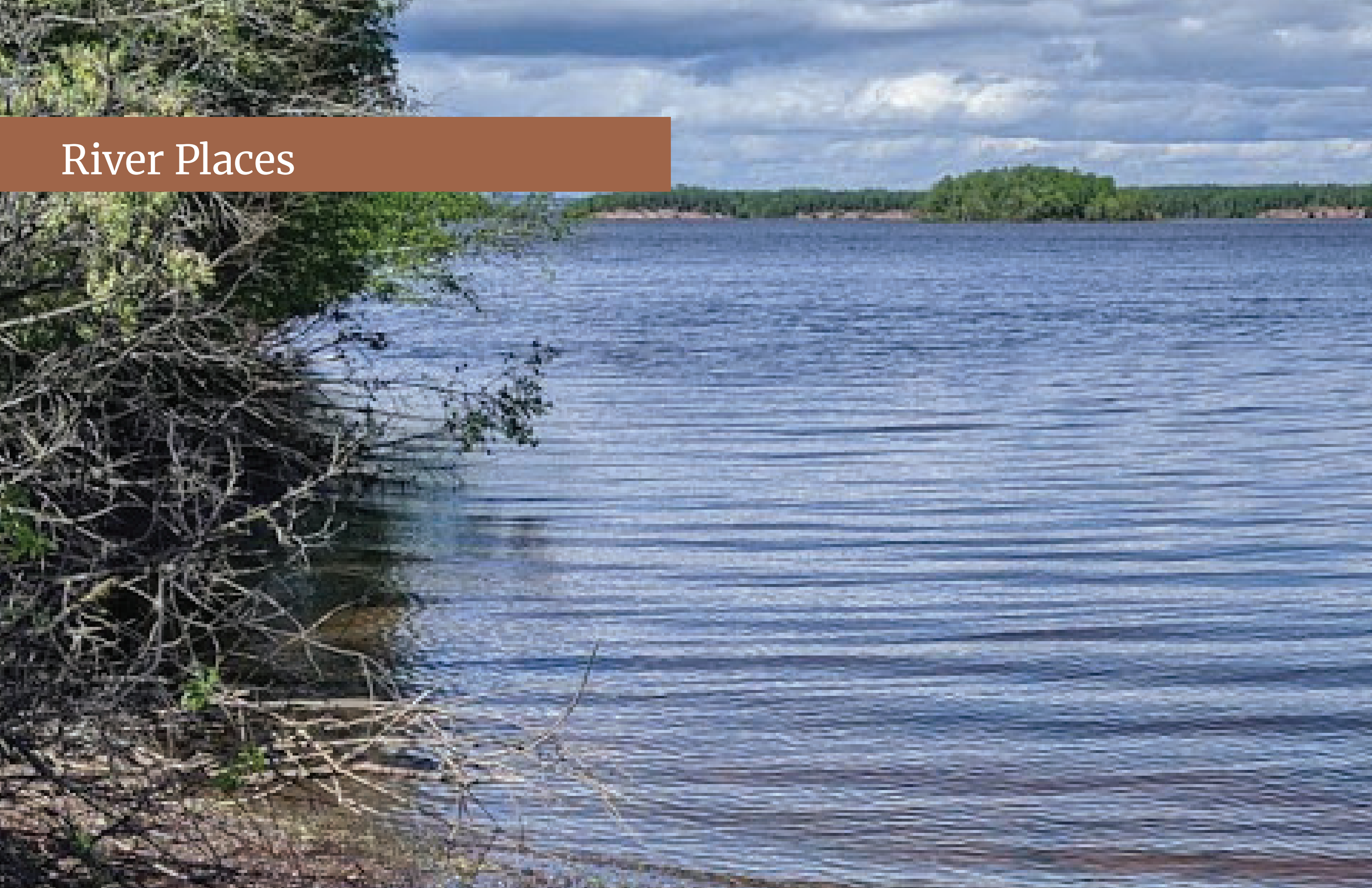



# River Places



United States Steel Mill, Duluth, Minnesota, 1956. Image courtesy of University of Minnesota Duluth, Kathryn A. Martin Library, Northeast Minnesota Historical Center Collections.



An aerial photograph of a river and forested landscape. A semi-transparent topographic map is overlaid on the image, showing contour lines and elevation numbers. The river flows from the upper left towards the right, with several islands and peninsulas. The surrounding area is densely forested. A small orange dot is visible on the right side of the river. The text "INTERPRETIVE APPROACH" is centered over the river.

# INTERPRETIVE APPROACH



# Visitor Experience Goals

Visitors will feel **WELCOME** and able to experience trail amenities with ease and comfort.

**REVEAL** - Make the invisible visible. Experiences that allow people to see the landscape in new ways.

Trail experiences will provide literal and multiple **PERSPECTIVES** and diverse cultural viewpoints.

Visitors will experience interpretive elements through a range of **SENSES**.

Layer different experiences with each visit that prompt trail visitors to **RETURN** think about environmental change over time.

Build **RESPECT**, awareness and reciprocity with the natural world. Opportunities for visitors to learn from wildlife and observe the landscape.





# Experience Confluence





# Experience Confluence

## ACCESS

Being able to easily find and access the trail is an essential prerequisite for all other goals. These places enable people to find the trail, park, gather, rest, and observe the landscape.

## ENJOYMENT

Being able to enjoy the riverfront on a sensory level and to safely explore the corridor encourages repeat visits, discovery, and greater awareness of the wildlife, history, and geology of the river.

## AWARENESS

These elements let people know something is there by making the invisible visible. They connect specific places to larger stories and help the visitor see these themes taking place along the estuary.

## SEEKING

These experiences involve active exploring of new places and making deeper observations about the landscape. Visitors pursue their own interests and can spend time exploring the trail.

## LEARNING

Learning experiences begin on the trail, but are resolved through individual research and motivated learning. The content can be delivered images, stories or in-person conversation and teaching.

## CARING

The culminating experiences are the reciprocal gestures of respect given by the community to the larger service of the estuary and its inhabitants.





# Materials + Style

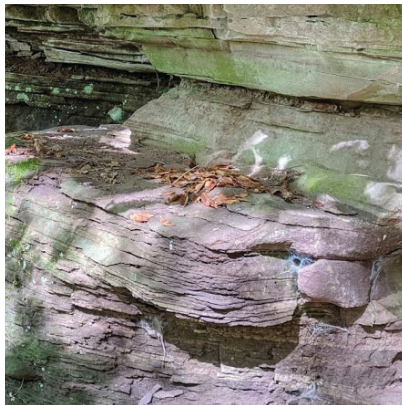

BROWNSTONE



GRANITE / BASALT



BIRCH



DRIFTWOOD

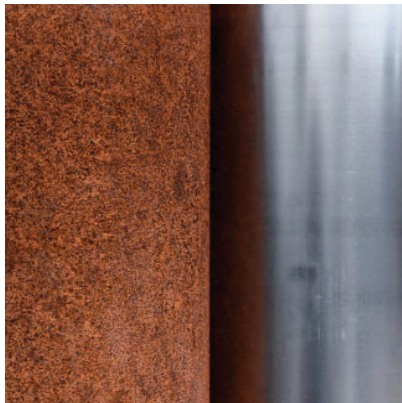

CORTEN - STAINLESS STEEL



SLAG



COLOR PALLETTE

WAABIZHESH1KANA



MARTEN TRAIL

LOGO



# Story Poles



- **Durability**  
*Steel honors the ore and steel making legacy of the area*
- **Worldview**  
*Ojibwe language and respect for the plants and animals of the Estuary*
- **River Places**  
*Panels tell stories of the people, places, and lifeways of the river*
- **Landmark**  
*Tells the story of a place through time.*

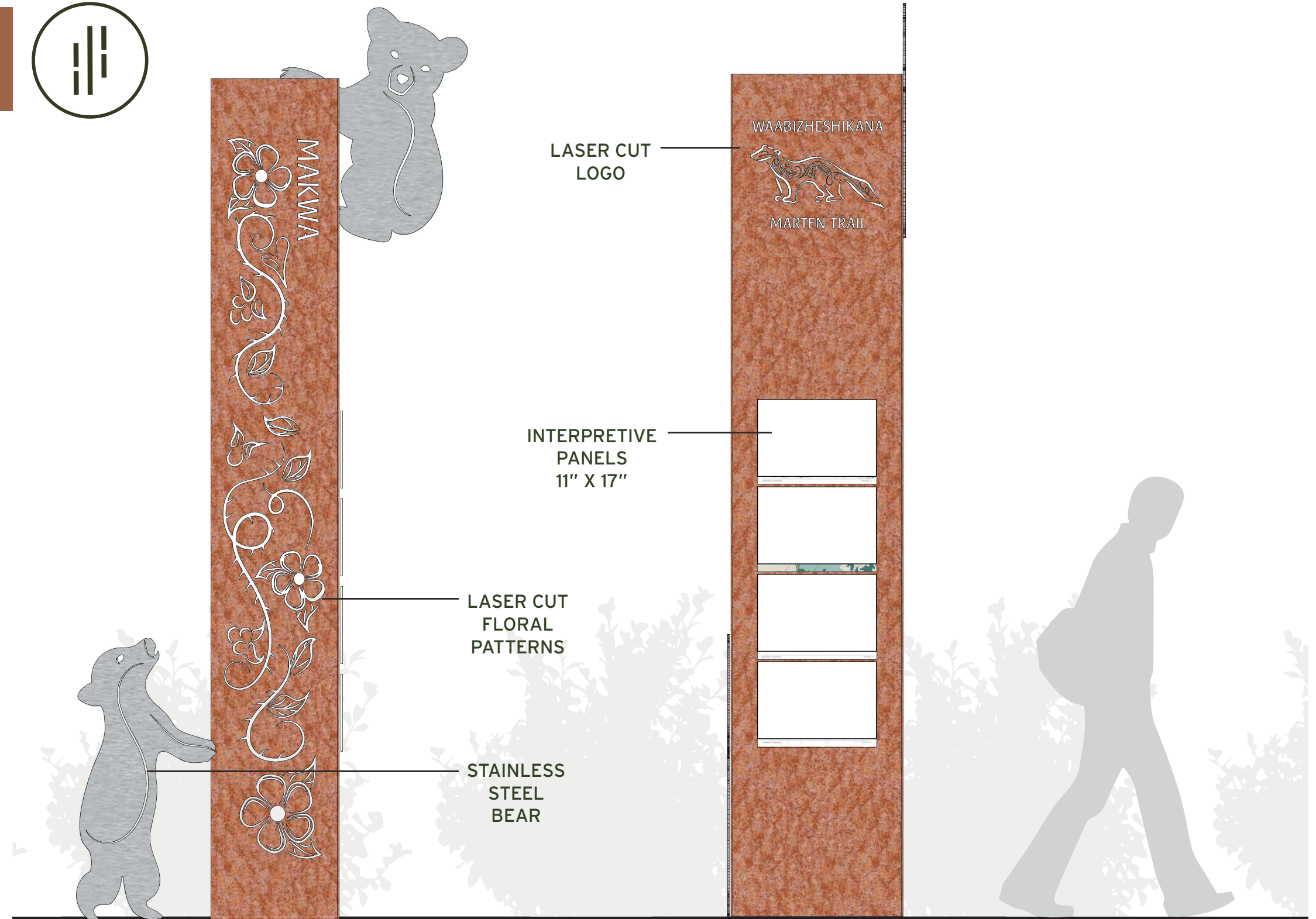



# Plant & Animal Guides





# Story Poles



|   |                               |
|---|-------------------------------|
|    | Miskwaadesi<br>PAINTED TURTLE |
|    | Amik<br>BEAVER                |
|    | Namekaa<br>STURGEON           |
|    | Migizi<br>BALD EAGLE          |
|   | Zhagashi<br>GREAT BLUE HERON  |
|  | Makwa<br>BLACK BEAR           |
|  | Wiigwaas<br>PAPER BIRCH       |
|  | Manoomin<br>WILD RICE         |
|  | Nigig<br>RIVER OTTER          |



# Story Poles





# River Place Maps

**LEGEND**



Overlook



Pause Point



Trailhead



Cairn



Story Pole



Freestanding Sign



Trail



Passage



Restoration Area



Railroad



Open Water



Wetland





# People



George Bonga, 1870, Alfred Zimmerman, Minnesota Historical Society



Stephen Bonga, 1870 -Wisconsin Historical Society



# Lifeways



Chambers' quarry at Fond du Lac, 1881. University of Minnesota Duluth, Kathryn A. Martin Library, Northeast Minnesota Historical Center Collections.



The Riverboat Chicora - 1915 - Personal Collection of Christine Carlsen



Indian Point Campground, 2020, Samuel Geer



# Freestanding Signs



INTERPRETIVE  
PANEL

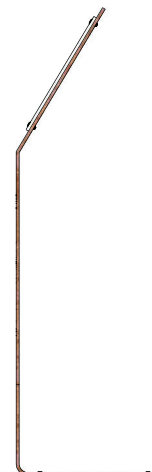



# Cairns

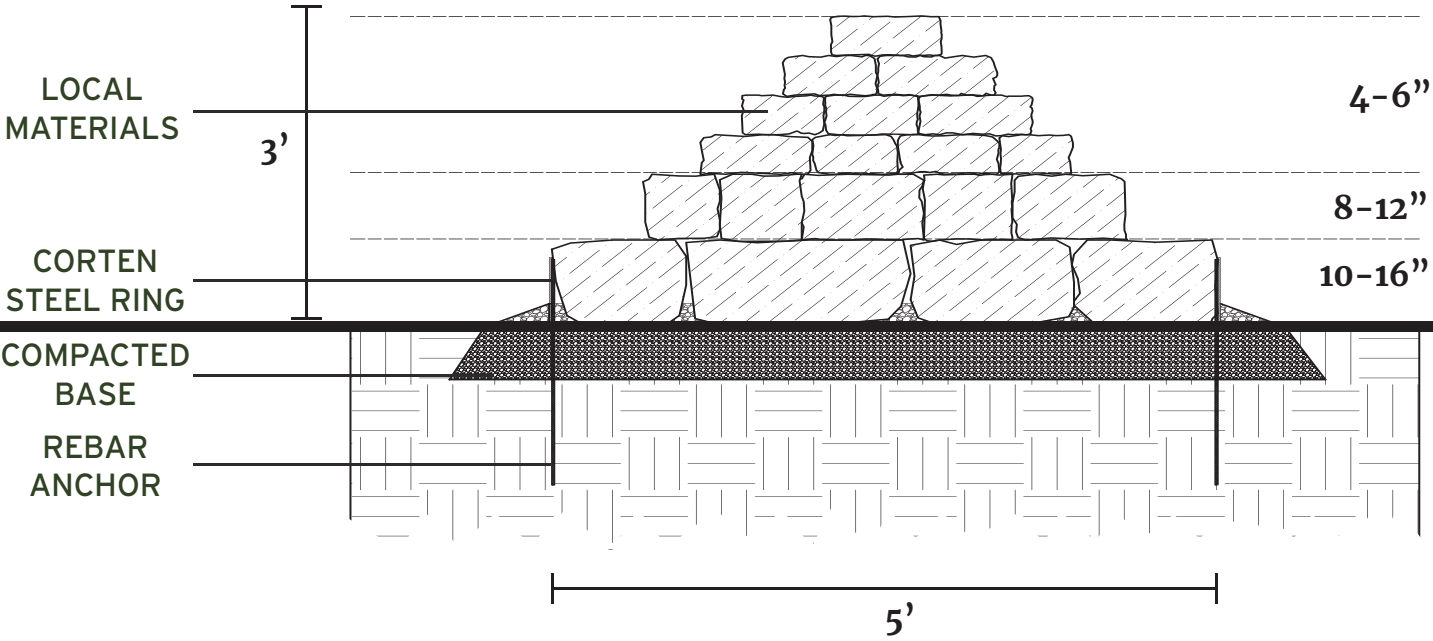
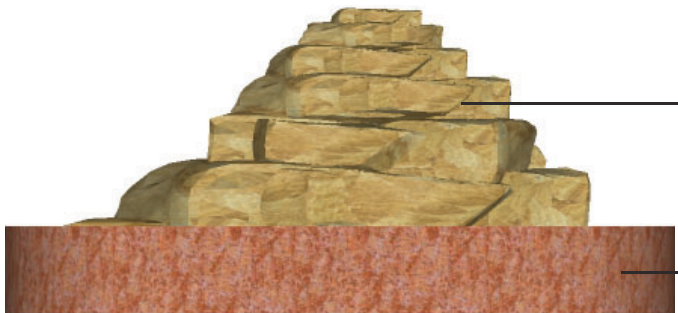



An aerial photograph of a river and surrounding wetlands, overlaid with a semi-transparent topographic map. The map features contour lines and numerical elevation values. The river flows from the upper left towards the right, with several smaller channels and islands. The surrounding land is densely forested. A small orange dot is visible on the right side of the river. The text "BRINGING THE PLAN TO LIFE" is centered over the image.

# BRINGING THE PLAN TO LIFE



# Implementation



Partnerships

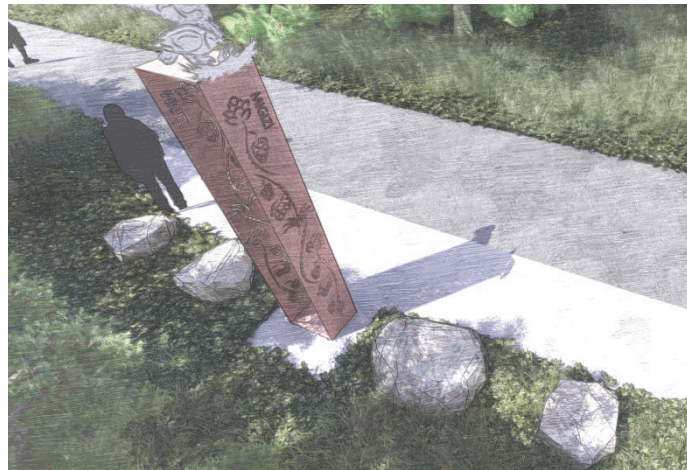

Site Design



Elements of Place

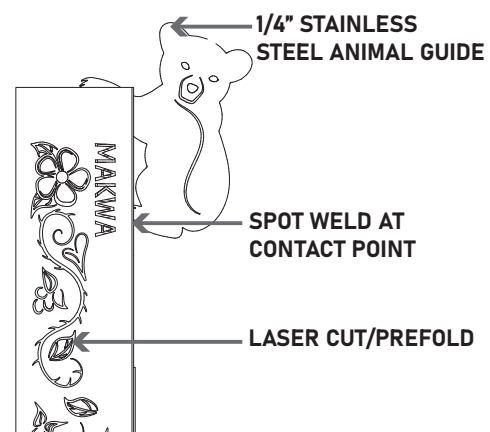

Fabrication



Artwork &  
Community

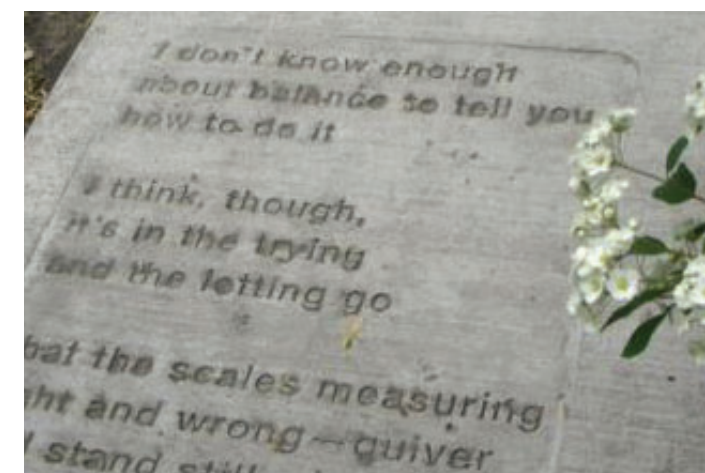

Opinion of Costs



# Draft Report for Public Review





# Public Comment + Social Pinpoint

- **Comment Period**  
*Public comment will run from 12/15 - 1/3. Please share your stories and people to recognize.*
- **Social Pinpoint**  
*Please share location specific comments on an interactive map. Follow this [link](#) to share.*

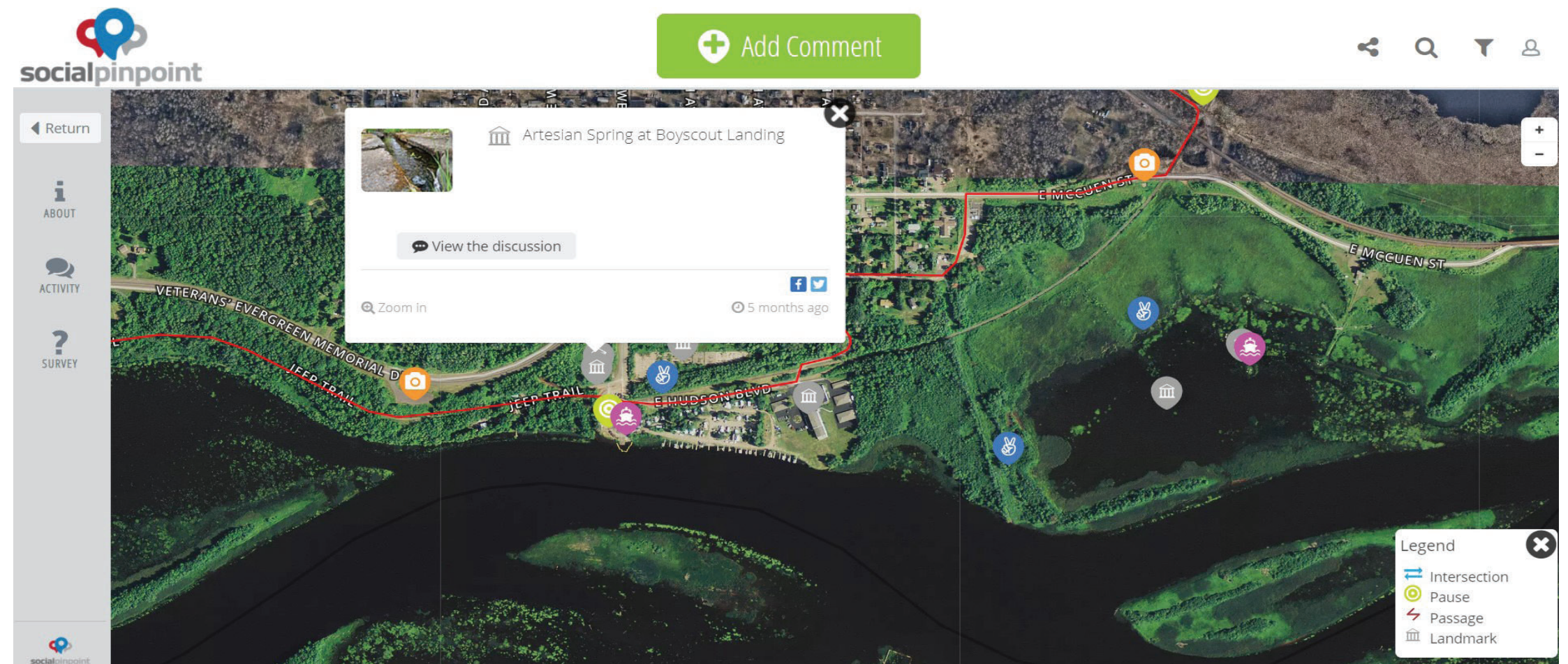



# Implementation Considerations

- **Interpretive Elements** *Implemented Concurrently with Trail Development or as planning must adapt during implementation.*
- **Funding** *Tied to other planning processes or restoration / remediation. Opportunities for fundraising and implementation partnerships*
- **Flexibility** *Opportunities along the trail to tell more stories based on community input and action.*





An aerial photograph of a river winding through a dense green forest. A semi-transparent topographic map is overlaid on the image, showing contour lines and elevation numbers. The text "MIIGWECH! / THANK YOU" is centered in the middle of the image, with "CITY PROJECT WEBSITE" below it and underlined. At the bottom of the image, there is a horizontal bar composed of several colored segments: teal, dark teal, olive green, dark brown, and light brown.

**MIIGWECH! / THANK YOU**  
**CITY PROJECT WEBSITE**